



Kingston House, Millgrove Street, Redhouse, SN25 2GF

Asking Price £127,000

- One Bedroom Second Floor Apartment
- Double Bedroom
- Gas Central Heating
- Ideal Investment or First Time Buy
- Well Appointed Kitchen/Breakfast Room
- Bathroom Suite
- All Rooms with "Open Aspect Park Views"
- Spacious Living Room
- Separate Garage, plus adjacent Parking Space
- Close to Local Amenities

Ridgeway Estate Agents are delighted to bring to the market a spacious one bedroom second floor apartment which benefits from being situated within the popular location of Redhouse, Swindon. The accommodation comprises: Separate Kitchen/Breakfast Room, Spacious Living Room, Double Bedroom and Modern Bathroom Suite. This property further benefits a Garage plus adjacent parking space. Additionally, the apartment is positioned close to local schools and amenities. No Onward Chain.

Council Tax Band- B

EPC Rating- B

Heating Type- Gas Central Heating

Leasehold

135 Years Remaining

Approx £2000.00 Service Charge Per Year (12-Month Period)

£130.00 Ground Rent Per Year (12-Month Period)





GROUND FLOOR
595 sq.ft. (55.2 sq.m.) approx.

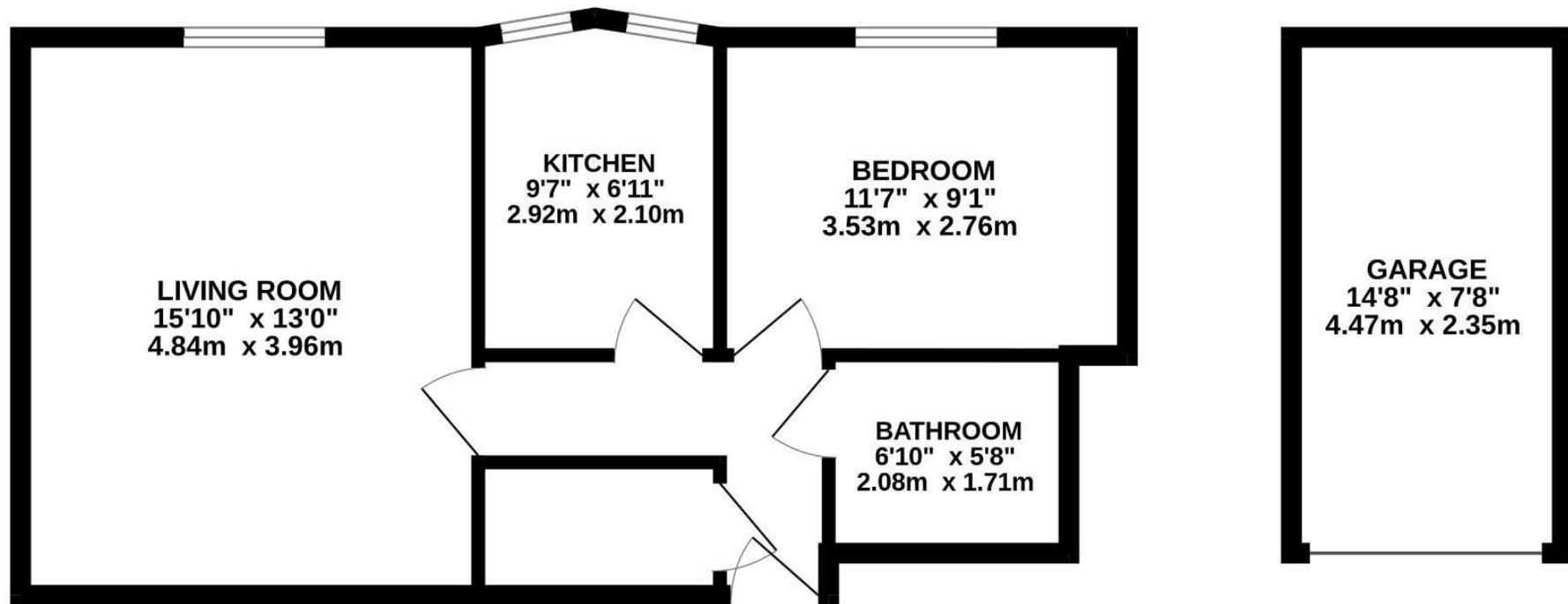

TOTAL FLOOR AREA : 595 sq.ft. (55.2 sq.m.) approx.

Whilst every attempt has been made to ensure the accuracy of the floorplan contained here, measurements of doors, windows, rooms and any other items are approximate and no responsibility is taken for any error, omission or mis-statement. This plan is for illustrative purposes only and should be used as such by any prospective purchaser. The services, systems and appliances shown have not been tested and no guarantee as to their operability or efficiency can be given.
Made with Metropix ©2024