



Conrad Close, Liden, SN3 6JG

Asking Price £249,950

- New to the Market
- Modern Kitchen/Diner with Range Master Oven
- Conservatory
- No Onward Chain
- Three Bedroom Family Home
- Three Bedrooms
- Enclosed Garden with Gated Rear Driveway
- Entrance Porch
- Bathroom Suite
- Garage

Ridgeway are delighted to offer the market a well positioned Three Bedroom Family Home that benefits from being sold with No Onward Chain and is situated within the much popular area of Liden. The accommodation comprises; Entrance Porch, Living Room, Modern Kitchen/Dining Room with Range Cooker, Three Bedrooms and Family Bathroom. This property further benefits a Large Conservatory, Enclosed Garden with Gated Rear Driveway and Garage. No Onward Chain.

Epc Rating- C

Council Tax Band- B

Heating Type- Gas Central Heating

Freehold





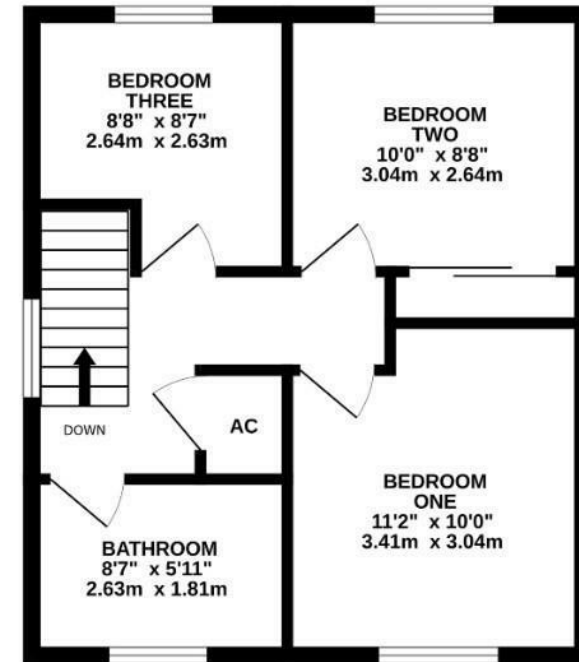
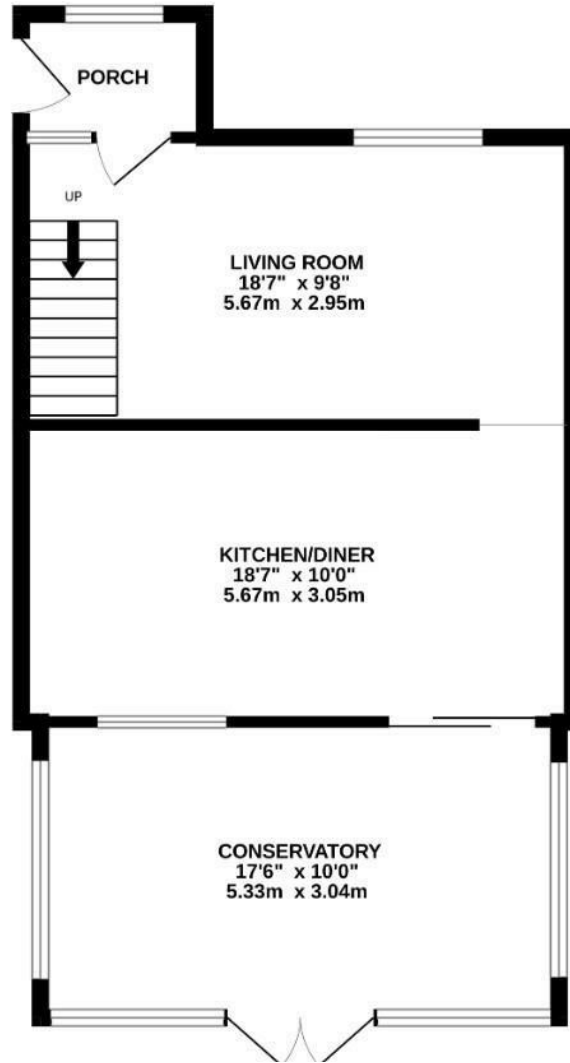

TOTAL FLOOR AREA : 1097 sq.ft. (101.9 sq.m.) approx.

Whilst every attempt has been made to ensure the accuracy of the floorplan contained here, measurements of doors, windows, rooms and any other items are approximate and no responsibility is taken for any error, omission or mis-statement. This plan is for illustrative purposes only and should be used as such by any prospective purchaser. The services, systems and appliances shown have not been tested and no guarantee as to their operability or efficiency can be given.

Made with Metropix ©2024