



## Ridge Green, Shaw, SN5 5PU

Asking Price £145,000

- New to the Market
- Fully Fitted Kitchen
- Ample Parking
- No Onward Chain
- Ground Floor Apartment
- Two Double Bedrooms
- Communal Gardens
- Spacious Living Room/Diner
- Bathroom Suite
- Ideal Investment or First Time Buy

Ridgeway are delighted to offer the market a well positioned Two Bedroom Ground Floor Apartment that benefits from being sold with No Onward Chain and is situated within the much desirable area of Shaw. This property would make an Ideal Investment or First Time Buy. The accommodation comprises of a Entrance Porch, Spacious Living Room/Diner, Fully Fitted Kitchen, Two Double Bedrooms and Bathroom Suite. Externally benefiting Ample Parking and Communal Gardens.

Council Tax Band- B  
EPC Rating- C  
Heating Type- Electric Heating  
Leasehold

959 Years Remaining  
Approx £1500.00 Service Charge Per Year (12-Month Period)  
£40.00 Ground Rent Per Year (12-Month Period)







524 sq.ft. (48.7 sq.m.) approx.

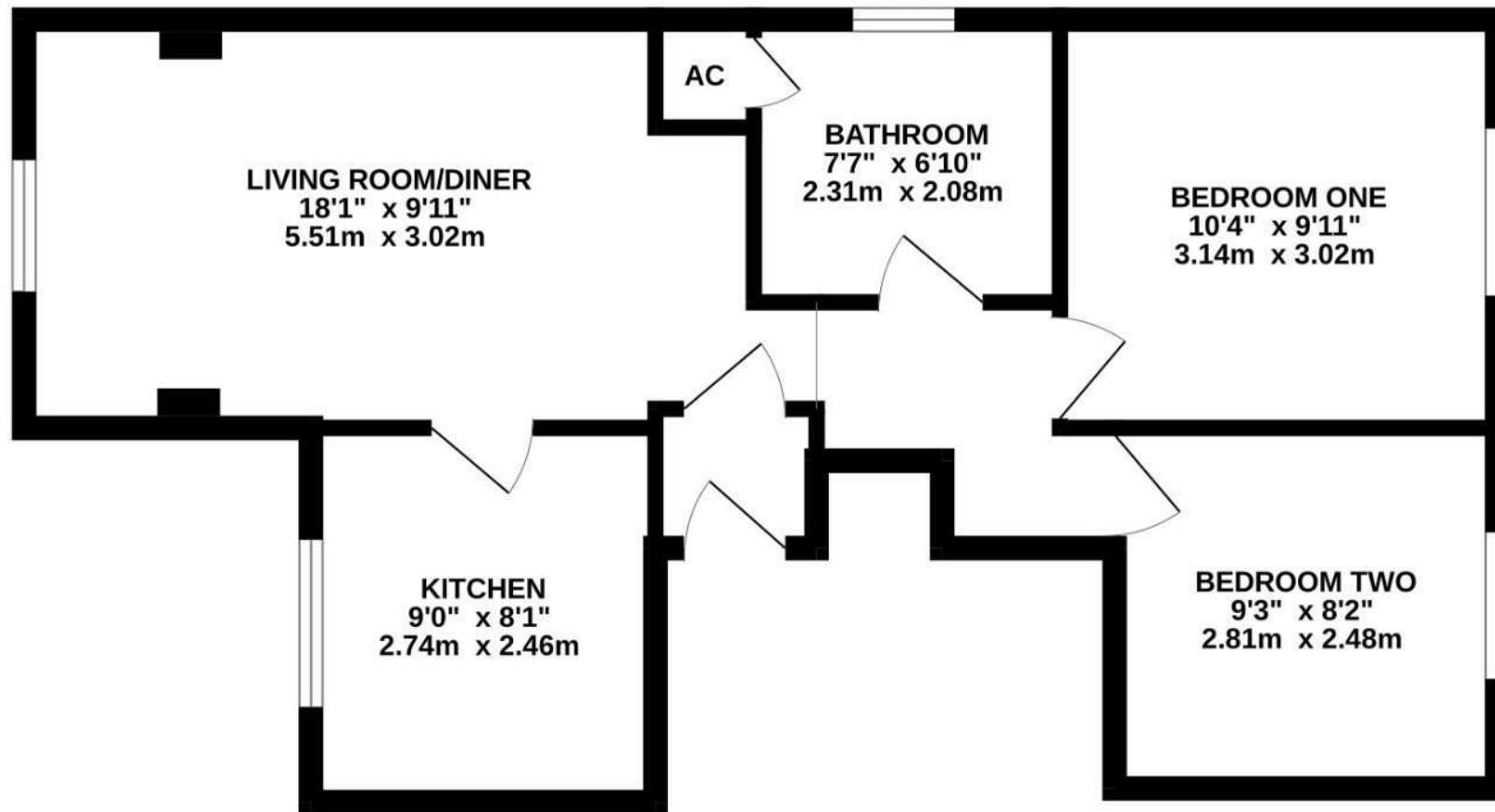

TOTAL FLOOR AREA : 524 sq.ft. (48.7 sq.m.) approx.

Whilst every attempt has been made to ensure the accuracy of the floorplan contained here, measurements of doors, windows, rooms and any other items are approximate and no responsibility is taken for any error.