

TO LET

**Thicket Road
Anerley
London, SE20**

£1,400 pcm

Refurbished 1 Bedroom Top
Floor Flat - Unfurnished





Description

Hindwoods are delighted to welcome to the market, this well presented newly refurbished one bedroom top floor flat.

Situated off the main Anerley Road, within half a mile of Anerley, Crystal Palace and Penge West Stations.

The accommodation comprises of:-

Entrance Hall

Kitchen

7'11" x 8'6" (2.40 x 2.64 m)

Range of wall and base units with stainless steel sink unit and worktop surfaces. tiled splashbacks, built in oven and hob with extractor hood over and fridge freezer. Vinyl flooring.

Lounge

14'9" x 13'9" (4.50 x 4.20m)

Sash window, freshly painted walls, new carpet, radiator.

Bedroom

9'10" x 13'5" (3.00 x 4.20m)

Sash window, freshly painted walls, new carpet and double radiator.

Bathroom

White suite comprising of a panelled bath with mixer tap and shower attachment. pedestal wash hand basin, low level W/C, part tiled walls and vinyl flooring.



Viewings

Strictly via Hindwoods.

Donna Distin

D.distin@hindwoods.co.uk



Thicket Rd,

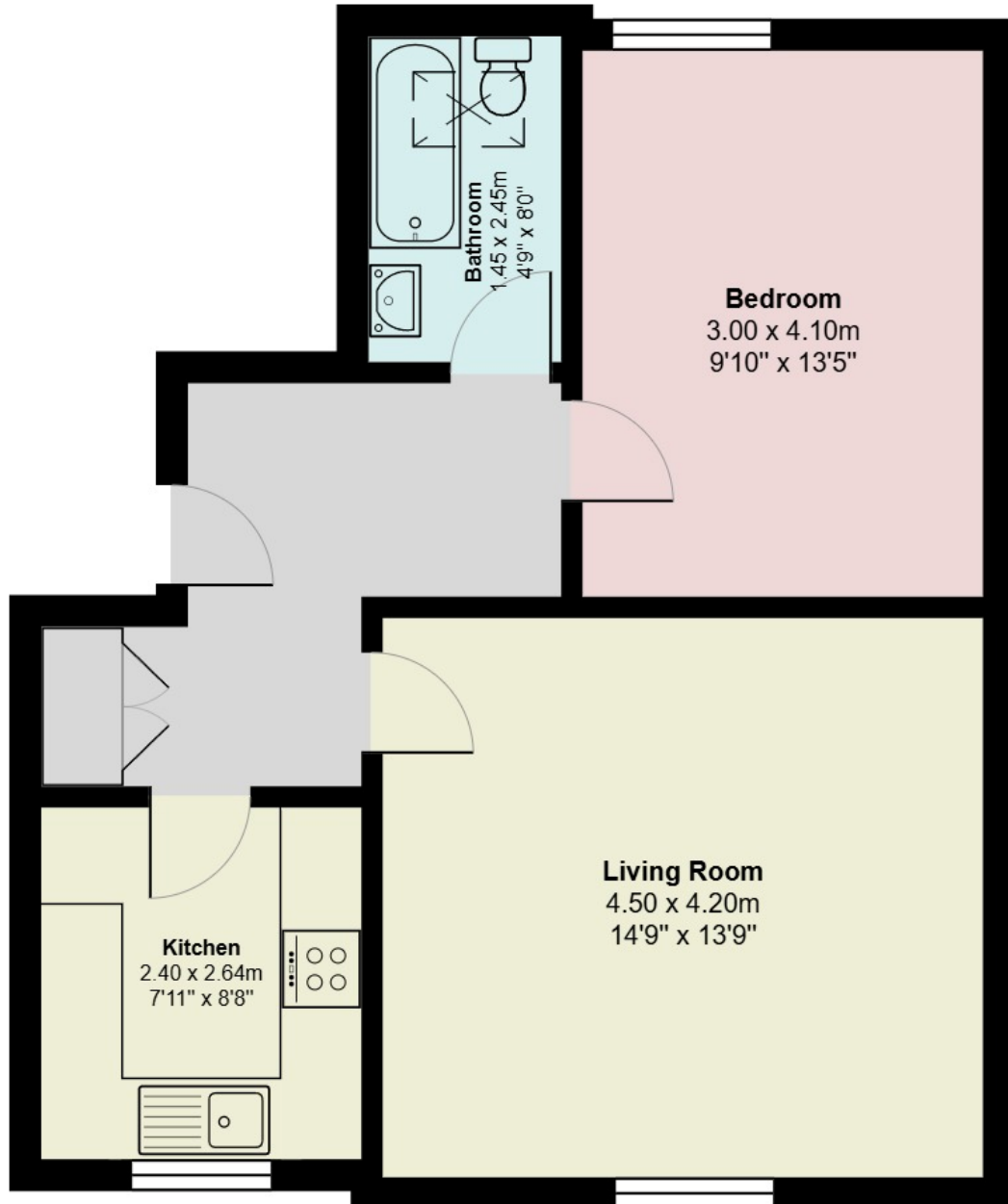

Total Area: 51.4 m² ... 554 ft²

All measurements are approximate and for display purposes only