

Aldreds
Estate Agents



2 Stanbrook Bungalows The Street, Sea Palling, NR12 0UD

£180,000



3



1



1



G



£180,000

2 Stanbrook Bungalows The Street

Sea Palling, NR12 0UD

- Semi Detached Bungalow
- Three Bedrooms
- Sought After Coastal Village
- Driveway Parking
- Ideal Permanent Residence Or Holiday Home/Let
- Of Non Standard Construction
- Tucked Away Position
- Lovely Enclosed Gardens
- Lots of Potential to Improve
- Offered With No Onward Chain

Aldreds are pleased to offer this three bedroom semi detached bungalow of a non standard construction, situated in a pleasant tucked position in the centre of the Coastal village of Sea Palling. Ideally suited for those looking for either a permanent residence or a holiday home/let, this deceptively spacious property offers lots of potential with accommodation including an open plan lounge/diner with woodburning stove, kitchen, inner hall, three bedrooms and bathroom. Offering driveway parking for two cars and nicely enclosed gardens, this property is offered with no onward chain.



Lounge/Diner 18'0" x 15'8" at max (5.5m x 4.79m at max)

Open plan lounge/diner of irregular shape with part-glazed sliding entrance doors, power points, corner fireplace with woodburning stove and doors leading off;

Walk-In Store 6'5" x 3'11" (1.96m x 1.2m)

With fitted shelving and lighting, former front door (currently blocked).

Kitchen 12'5" x 7'8" (3.79m x 2.36m)

A range of fitted units with rolled edge work surface, sink drainer, power points, electric cooker point, wall mounted electric hot water heater, door giving access to;

Lean-To 13'1" x 6'11" (4m x 2.13m)

With door to rear garden.

Inner Hall

With airing cupboard, doors leading off;

Bedroom 1 9'11" x 10'4" at max (3.04m x 3.15m at max)

Window to rear aspect, power points, television point.





Bedroom 2 9'6" x 7'3" (2.9m x 2.23m)

Window to side aspect, power points.

Bedroom 3 9'6" x 5'5" (2.9m x 1.67m)

Window to side aspect, power points.

Bathroom

Rear facing obscure glazed window, panelled bath, low level WC, pedestal hand wash basin, tiled walls.

Outside

The property is approached by vehicular access via a driveway providing parking spaces for two vehicles with gate giving access to an attractive pathway access to the side of the property. The property offers garden areas to side and front with a garden building incorporating a covered area with external power supply. The front garden is nicely enclosed with a laid to lawn area and a brick built barbecue with 'rocket stove'.

Tenure

Freehold.

Services

Mains water, electric and drainage.

Directions

From Aldreds Stalham proceed along St Johns Road turning right onto Brumstead Road. At the 'T' junction turn left onto Ingham Road and follow this road through Ingham passing The Swan Public House on the right hand side, proceed towards Sea Palling bearing round to the right hand bend, turn right at the junction, proceed into the village of Sea Palling as the road turns to the left into The Street, the property can be located on the right hand side, st right back from the road and located by our 'For Sale' board.



Council Tax

North Norfolk District Council - Band 'A'

Location

Sea Palling is a popular coastal village with a beautiful sandy beach. The village offers a Post Office/store, Village Hall, Free House/Restaurant, Caravan Parks and seasonal shops. The Broadland town of Stalham lies just five miles away, with a full range of amenities including food outlets, a Tesco supermarket and doctors, schools and a library.

Reference

PJL/S9898



Floor Plans

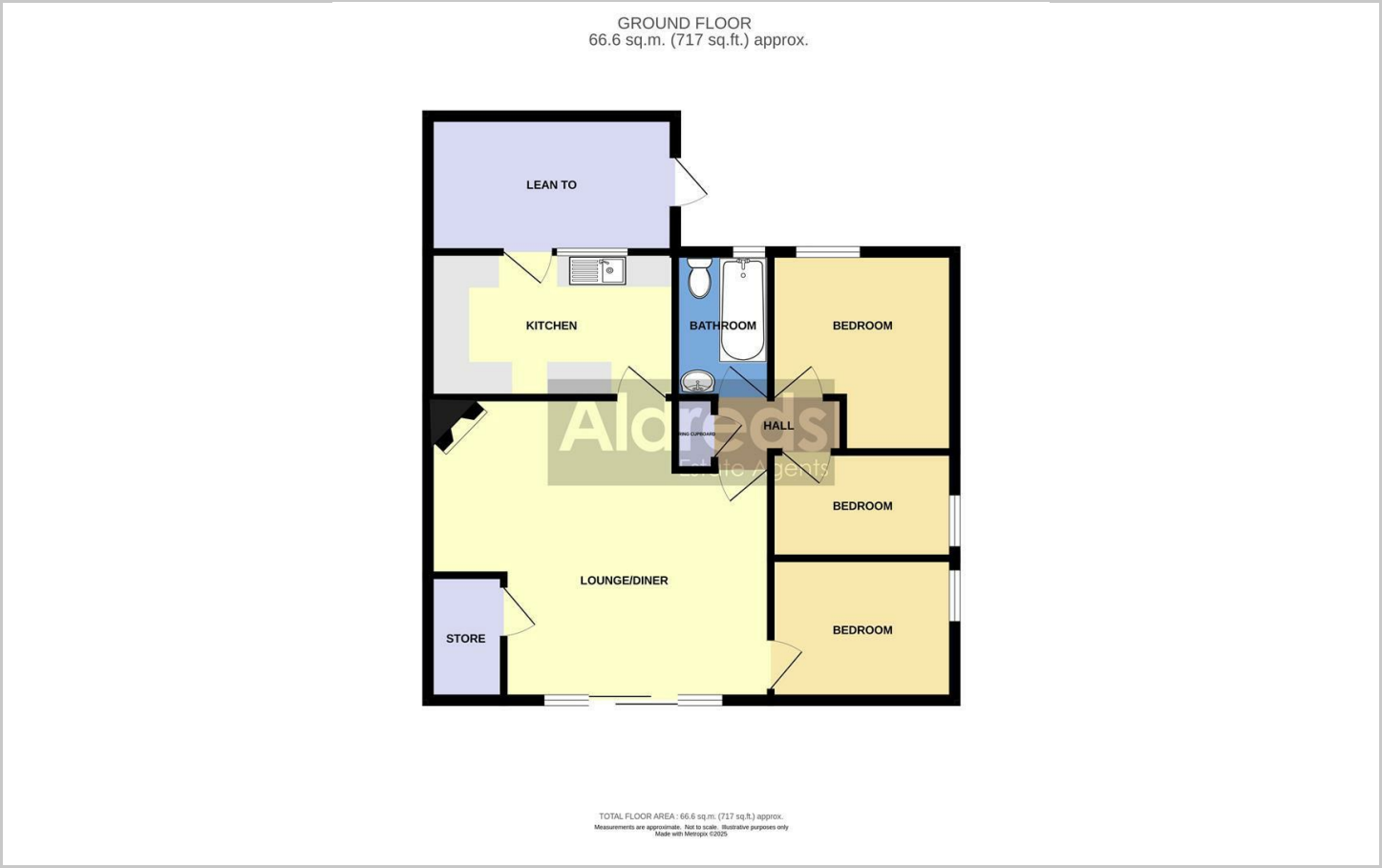

Location Map



Energy Performance Graph

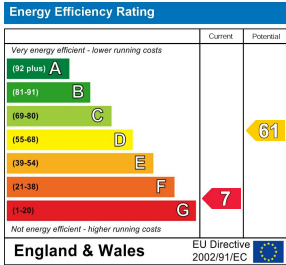

Viewing

Please contact our Aldreds Stalham Office on 01692 581089 if you wish to arrange a viewing appointment for this property or require further information.

Disclaimer
These particulars are issued on an understanding that all negotiations shall be conducted through Messrs. Aldreds. Please note: Messrs. Aldreds for themselves and for the vendors or lessors of this property whose agents they are given notice that: 1. Particulars are set out as a general outline only for guidance of intending purchasers or lessees, and do not constitute nor constitute part of, an offer or contract. 2. All descriptions, dimensions, references to condition and necessary permissions for use and occupation, and other details are given without responsibility and any intending purchasers or tenants should not rely on them as statements or representations of fact but must satisfy themselves by inspection or otherwise as to the correctness of each of them. 3. No person in the employment of Messrs. Aldreds has any authority to make or give any representation or warranty whatever in relation to this property. 4. If you are proposing to visit the property and are travelling some distance please check with Aldreds on the issue of availability prior to travelling. 5. Aldreds Property Consultants and associated services may offer additional services to the prospective purchaser for which they will be entitled to receive a commission. Aldreds are pleased to be working with Mortgage Advice Bureau. They're an award-winning mortgage broker with over 1,400 advisers across the UK, and have access to over 12,000 mortgage products from over 90 lenders. Aldreds Estate Agents Ltd receive a commission of £200 on each completed case. Your home may be repossessed if you do not keep up repayments on your mortgage. There may be a fee for mortgage advice. The actual amount you pay will depend upon your circumstances. The fee is up to 1%, but a typical fee is 0.3% of the amount borrowed. Mortgage Advice Bureau is a trading name of Mortgage Seeker Limited which is an appointed representative of Mortgage Advice Bureau Limited and Mortgage Advice Bureau (Derby) Limited which are authorised and regulated by the Financial Conduct Authority. Mortgage Seeker Limited Registered Office: Lovewell Blake, Sixty Six North Quay, Great Yarmouth, Norfolk, NR30 1HE. Registered in England Number: 03721415. 6. Potential purchasers should check with their providers that the broadband and mobile phone coverage they would require is available.