

Aldreds
Estate Agents



5 New Zealand Way Mill Lane

Bacton, NR12 0HW

£108,000



5 New Zealand Way Mill Lane

Bacton, NR12 0HW

Aldreds are pleased to offer this detached bungalow of non standard construction situated in the popular coastal village of Bacton. This well presented property offers accommodation including an open plan living/dining/kitchen area, inner hall, two bedrooms and bathroom. The property offers electric storage heating, a nicely enclosed rear garden, allocated parking space and is located just a short distance away from the beach. This would make an ideal property for those looking for a seaside bolt hole or a holiday letting opportunity. Early internal viewing is highly recommended,

Open Plan Living/Dining/Kitchen Area

20'1" x 11'9" reducing to 9'6" (6.14m x 3.6m reducing to 2.9m)

A spacious open plan living space with windows to front and either side aspects, kitchen area with a range of fitted kitchen units with rolled edge work surface, plumbing for washing machine, sink drainer, power points, cooker point, built-in cupboard, wall mounted electric storage heater, door giving access to;

Inner Hall

Loft access, doors leading off;

Bedroom 1

9'11" x 8'10" (3.04m x 2.7m)

Window to side aspect, power points.

Bedroom 2

11'9" x 6'6" (3.6m x 2m)

Window to side aspect, power points.

Bathroom

Obscure glazed window to side aspect, low level w.c., hand wash basin, panelled bath with shower attachment over, wall mounted electric heater.





Outside

Allocated parking space with visitor parking available, lawned front garden and a nicely enclosed rear garden, mainly shingled with a timber garden shed.

Agents Note

The property offers all year round holiday use. The current owner resides in the property full time and pays full annual council tax ('A' band)

Tenure

Freehold.

Services

Mains water, electric and drainage.

Council Tax

North Norfolk District Council - Band: A.

Energy Performance Certificate (EPC)

EPC Rating: F.

Location

Bacton is a nice coastal village with a lovely sandy beach, popular with visitors all year round. There is a small selection of shops, fish and chip shop, junior school and a public house. Bacton is approximately seven miles from Stalham which offers a variety of shops and good amenities including a supermarket, health centre, library and a range of schools.

Reference

S9785/PJL



Floor Plan

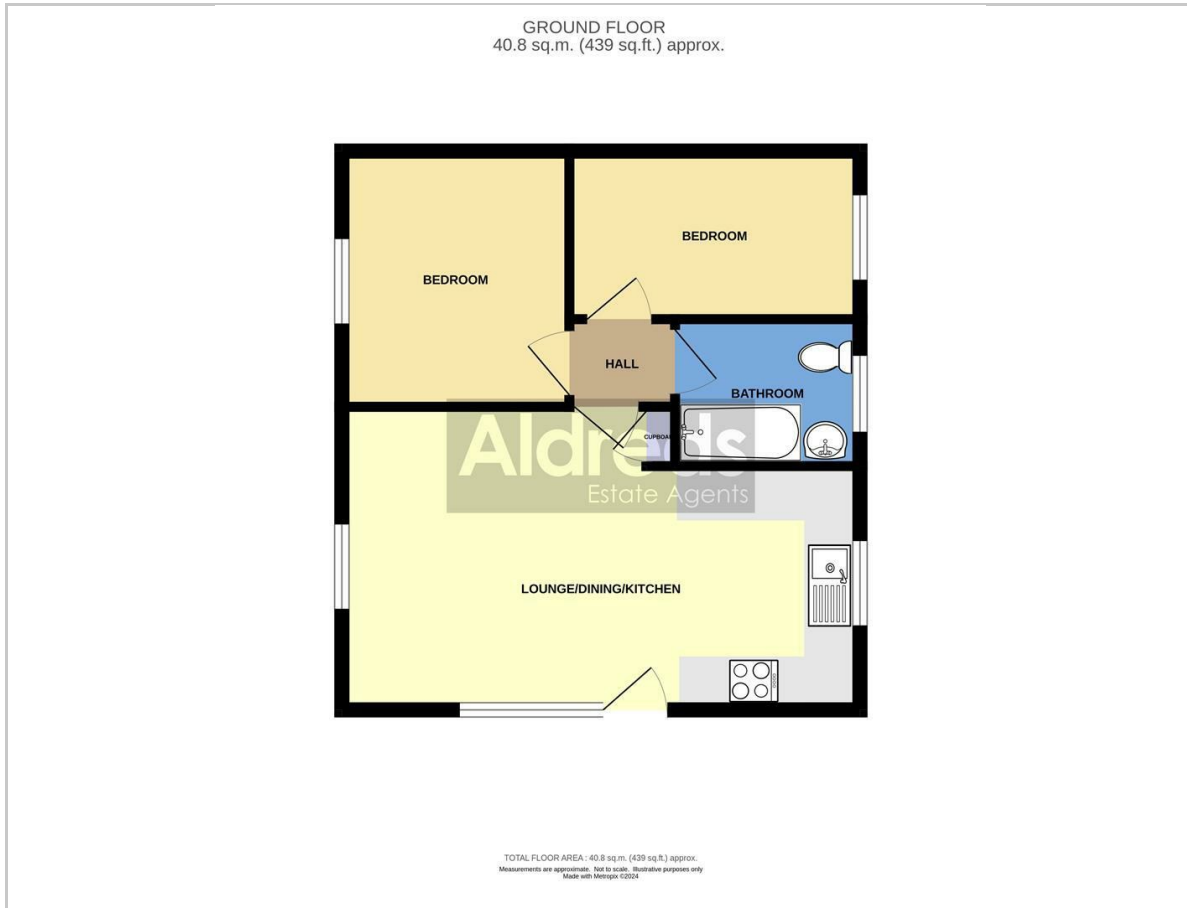

Viewing

Please contact our Aldreds Stalham Office on 01692 581089 if you wish to arrange a viewing appointment for this property or require further information.

Disclaimer

These particulars are issued on an understanding that all negotiations shall be conducted through Messrs. Aldreds. Please note: Messrs. Aldreds for themselves and for the vendors or lessors of this property whose agents they are given notice that: 1. Particulars are set out as a general outline only for guidance of intending purchasers or lessees, and do not constitute nor constitute part of, an offer or contract. 2. All descriptions, dimensions, references to condition and necessary permissions for use and occupation, and other details are given without responsibility and any intending purchasers or tenants should not rely on them as statements or representations of fact but must satisfy themselves by inspection or otherwise as to the correctness of each of them. 3. No person in the employment of Messrs. Aldreds has any authority to make or give any representation or warranty whatever in relation to this property. 4. If you are proposing to visit the property and are travelling some distance please check with Aldreds on the issue of availability prior to travelling. 5. Aldreds Property Consultants and associated services may offer additional services to the prospective purchaser for which they will be entitled to receive a commission.

Aldreds are pleased to be working with Mortgage Advice Bureau. They're an award-winning mortgage broker with over 1,400 advisers across the UK, and have access to over 12,000 mortgage products from over 90 lenders. Aldreds Estate Agents Ltd receive a commission of £200 on each completed case. Your home may be repossessed if you do not keep up repayments on your mortgage. There may be a fee for mortgage advice. The actual amount you pay will depend upon your circumstances. The fee is up to 1%, but a typical fee is 0.3% of the amount borrowed. Mortgage Advice Bureau is a trading name of Mortgage Seeker Limited which is an appointed representative of Mortgage Advice Bureau Limited and Mortgage Advice Bureau (Derby) Limited which are authorised and regulated by the Financial Conduct Authority. Mortgage Seeker Limited Registered Office: Lovewell Blake, Sixty Six North Quay, Great Yarmouth, Norfolk, NR30 1HE. Registered in England Number: 03721415. 6. Potential purchasers should check with their providers that the broadband and mobile phone coverage they would require is available.

Area Map



Energy Efficiency Graph

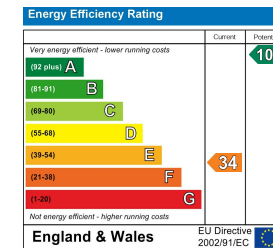

55 High Street, Stalham, Norfolk, NR12 9AH
Tel: 01692 581089 Email: stalham@aldreds.co.uk <https://www.aldreds.co.uk/>

Registered in England Reg. No. 08945751 Registered Office: 66 North Quay, Great Yarmouth, Norfolk NR30 1HE Directors: Mark Duffield B.S.c. FRICS. Dan Crawley MNAEA Paul Lambert MNAEA