



Somerton Drive

Marston Green, Birmingham, B37 7XH

- 4 Bedrooms one with Ensuite
- Large Kitchen Diner
- Large Lounge
- Family Bathroom

Guide Price £450,000

EPC Rating 'TBC'



Somerton Drive, Marston Green, Birmingham, B37 7XH



Property Description

Nestled in the charming area of Marston Green, Somerton Drive presents a delightful 4-bedroom Family home offering modern comforts and a versatile layout. This property is conveniently located, with easy access to local amenities, schools, and transport links.

Ground Floor

Upon entering through the uPVC double glazed entrance door, the hallway leads to the spacious lounge.

Lounge

(6.17m x 3.34m/ 20'3" x 10'11")

Step into the spacious lounge featuring a large uPVC double glazed window to the front, filling the room with natural light. This welcoming space offers ample room for relaxation and entertaining, with two radiators ensuring comfort throughout the year. French doors open to the rear garden, extending the living area during warmer months.





Kitchen/Diner

(6.17m x 3.41m/ 20'3" x 11'2")

The modern kitchen/diner is a focal point of the home, equipped with a range of base and eye-level units, including integrated appliances and a composite sink with a stainless-steel mixer tap. Dual aspect windows to the front and rear flood the room with light, creating a bright and inviting atmosphere. This spacious area accommodates dining furniture and a lounge area perfect for family meals and gatherings.

Utility Room

(1.94m x 1.62m/ 6'4" x 5'4")

Adjacent to the kitchen, the utility room offers additional storage and plumbing for laundry appliances, enhancing practicality and organization within the home.



WC

Situated off the entrance hall this convenient Downstairs WC comprises of a low-level WC and corner wash basin.

Landing

The landing serves as a central hub connecting the first-floor bedrooms and bathroom. A uPVC double glazed window to the front invites natural light into the space, enhancing its brightness and openness. This area features a convenient storage cupboard, offering practical storage solutions for linens, towels, or household items. Radiator heating ensures comfort throughout the landing, making it a functional and welcoming space within the home.



Master Bedroom

(3.64m x 3.34m/ 11'11" x 10'11")

The master bedroom features a uPVC double glazed window overlooking the rear garden, providing a peaceful retreat. It includes convenient triple wardrobes with sliding doors with a door leading to the en-suite bathroom, offering privacy and comfort.

En-suite Bathroom

The en-suite is fitted with a three-piece suite comprising a pedestal wash hand basin, tiled shower enclosure with a fitted shower, and a low-level WC. Tiled splashbacks and a uPVC double glazed window ensure functionality and aesthetics.



Bedroom 2

(3.50m x 2.96m / 11'6" x 9'9")

Ideal double bedroom with plenty of space for family members, this bedroom includes a uPVC double glazed window to the front, providing natural light and views of the surroundings. A radiator maintains warmth and comfort.



Bedroom 3

(2.93m x 2.44m / 9'7" x 8')

This versatile Double room boasts natural light from the uPVC double glazed window which overlooks the rear garden, enhancing the ambiance of the space.

Bedroom 4

(2.31m x 2.25m / 7'7" x 7'5")

The fourth bedroom features a uPVC double glazed window to the front, radiator, and sufficient space for a single bed or study area, making it an ideal children's room or home office.



Family Bathroom

The family bathroom is fitted with a contemporary three-piece suite comprising a deep panelled bath, pedestal wash hand basin, and low-level WC. Tiled splashbacks, a uPVC double glazed window, and a radiator completes this functional and stylish space.

Outdoor Space:

Outside, the property features a driveway leading to the garage, providing ample parking space. The enclosed rear garden is a delightful outdoor space featuring a variety of plants and shrubs, offering both beauty and privacy. Two paved patio areas provide ideal settings for outdoor dining, entertaining, or simply enjoying the sunshine. The well-maintained lawn offers ample space for children to play or for hosting outdoor family gatherings. This inviting garden is perfect for relaxation and enjoying the outdoors in a private setting.

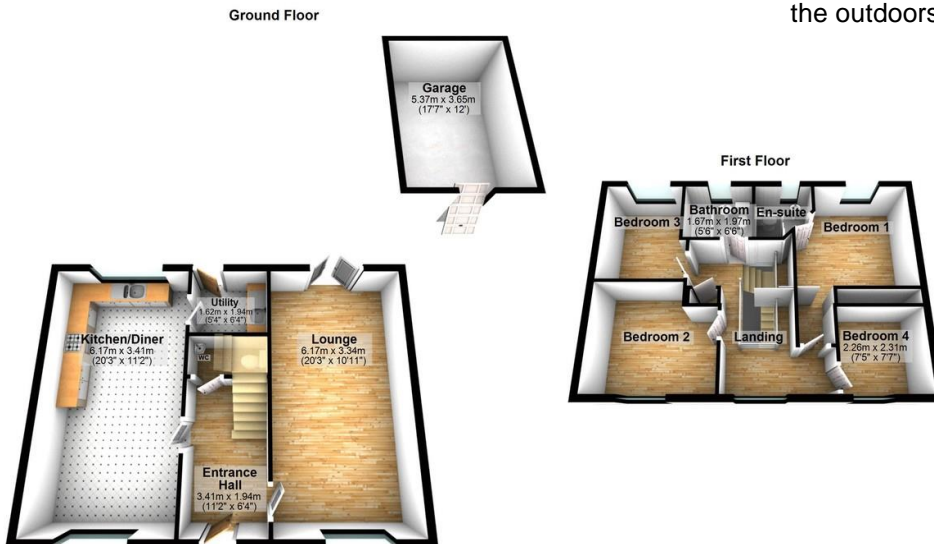

66 Station Road
Marston Green
Birmingham
West Midlands
B37 7BA

www.blackandwhitelettings.co.uk
info@blackandwhiteestateagents.com
0121 770 8811

Agents Note: Whilst every care has been taken to prepare these sales particulars, they are for guidance purposes only. All measurements are approximate and for general guidance purposes only and whilst every care has been taken to ensure their accuracy, they should not be relied upon and potential buyers are advised to recheck the measurements