



Black and White
CLEARLY A BETTER SERVICE

CHESTER ROAD, CASTLE BROMWICH, BIRMINGHAM, B36
0JE ASKING PRICE OF £135,000





Chester road

- 2 Bedrooms

This 2 bedroom Maisonette is new to the market and has been renovated throughout. Located above Jacks supermarket and in a fantastic spot close to everything you could want; large supermarkets, restaurants, transport links. Generously sized bedrooms with plenty of storage and private front garden.

First Floor

Front of house

Patio area, front gate

Hall

Brand new front door, window to front, carpeted stairs, laminate wood effect flooring, doors to:

Kitchen 4.29m (14'1") x 2.75m (9')

Window to front, matching base and eye level cabinets, built in cooker, electric hob, extractor fan, laminate wood effect flooring, coving to ceiling.



Living Room 4.76m (15'7") x 3.76m (12'4")
Large window to rear, laminate wood effect flooring,
coving to ceiling.

Second Floor

Landing

Fitted carpet, coving to ceiling, doors to:

Bedroom 1 4.76m (15'7") x 2.78m (9'2")
Large window to rear, double doors to built in
wardrobe, fitted carpet, coving to ceiling.

Bedroom 2 3.90m (12'9") x 2.66m (8'9")
Window to front, double doors to built in wardrobe,
fitted carpet, coving to ceiling, door to:

Bathroom

Window to front, coving to ceiling, bath/shower, wash
basin, toilet, door to storage/water tank.



Ground Floor

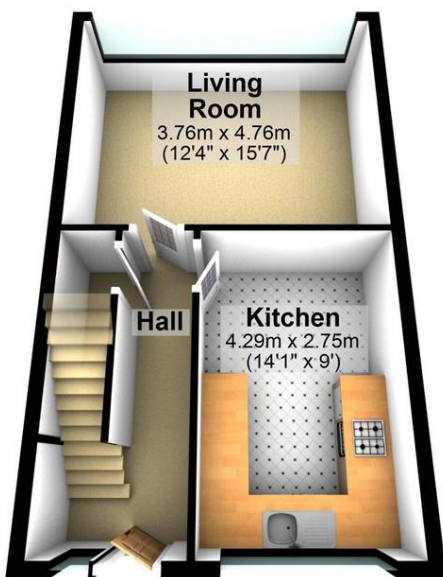

First Floor

