

ANTHONY JAMES MANSEY

Residential Sales & Lettings



Braddock Close

Isleworth, TW7 6SQ

£1,450 Per Month



Situated on the popular Maltings Development, opposite St Johns Gardens and on the H37 Hopper bus route to St Margarets and Richmond. A ground floor purpose built apartment within reach of Isleworth Station serving Waterloo. The accommodation comprises entrance hallway, spacious reception room, double bedroom, kitchen and bathroom. The property is fitted with gas central heating. There is a private car parking space.



Area Map



Floor Plans

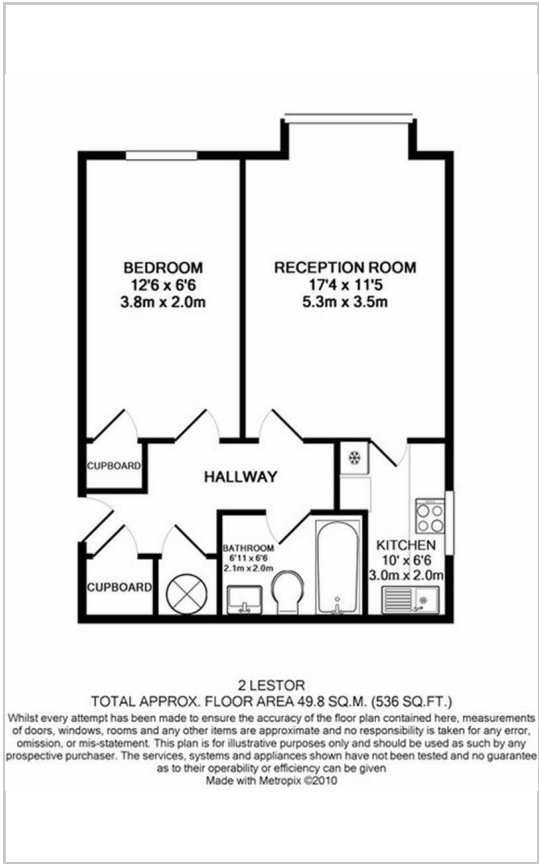

Energy Efficiency Graph

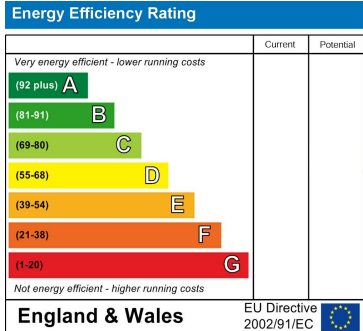

These particulars, whilst believed to be accurate are set out as a general outline only for guidance and do not constitute any part of an offer or contract. Intending purchasers should not rely on them as statements of representation of fact, but must satisfy themselves by inspection or otherwise as to their accuracy. No person in this firms employment has the authority to make or give any representation or warranty in respect of the property.