

ANTHONY JAMES MANSEY

Residential Sales & Lettings



Harvesters Close

Isleworth, TW7 7PS

£430,000

Freehold

Council Tax Band D

Harvesters Close is within easy distance of Whitton High Street with its excellent range of shops and cafes. Hounslow railway station services Waterloo. Bus routes into local towns can be found in Hall Road. This property is ideal for the purchaser who wants to create their dream home. Requiring updating throughout you can choose your own decoration, floor coverings, kitchen and bathroom. The accommodation comprises entrance hallway, kitchen and lounge dining room. The first floor comprises two bedrooms and bathroom. There is a private rear garden together with off street parking. This home is available chain free - keys are available for accompanied viewings.

Viewing

Please contact our Sales Office on 020 8847 0488 if you wish to arrange a viewing appointment for this property or require further information.

- Modern Built Terraced Home
- Lounge/Dining Room
- Two Bedrooms
- Private Rear Garden
- Chain Free Possession
- Cul De Sac Location
- Off Street Parking
- Requiring Modernisation Throughout
- Within Easy Reach of Whitton High Street
- Hounslow Central Station Serving Waterloo



Floor Plan

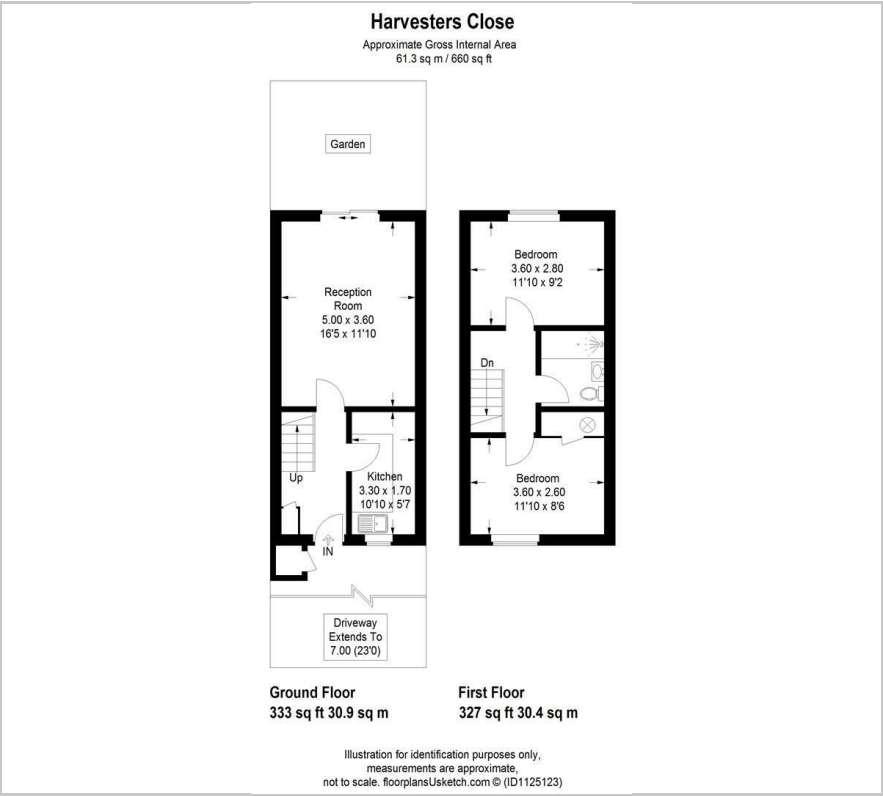

Area Map



Energy Efficiency Graph

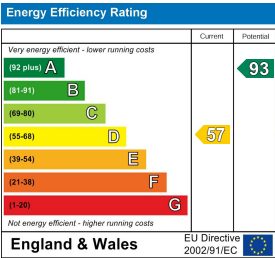

These particulars, whilst believed to be accurate are set out as a general outline only for guidance and do not constitute any part of an offer or contract. Intending purchasers should not rely on them as statements of representation of fact, but must satisfy themselves by inspection or otherwise as to their accuracy. No person in this firms employment has the authority to make or give any representation or warranty in respect of the property.