

ANTHONY JAMES MANSER

Residential Sales & Lettings



14 Percheron Close

Isleworth, TW7 6SS

£625,000

Anthony James Manser are pleased to present this rare modern end of terrace family home to the market. Situated in a very quiet cul de sac within close walking distance of many transport links including Isleworth mainline service to Waterloo and various bus routes including the H37 Hopper bus to Richmond. This home provides on the ground floor of a modern kitchen, large open plan reception room with patio doors opening onto the garden and a W.C. The first floor provides three bedrooms and bathroom. Externally there is off street parking and a garage to the side of the property. There is ample opportunity to extend the home subject to the normal permissions. Please contact the owners sole agents to view.

Viewing

Please contact our Sales Office on 020 8847 0488 if you wish to arrange a viewing appointment for this property or require further information.

- A Modern End of Terrace House with Own Drive & Garage
- Large Plot
- Three Bedrooms
- Large Open Plan Living Room into Garden
- Modern Kitchen & Bathroom
- Ground Floor WC
- Double Glazed Windows & Gas Central Heating
- Excellent Potential to Extend Subject to Permissions
- Isleworth Station Serving Waterloo
- Isleworth Affords a Large Variety of Local Shops & Cafes



Floor Plan

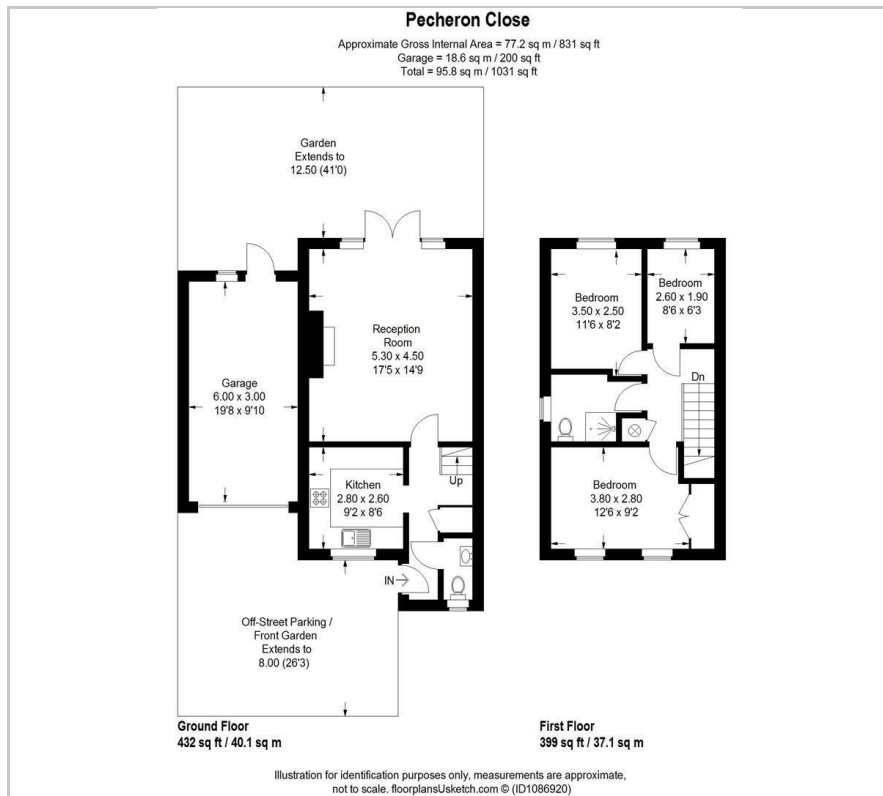

Area Map

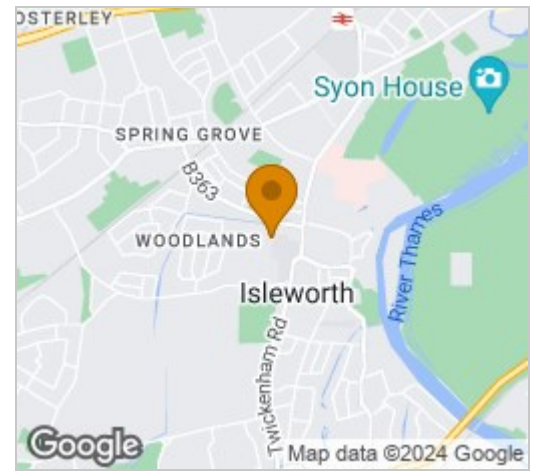

Energy Efficiency Graph

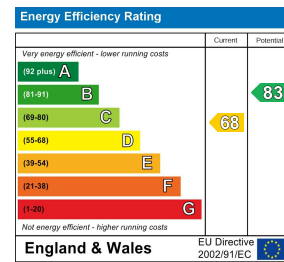

These particulars, whilst believed to be accurate are set out as a general outline only for guidance and do not constitute any part of an offer or contract. Intending purchasers should not rely on them as statements of representation of fact, but must satisfy themselves by inspection or otherwise as to their accuracy. No person in this firm's employment has the authority to make or give any representation or warranty in respect of the property.

Isleworth 22 St Johns Road, TW7 6NW

Tel: 020 8847 0488 Email: sales@anthonyjamesmanser.co.uk <https://www.anthonyjamesmanser.co.uk/>