

ANTHONY JAMES MANSEY

Residential Sales & Lettings



1 Sorrel House

Taylor Close, HOUNSLOW, TW3 4BZ

£1,250 Per Calendar Month



A beautifully presented modern one bedroom ground floor apartment set in a popular location close to local amenities, Hounslow Town Centre and the delights of Osterley Park (National Trust). This light and airy property comprises a spacious living/dining area with attractive bay window, modern fitted kitchen, double bedroom and contemporary bathroom. Benefits include ample storage, triple glazing, and delightful well-maintained communal gardens. With easy access to the A4 leading to London, Heathrow and the motorway network, the nearest stations are Osterley and Hounslow East Tube (Piccadilly Line to Central London and Heathrow).



Area Map

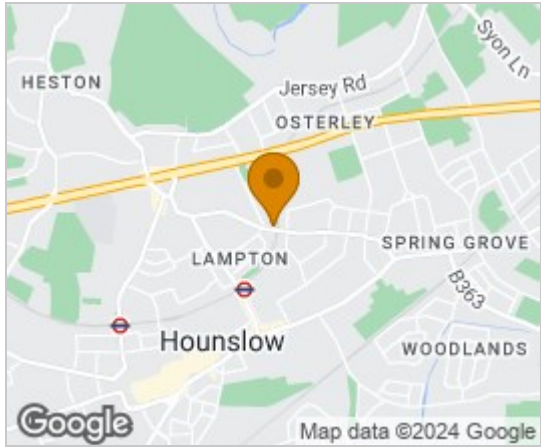

Floor Plans

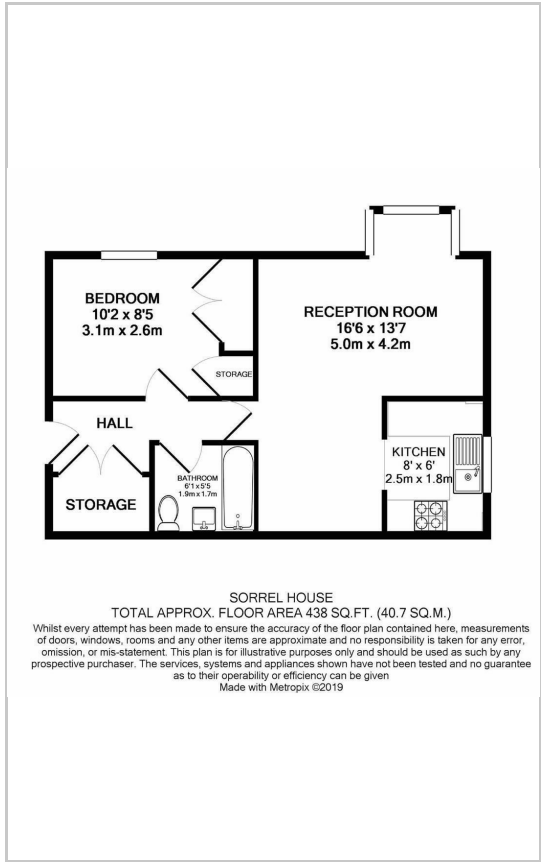

Energy Efficiency Graph

Energy Efficiency Rating		Current	Potential
<i>Very energy efficient - lower running costs</i>			
(92 plus) A			
(81-91) B			
(69-80) C			
(55-68) D			
(39-54) E			
(21-38) F			
(1-20) G			
<i>Not energy efficient - higher running costs</i>			
England & Wales		EU Directive 2002/91/EC	

These particulars, whilst believed to be accurate are set out as a general outline only for guidance and do not constitute any part of an offer or contract. Intending purchasers should not rely on them as statements of representation of fact, but must satisfy themselves by inspection or otherwise as to their accuracy. No person in this firm's employment has the authority to make or give any representation or warranty in respect of the property.