

ANTHONY JAMES MANSEY

Residential Sales & Lettings



Flat 86, Westgate House London Road

Isleworth, TW7 4AS

£1,525 Per Month



This stunning one bedroom apartment is in a great location on the London Road. With Isleworth Station serving Waterloo and Hounslow East Piccadilly Line being moments away plus local bus route just outside the development. The property comprises of a modern open plan style lounge and fitted kitchen, a double bedroom with mirrored wardrobes and bathroom with bath and shower attachment. The property also includes a balcony, electric heating, entry phone and free 1GB broadband until Jan-25!



Area Map



Floor Plans

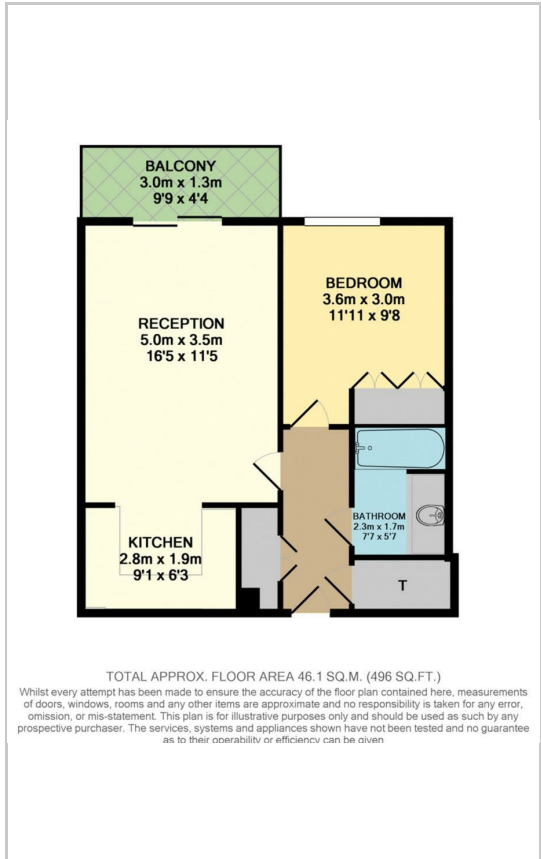

Energy Efficiency Graph

Energy Efficiency Rating		
	Current	Potential
<i>Very energy efficient - lower running costs</i>		
(92 plus) A		
(81-91) B		
(69-80) C		
(55-68) D		
(39-54) E		
(21-38) F		
(1-20) G		
<i>Not energy efficient - higher running costs</i>		
England & Wales	EU Directive 2002/91/EC	

These particulars, whilst believed to be accurate are set out as a general outline only for guidance and do not constitute any part of an offer or contract. Intending purchasers should not rely on them as statements of representation of fact, but must satisfy themselves by inspection or otherwise as to their accuracy. No person in this firm's employment has the authority to make or give any representation or warranty in respect of the property.