

# ANTHONY JAMES MANSEY

Residential Sales & Lettings



## 14 Hippisley Court 211 Worton Road

Isleworth , TW7 6DS

**Asking Price £350,000**

Anthony James Manser are pleased to present this very special apartment which includes two double bedrooms, one en suite, a modern family bathroom all fully tiled. There is a spacious open plan living space with a kitchen area including all modern appliances. This apartment also benefits a spacious roof terrace. There is also allocated parking included. The apartment is in a superb location close to the gates to Redlees Park, good bus links into Richmond and St Margarets.

### Viewing

Please contact our Sales Office on 020 8847 0488 if you wish to arrange a viewing appointment for this property or require further information.

- Two Double Bedroom Apartment
- Open Plan Living Room & Kitchen
- Allocated Parking Space
- Two Bathrooms
- Spacious Roof Terrace
- Gas Central Heating
- Double Glazed Windows
- Local Buses to Richmond & St Margarets
- Isleworth Station Serving Waterloo
- Close to Good Schools



2



2



1



C



## Floor Plan

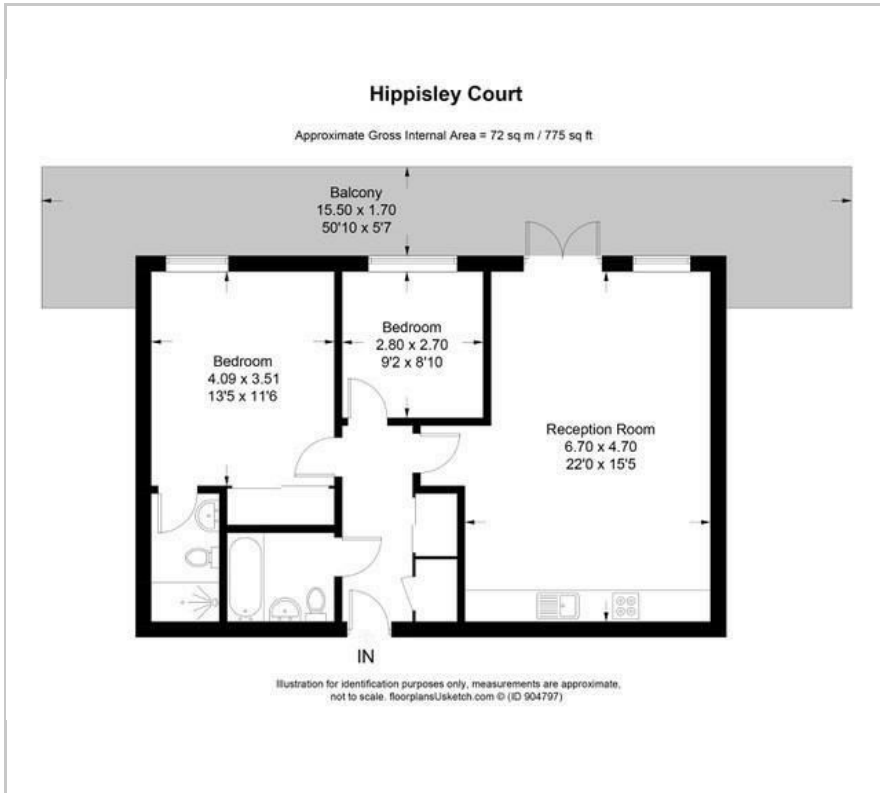

## Area Map



## Energy Efficiency Graph

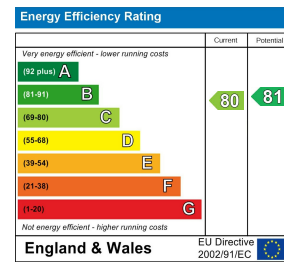

These particulars, whilst believed to be accurate are set out as a general outline only for guidance and do not constitute any part of an offer or contract. Intending purchasers should not rely on them as statements of representation of fact, but must satisfy themselves by inspection or otherwise as to their accuracy. No person in this firm's employment has the authority to make or give any representation or warranty in respect of the property.

Isleworth 22 St Johns Road, TW7 6NW

Tel: 020 8847 0488 Email: [sales@anthonyjamesmanser.co.uk](mailto:sales@anthonyjamesmanser.co.uk) <https://www.anthonyjamesmanser.co.uk/>