

ANTHONY JAMES MANSEY

Residential Sales & Lettings



23 Golden Court

Isleworth, TW7 4EQ

£300,000

An extremely well presented apartment situated in a well cared for building with entry phone system and lift. This development is for the over 60's only. The accommodation comprises entrance hallway, dual aspect lounge and dining area, two double bedrooms and modern kitchen and bathroom. Double glazed windows have been installed. The home is available chain free for an appointment to view please contact the owners sole agents.

Viewing

Please contact our Sales Office on 020 8847 0488 if you wish to arrange a viewing appointment for this property or require further information.

- An Exceptionally well Presented Apartment for the Over 60's
- Spacious Dual Aspect Living and Dining Area
- Two Double Bedrooms
- Modern Kitchen & Bathroom
- Double Glazed Windows
- Entryphone System and Lift
- Communal Gardens
- No chain Available Immediately
- Isleworth Station Serving Waterloo
- Regular Bus Services



Floor Plan

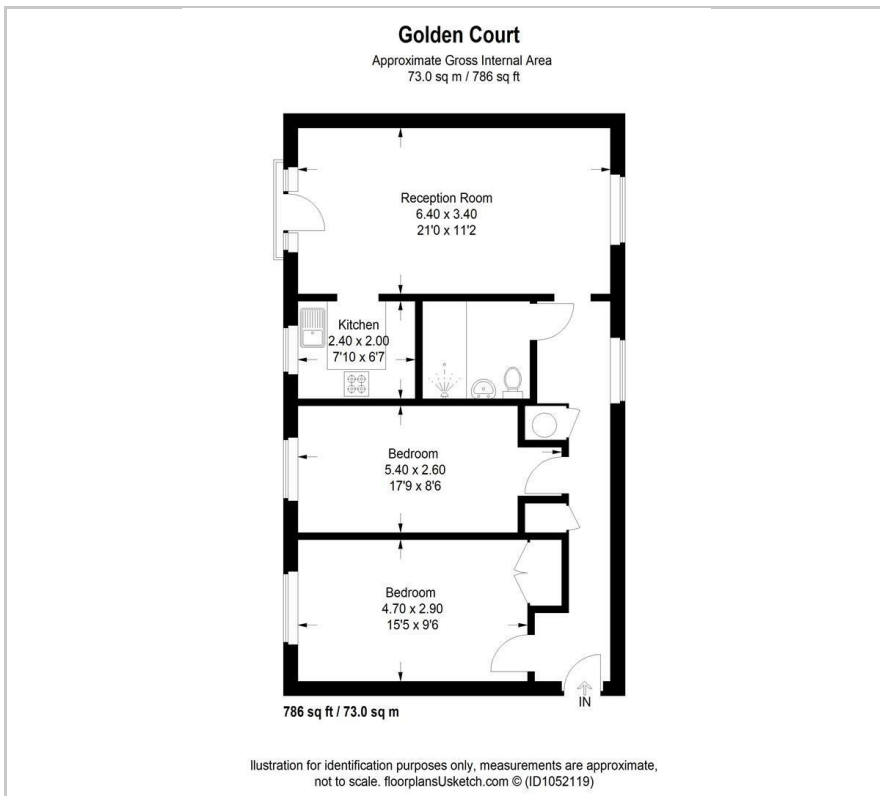

Area Map



Energy Efficiency Graph

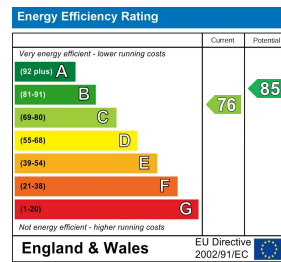

These particulars, whilst believed to be accurate are set out as a general outline only for guidance and do not constitute any part of an offer or contract. Intending purchasers should not rely on them as statements of representation of fact, but must satisfy themselves by inspection or otherwise as to their accuracy. No person in this firm's employment has the authority to make or give any representation or warranty in respect of the property.