

# ANTHONY JAMES MANSEY

Residential Sales & Lettings



## 13 The Close

Isleworth, TW7 4BL

### Guide Price £625,000

A 1930's built semi detached house with own drive and garage situated in an excellent location at the end of a cul-de-sac. The accommodation on the ground floor affords two reception rooms and kitchen, the first floor provides three bedrooms and bathroom. This home requires sympathetic renovation throughout and would be ideal to extend subject to planning permission. Isleworth station serves Waterloo within approximately 35 minutes. Osterley Station is on the Piccadilly line. This home is chain free.

- A 1930's Built Semi Detached House
- Own Drive to Garage
- Cul de Sac Location
- Three Bedrooms
- Requiring Sympathetic Renovation Throughout
- Ideal for Extension Subject to Planning Permission
- Isleworth Station Serving Waterloo
- Osterley Tube on the Piccadilly Line
- Vacant Possession Chain Free

### Viewing

Please contact our Sales Office on 020 8847 0488 if you wish to arrange a viewing appointment for this property or require further information.



## Floor Plan

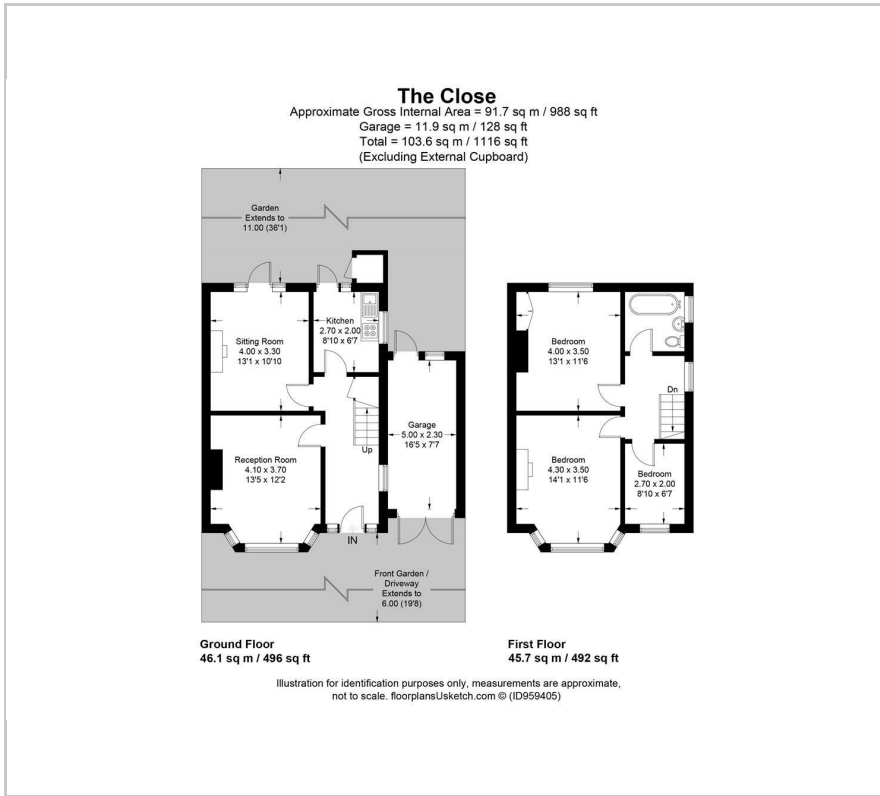

## Area Map



## Energy Efficiency Graph

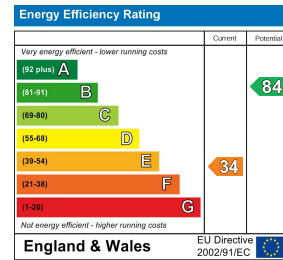

These particulars, whilst believed to be accurate are set out as a general outline only for guidance and do not constitute any part of an offer or contract. Intending purchasers should not rely on them as statements of representation of fact, but must satisfy themselves by inspection or otherwise as to their accuracy. No person in this firm's employment has the authority to make or give any representation or warranty in respect of the property.