

ANTHONY JAMES MANSER

Residential Sales & Lettings



5 Chase Court Amhurst Gardens

Isleworth, TW7 6AH

£360,000

This top floor apartment has been hugely improved by its present owners with the replacement of the bathroom with a white suite and subway style tiles. The kitchen has just been replaced and on our inspection was still in its wrappers! This property further affords a spacious reception room and two double bedrooms. The windows have been replaced and compliment the original style and build of the building. Communal enclosed back garden, with a new shed. Further features include a lease of approximately 147 years, low monthly outgoings, a floor to ceiling hallway cupboard. A short walk, along the river to Richmond upon Thames. Residential permit parking available outside property. This property is available with chain free possession and for first time buyers there is no stamp duty.

Lease details: 159 years from 16.02.2011 - 147 years remaining
Service Charge: £100 per month

Viewing

Please contact our Sales Office on 020 8847 0488 if you wish to arrange a viewing appointment for this property or require further information.

- Top Floor Apartment
- Spacious Reception Room
- Two Double Bedrooms
- Excellent Modern Bathroom
- Newly Fitted Kitchen
- Double Glazed Windows
- Chain Free
- Long Lease Approximately 147 years and Low Service Charge
- Close to Isleworth Primary School
- Communal Enclosed Back Garden, with a New Shed.

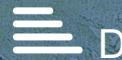

Floor Plan

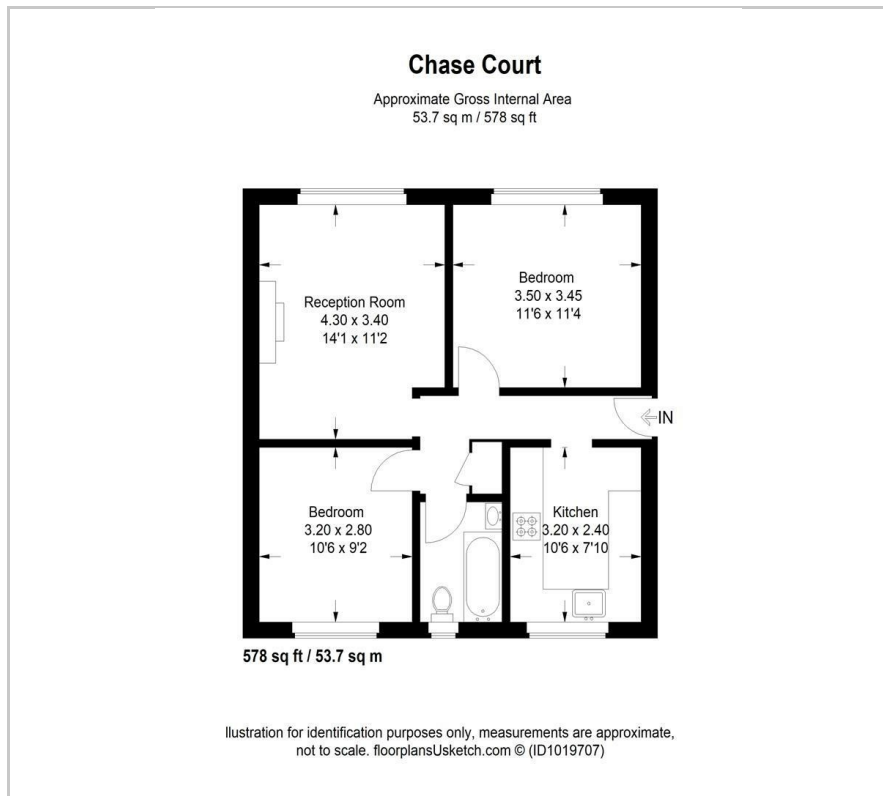

Area Map



Energy Efficiency Graph

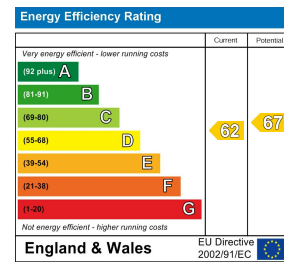

These particulars, whilst believed to be accurate are set out as a general outline only for guidance and do not constitute any part of an offer or contract. Intending purchasers should not rely on them as statements of representation of fact, but must satisfy themselves by inspection or otherwise as to their accuracy. No person in this firm's employment has the authority to make or give any representation or warranty in respect of the property.