

ANTHONY JAMES MANSER

Residential Sales & Lettings



8 Richardson House Malting Way

Isleworth, TW7 6SD

£270,000

We are pleased to present this lovely one bedroom first floor apartment located in the highly sought after and popular modern Maltings development. The property comprises double bedroom with built in wardrobes, spacious lounge/dining room, separate kitchen and bathroom with bath and over head shower. The apartment also benefits from brand new double glazed windows throughout, gas central heating (not tested), entry phone and allocated parking. This property is ideal for first time buyers (No stamp duty) also a great rental investment buy. Isleworth Station serves Waterloo, H37 hopper bus provides a regular service into Richmond.

Lease: 125 years 96 years remaining
Service Charge: £1,348.92 per annum
Ground Rent: £100 per annum

Viewing

Please contact our Sales Office on 020 8847 0488 if you wish to arrange a viewing appointment for this property or require further information.

- One Bedroom First Floor Apartment
- Popular Maltings Development
- Good Sized Living/Dining Area
- Separate Kitchen
- Allocated Parking Space
- Double Glazed Windows
- Gas Central Heating (not tested)
- Close to Isleworth Station Serving Waterloo
- H37 Hopper Bus into St Margarets & Richmond
- River Thames within a short walk away



Floor Plan

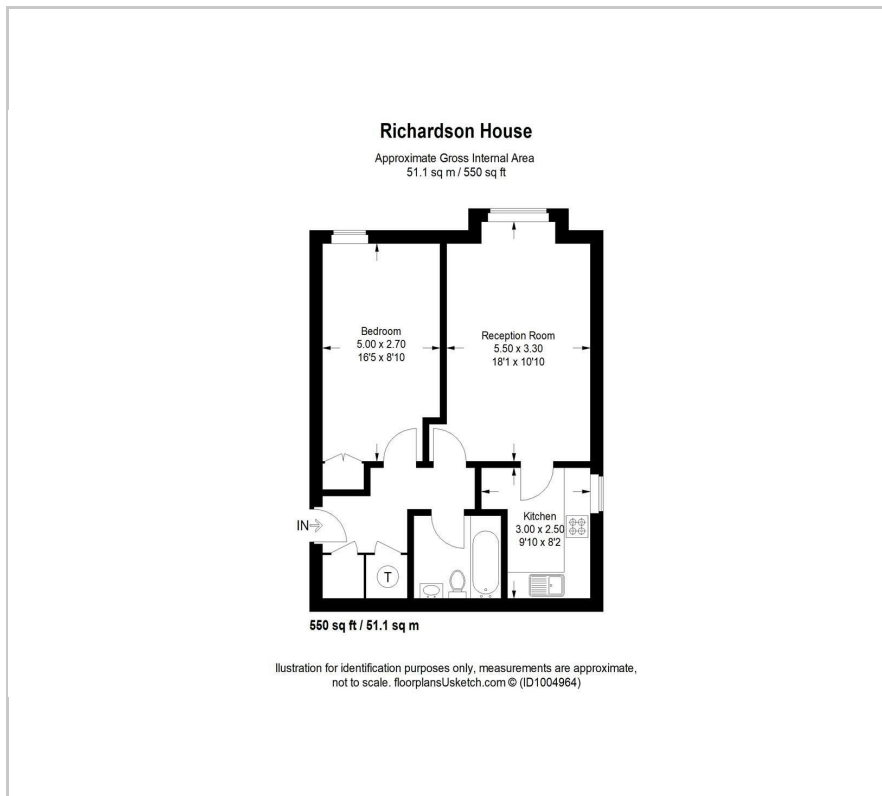

Area Map



Energy Efficiency Graph

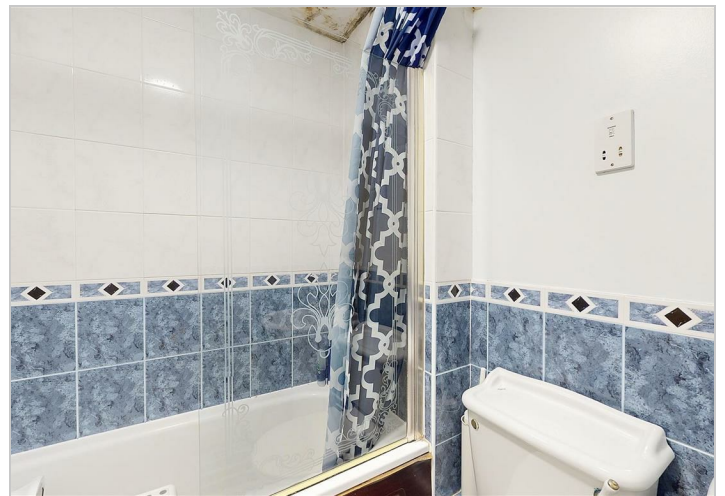
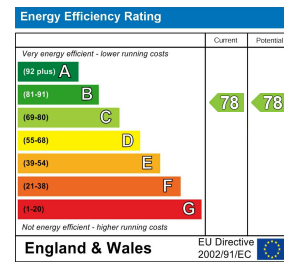

These particulars, whilst believed to be accurate are set out as a general outline only for guidance and do not constitute any part of an offer or contract. Intending purchasers should not rely on them as statements of representation of fact, but must satisfy themselves by inspection or otherwise as to their accuracy. No person in this firm's employment has the authority to make or give any representation or warranty in respect of the property.