



2

Bedrooms



1

Bathroom

McConnells

Guide price £320,000
High Road, Wilmington, Dartford, Kent DA2 7BW



Guide Price.....£320,000 to £340,000.....

Offered with no forward chain McConnells are delighted to bring to the market this well presented 2 bedroom house situated in the desirable area of Wilmington on the outskirts of Dartford. Perfectly located the property is within easy access the local boys and girls Grammar schools as well as the A2/M25 motorways. To the ground floor the property comprises lounge and kitchen with 2 bedrooms and bathroom to the first floor.

Lounge: 11'5 x 11 (3.48m x 3.36m) Timber panelled door, ornate fire place with surround, timber framed window, fitted cupboard housing gas & electric meters, wood stained floor boards, double radiator

Kitchen: 11'5 x 11 (3.48m x 3.36m) Fitted wall and base units with wood block effect worksurfaces and splashback tiling, built in electric oven, electric glass hob and extractor hood, 1½ bowl ceramic sink with drainer with chrome monobloc tap, space for washing machine and fridge/freezer, UPVC double glazed window, tiled floor, double radiator, timber glazed door leading to rear garden

Bedroom 1: 11'5 x 11 (3.48m x 3.36m) Exposed white washed brickwork feature wall, timber framed window, fitted carpet, double radiator

Bedroom 2: 8'10 x 7'11 (2.71m x 2.41m) Built in cupboard housing gas fired central heating boiler, UPVC double glazed window, fitted carpet, double radiator

Bathroom: 5'11 x 5'8 (2.71m x 2.41m) White bathroom suite comprising panelled bath with chrome shower mixer tap and attachments, wc, wash hand basin with chrome taps, part tiled walls with central border, extractor fan, vinyl floor covering, double radiator

Rear Garden: 59ft (18m) Paved patio area, lawn and mature shrubs and plants, shed and garden tap

GROUND FLOOR

APPROX. 23.7 SQ. METRES (255.5 SQ. FEET)

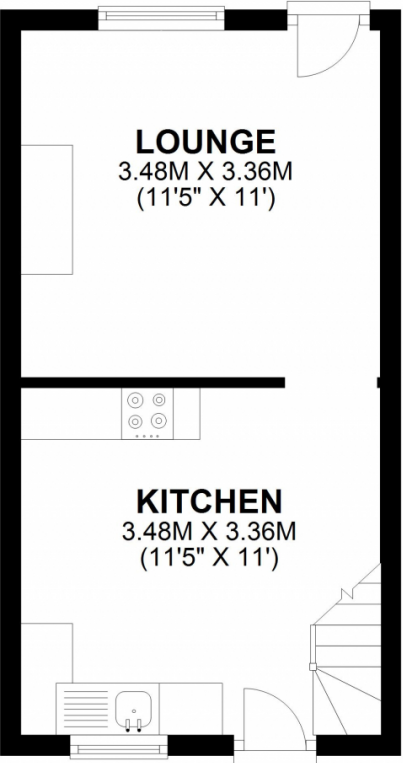

FIRST FLOOR

APPROX. 23.9 SQ. METRES (256.8 SQ. FEET)

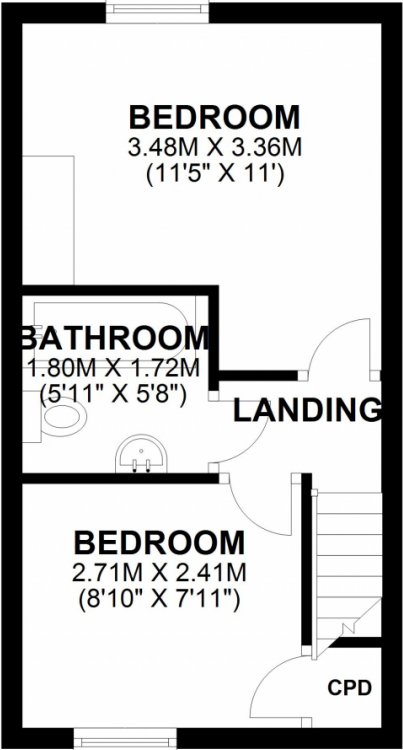

TOTAL AREA: APPROX. 47.6 SQ. METRES (512.2 SQ. FEET)

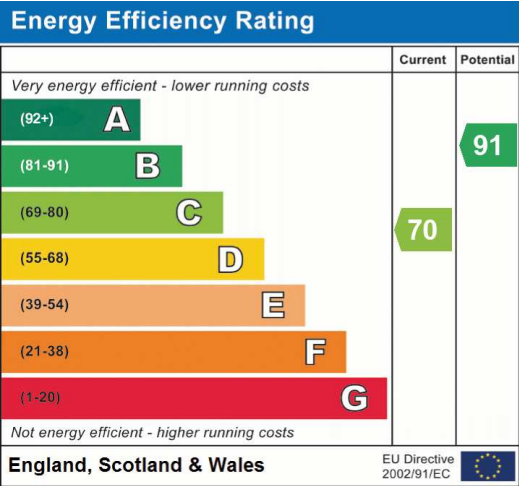

Address: High Road, Wilmington, Dartford, Kent DA2 7BW

