



 2
Bedrooms

 1
Bathroom



Available with no forward chain is this modern built 2 bedroom end of terrace house situated within close proximity of Ebbsfleet International Train Station which would be ideal for a first time purchaser or for the buy to let investor. Amenities such as schools, shops and local bus routes are all close to hand as well as easy access onto the A2/M25 motorways.

Accommodation consists of an entrance hall, kitchen, lounge and cloakroom/WC to the ground floor with 2 double bedrooms and family bathroom to the first floor. The rear garden is south westerly facing with pedestrian access and en-bloc single garage

GROUND FLOOR

APPROX. 33.4 SQ. METRES (359.8 SQ. FEET)

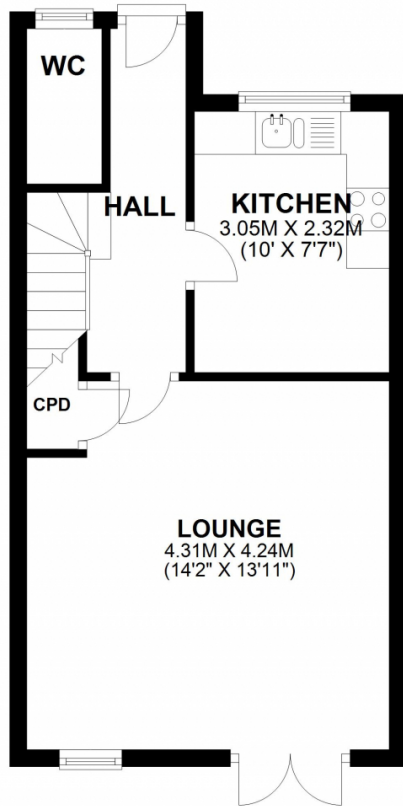

FIRST FLOOR

APPROX. 31.9 SQ. METRES (343.1 SQ. FEET)

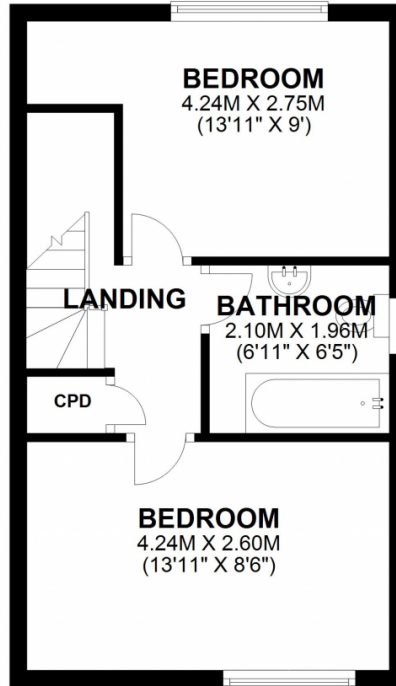

TOTAL AREA: APPROX. 65.3 SQ. METRES (702.9 SQ. FEET)

Energy Efficiency Rating		
	Current	Potential
<i>Very energy efficient - lower running costs</i>		
(92+)	A	
(81-91)	B	88
(69-80)	C	71
(55-68)	D	
(39-54)	E	
(21-38)	F	
(1-20)	G	
<i>Not energy efficient - higher running costs</i>		
England, Scotland & Wales		EU Directive 2002/91/EC

Address: Dover Road, Northfleet, Kent DA11 9PJ

