



Wellington Street, Swindon, SN1 1EB

£825PCM (Deposit: £825)

 1  1  1



Tax Band: A Furnished: Unfurnished

A redecorated, 3rd floor, one bedroom flat located in the popular area of Central Swindon. Presented to a high standard throughout this home must be viewed to appreciate. Garage and parking included - Available now





GROUND FLOOR
384 sq.ft. (35.6 sq.m.) approx.

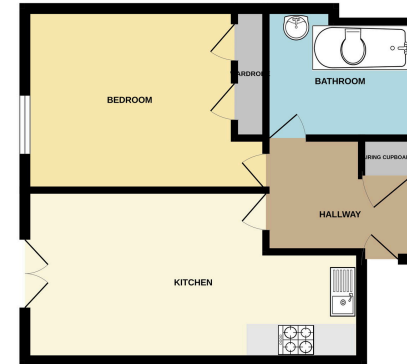

TOTAL FLOOR AREA: 384 sq.ft. (35.6 sq.m.) approx.
While every attempt has been made to ensure the accuracy of the floor plan, measurements are approximate and should not be used for legal purposes. The floor plan is provided for information only and does not constitute a contract. The floor plan is provided for information only and does not constitute a contract.

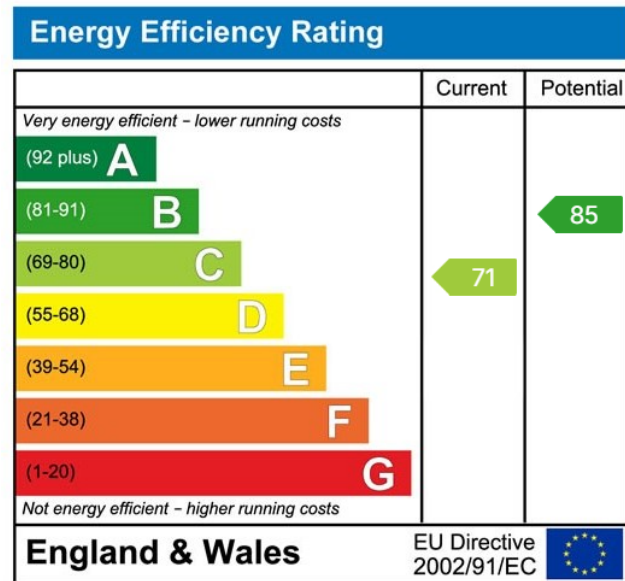

www.moovahome.co.uk

Unit 20 Ergo Business Park, Kelvin Road, Swindon SN3 3JW

Telephone 01793 512345

hello@moovahome.co.uk

Lettings: Mr A. Cain T/A Moovahome
Moovahome, Unit 20 Ergo Business Park, Kelvin Road, Swindon SN3 3JW

Sales: Moovahome is a trading name of Moovahome Ltd.
Registered Office: Unit 20 Ergo Business Park, Kelvin Road, Swindon SN3 3JW