

# CHRISTIE

R E S I D E N T I A L



## 6 Limetree Mews, Station Road, Abergavenny, NP7 5JB

A two bedroom semi-detached house conveniently located moments from Abergavenny railway station and a short walk from the amenities of the town centre. The property benefits from two double bedrooms, a low maintenance patio garden and no onward chain.

- Semi-Detached House
- Two Double Bedrooms
- Convenient Location
- L-Shaped Lounge/Diner
- Separate Fitted Kitchen
- No Onward Chain

---

Price                      £185,000

---



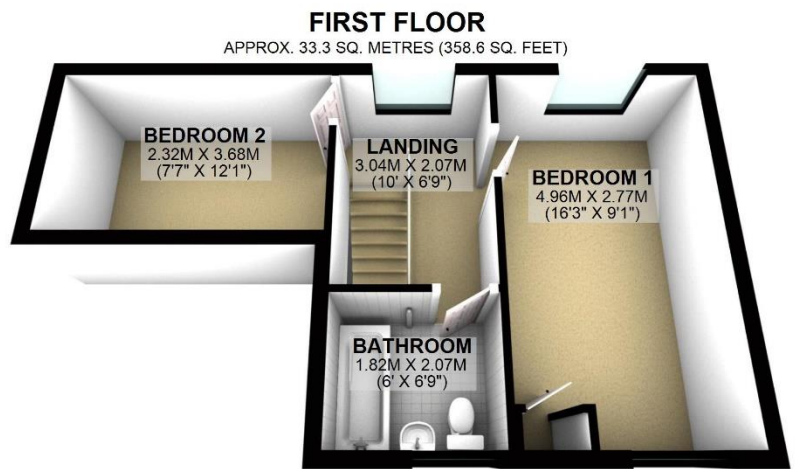
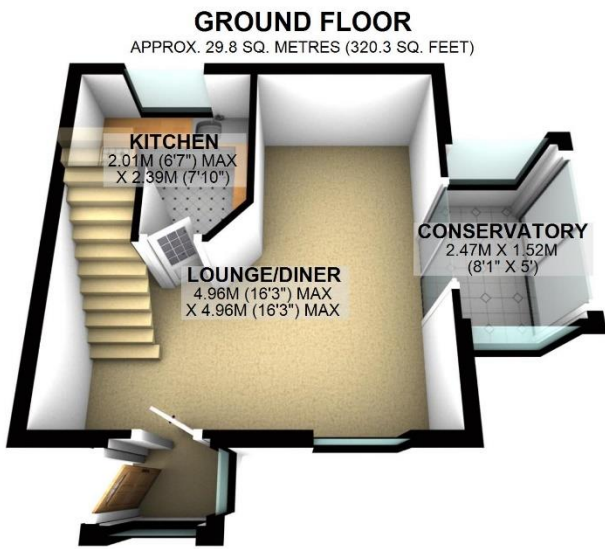

TOTAL AREA: APPROX. 63.1 SQ. METRES (678.9 SQ. FEET)

Energy Efficiency Rating			
Score	Energy rating	Current	Potential
92+	A		
81-91	B		86   B
69-80	C		
55-68	D	67   D	
39-54	E		
21-38	F		
1-20	G		

# CHRISTIE

R E S I D E N T I A L

## About this property

A two bedroom semi-detached house conveniently located moments from Abergavenny railway station and a short walk from the amenities of the town centre, and the riverside walks of Castle Meadow. The property affords accommodation comprising an entrance porch that opens to the 16' L-shaped lounge/diner off which is a separate fitted kitchen and conservatory. Upstairs there are two comfortable double bedrooms and a three piece bathroom. The property forms part of a small mews development with parking available on a first come first served basis at the rear. It also benefits from a low maintenance patio garden and no onward chain.

## About the location

A popular market town nestled amidst the Seven Beacons with its skyline dominated by the Blorenges and the Sugar Loaf mountains, Abergavenny is known as the 'Gateway to Wales'. It is situated twelve miles from the English border and just south of the Black Mountains in the Brecon Beacons National Park. Steeped in history Abergavenny was originally a Roman Fort then a medieval walled town. It is now a market town with arguably more life than nearby Usk and Monmouth. It offers a wide range of amenities with major supermarkets, popular bi-weekly, a high street comprising of recognized chains and local department stores, leisure centre, a number of churches and Nevill Hall Hospital. Abergavenny, is world renowned for its Food Festival which brings the UK's best chefs and culinary experts to the town every September. The town also offers a rich and vibrant range of cultural options including the Borough Theatre which offers an all year round programme of professional and amateur events, and the annual Abergavenny Writing Festival. Its location means that Abergavenny acts as the major transport hub for the area. The railway station allows easy access to anywhere on the rail network. The A465, Heads of the Valleys Road is one mile out of town with the M50 / M4 a further 25 minutes away.

## Directions

Take the A40, Monmouth Road, out of the Town Centre. After half a mile turn left (signposted for the Station) onto Station Road. Limetree Mews is the third right turn just before the train station

## USEFUL information

**COUNCIL TAX:** Band D. The local authority is Monmouthshire County Borough Council – 01633 644644

**SERVICES:** We understand that mains gas, electricity, water & sewerage are connected to the property. Ultrafast broadband is available (provided by Openreach/Ogi) with an estimated maximum speed of 1000 mbs. For information on mobile coverage please use Ofcom's 'mobile and broadband checker'.

**TENURE:** We believe the property to be Freehold. Prospective purchasers should make their own enquiries to verify this via their legal representative prior to formally completing any purchase.

**VIEWING:** Strictly by prior appointment via Christie Residential on 01873 852221. Please note it is a condition of issuing these sales particulars that all negotiations regarding this property are conducted through the sellers' Agent, Christie Residential.

---

Consumer Protection from Unfair Trading Regulations 2008.

Please be aware that neither Christie Residential nor the sellers have tested any apparatus, equipment, fixtures and fittings or services, unless otherwise advised, and therefore it cannot be verified that they are in good working order and fit for the purpose. As a result, buyers are advised to obtain verification from their Solicitor, Surveyor or suitably qualified tradesman regarding these matters. Unless otherwise stated, Christie Residential have not had sight of the title documents therefore buyers are advised to obtain verification from their Solicitor as to the Tenure of a Property. Items shown in photographs are not necessarily included in the sale unless specifically stated in the sales particulars but may be available to purchase by separate negotiation. Buyers must check the availability of a property before embarking on any journey to conduct a viewing. It is an explicit condition of these sales particulars that all appointments to view and any subsequent negotiations are conducted exclusively via Christie Residential, as owners' agents.