



2

Bedrooms



1

Bathroom



Top floor penthouse apartment - Fully furnished - views across worth forest - Juliette balcony - 2 double bedrooms - Fitted wardrobe - Large bathroom - Fully fitted kitchen - Close to shops, park and schools

A top floor apartment with views across Worth forest and MAIDENBOWER from your Juliette balcony. This contemporary apartment has two large double bedrooms with fitted wardrobes and a large airy bathroom. The kitchen and dining area boasts all appliances including dishwasher, whilst the lounge impresses with a mix of modern furniture and stylish decor.

Access is easy with only a short walk to the local shops, park and schools whilst the M23 is only two minute's drive from the development. A budget price for a modern contemporary lifestyle.

ABOUT US:-

Onerent is an independent landlord, and we own or privately manage all of the properties that we offer for rental. We specialise in the provision of comfortable and clean fully furnished rental properties, and you are assured of a service and quality that you will not have previously experienced with either an estate agent or relocation service.

All of our properties are selectively purchased to ensure that our tenants enjoy the very best positions and locations on the rental market with regards to local amenities and travel criteria. We supply accommodation to most of the major corporate entities in the UK, either directly or through most of the business relocation companies, and our experience and client base ensures that your rental experience will be of a standard that is more than acceptable on both a business and private basis.

Please call us on 0800 027 5660, and we will furnish you with all of the information that you require to make your stay as pleasant as possible.

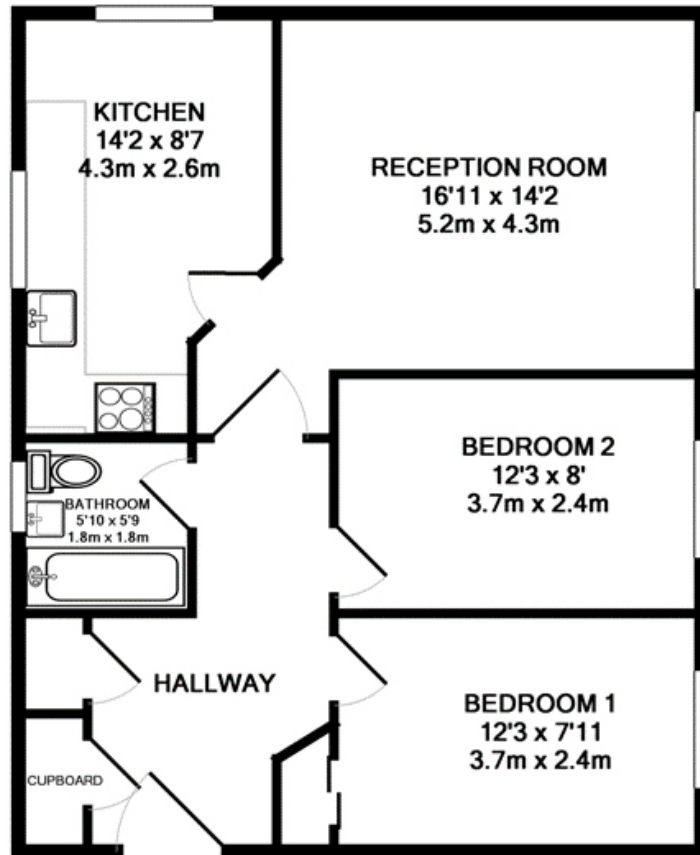

Energy Efficiency Rating

	Current	Potential
Very energy efficient - lower running costs		
(92-100) A		
(81-91) B		
(69-80) C		75
(55-68) D	67	
(39-54) E		
(21-38) F		
(1-20) G		
Not energy efficient - higher running costs		
England, Scotland & Wales	EU Directive 2002/91/EC 