



11 Johnson Way, Ford, Ford, West Sussex, BN18 0TD

£795 PCM

- AVAILABLE NOW
- Own Private Entrance
- 13'7 Lounge
- Residents Parking Area
- FULLY BOOKED ON VIEWINGS
- Recently Refitted Kitchen
- White Bathroom Suite
- One Bedroom Purpose Built Ground Floor Flat
- 13'7 Bedroom
- Communal Gardens

Ground Floor

Approx. 39.4 sq. metres (423.6 sq. feet)

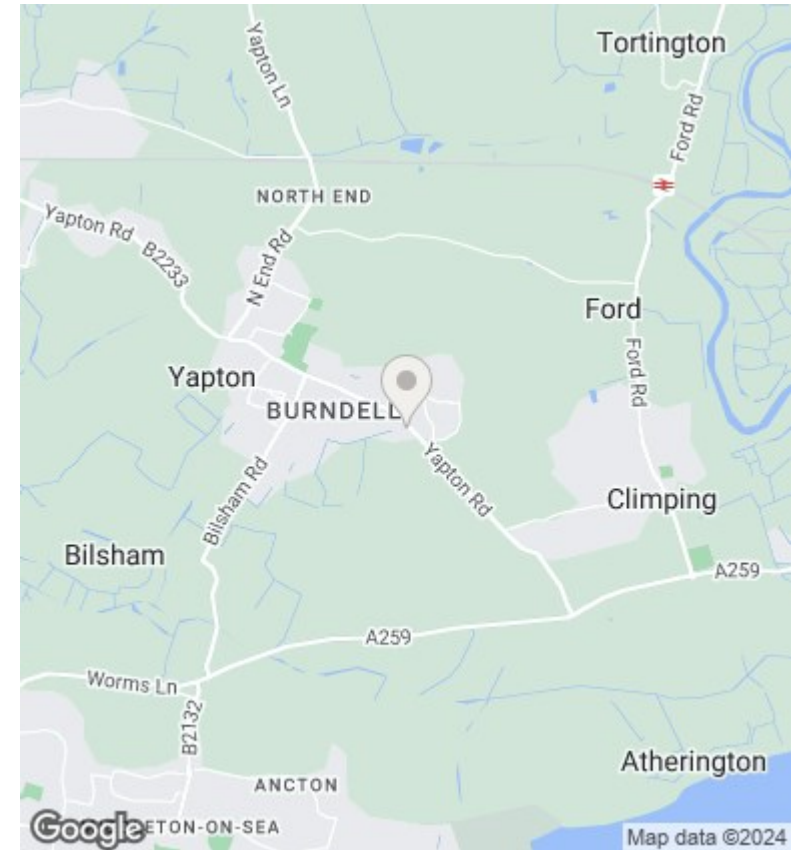
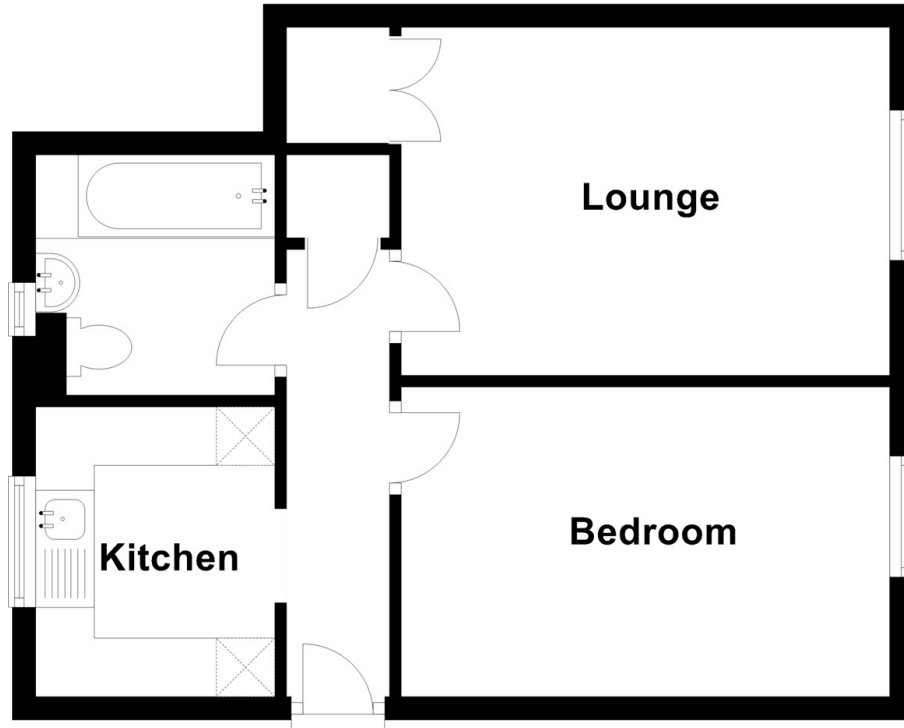

Directions

Viewings

Viewings by arrangement only. Call 01903 719333 to make an appointment.

Council Tax Band

EPC Rating:

Energy Efficiency Rating		Current	Potential
<i>Very energy efficient - lower running costs</i>			
(92 plus) A			
(81-91) B			
(69-80) C			
(55-68) D			
(39-54) E			
(21-38) F			
(1-20) G			
<i>Not energy efficient - higher running costs</i>			
England & Wales		EU Directive 2002/91/EC	