

Existing Site Plan

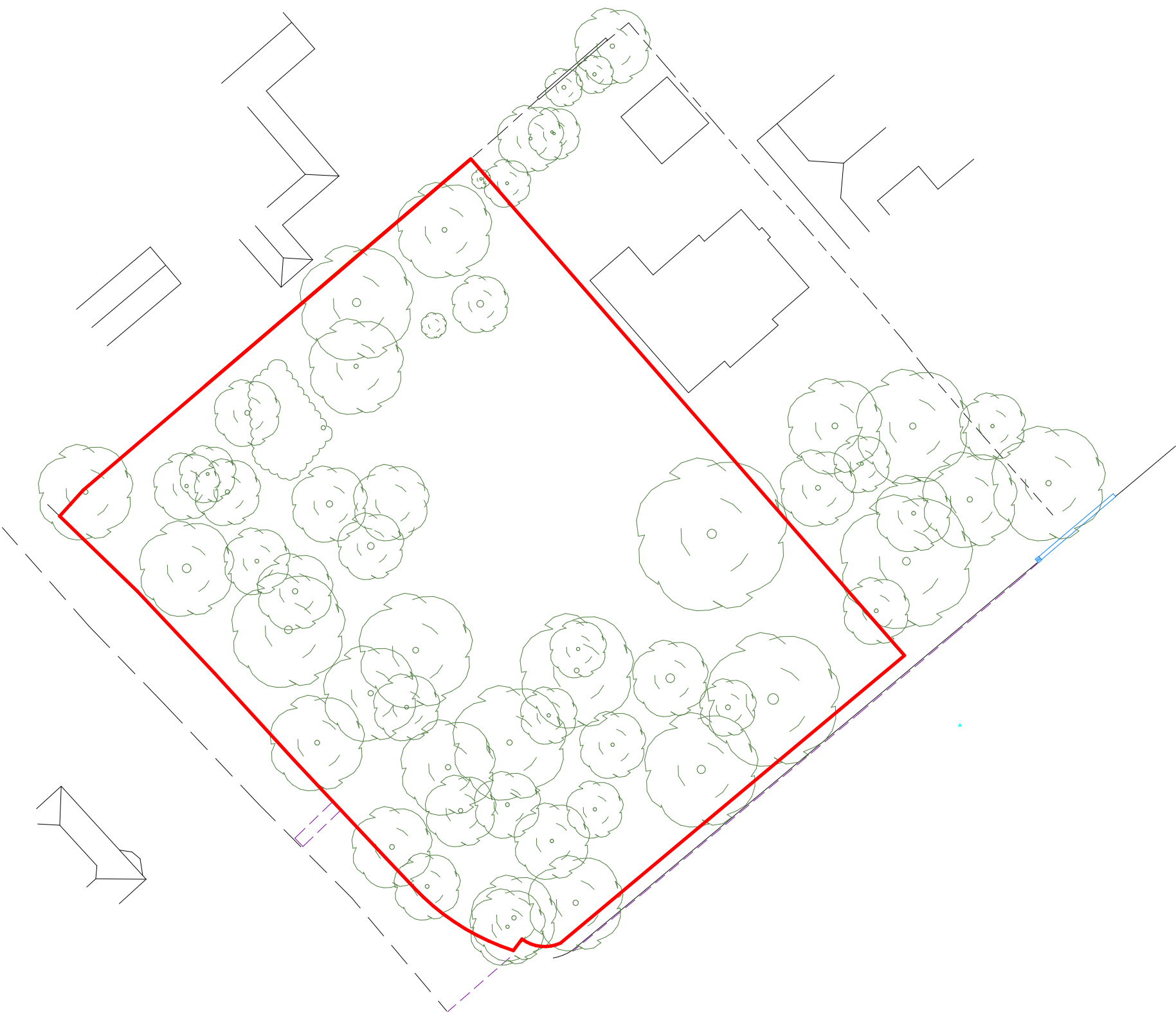

Proposed Site Plan

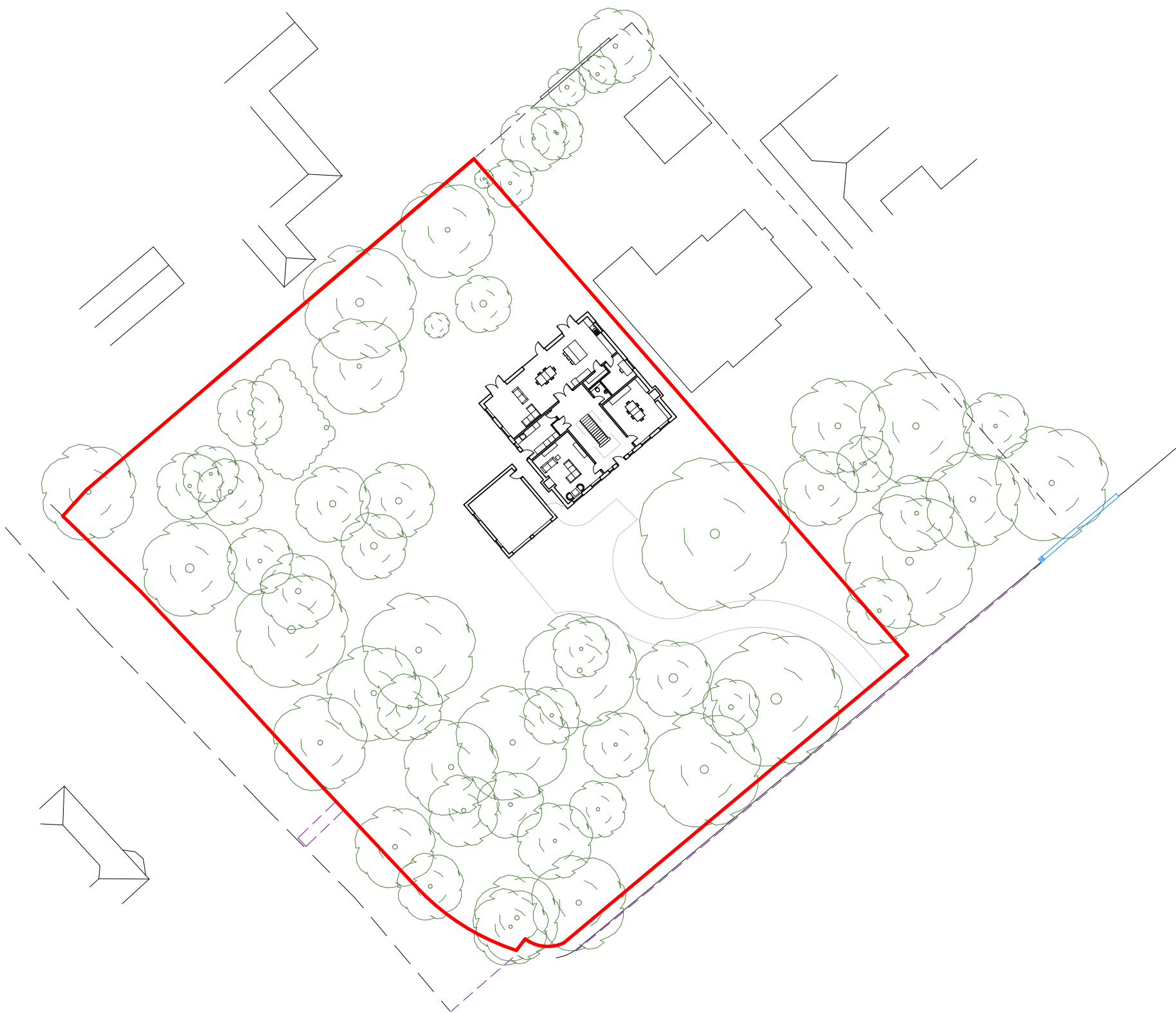

Notes:
Do not scale from this drawing. It is the contractor's responsibility to check all governing dimensions and verify all dimensions on site before commencing any work or making any shop drawings. This drawing is to be read in conjunction with the structural, mechanical and electrical drawings and other relevant information and any discrepancies are to be reported to the Architect. Work and materials to be in accordance with the current Building Regulations and to comply with all relevant British Standards. This drawing should not be reproduced in whole or in part without their written permission. This drawing is a sketch only, subject to the relevant planning permissions and statutory requirements (including Building Regulations). The Local Building Control department should be contacted to approve the works prior to work starting on site. These drawings are concept only and therefore should not be used for construction purposes.

Note:
This drawing was created using documents given by the client that were created by previous contractors, no measured survey was carried out to create these drawings. A measured survey should be carried out before any work takes place to ensure accuracy of dimensions

Note:
Fire detection and escape strategy to be confirmed with Building Control as part of the Building Regulations submission prior to construction starting. Fire compartments (walls, floors and ceilings) to be agreed and constructed to maintain the minimum fire resistance required both within the unit and between this and other buildings.

27 Warning Tongue Lane, Doncaster
Existing and Proposed Site Plans
Scale 1:500 @ A2
January 2024
Concept Design - For Information Only
Not For Construction

Callums Architectural Services
Architectural Designer / Draftsman
Doncaster
caldrumzo@gmail.com
Mob : 07926251700
Facebook : @CallumsArch