



Billy Lows Lane | | Potters Bar | EN6 1XN

Price Guide £1,150,000

FINE & COUNTRY

Billy Lows Lane |
Potters Bar | EN6 1XN
Price Guide £1,150,000

This five-bedroom detached family home offers a perfect blend of modern living and traditional comfort. With four reception rooms, a beautifully extended kitchen, and a versatile layout, this home is perfect for growing families. The property also features a south-facing garden, a garage, and ample off-street parking. Located within walking distance to Potters Bar station and excellent local schools, this is an opportunity not to be missed.

- DETACHED 5 BEDROOM HOME
- SOUTH FACING GARDEN APPROX. 150FT
- UTILITY ROOM
- GARAGE
- 4 RECEPTION ROOMS
- DOWNSTAIRS SHOWER ROOM AND BEDROOM
- DRIVEWAY
- WALKING DISTANCE TO POTTERS BAR STATION

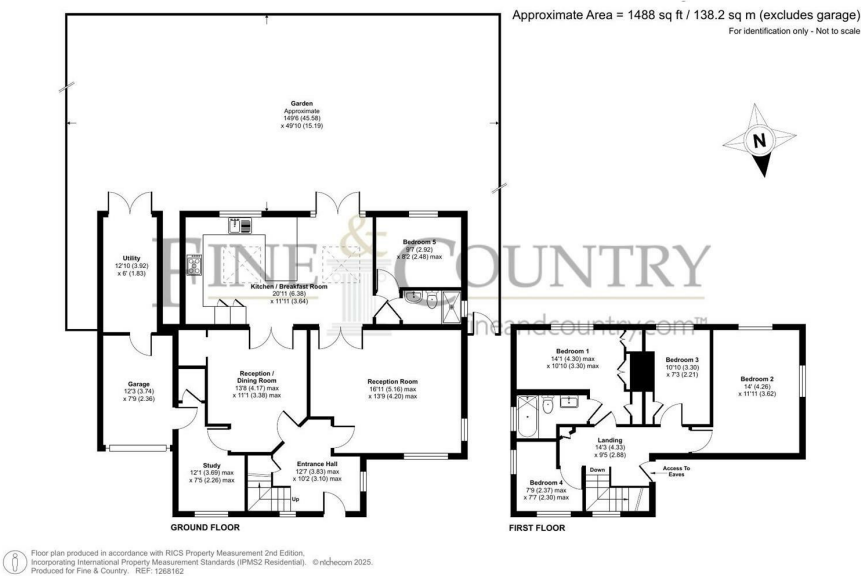

Energy Efficiency Rating		
	Current	Potential
Very energy efficient - lower running costs		
(92 plus) A		
(81-91) B		83
(69-80) C		
(55-68) D	65	
(39-54) E		
(21-38) F		
(1-20) G		
Not energy efficient - higher running costs		
England & Wales	EU Directive 2002/91/EC	

The Estate Office
Bradmore Green
Brookmans Park
Hatfield
Hertfordshire
AL9 7QS
01707 662222