



The Ridgeway | Cuffley | Hertfordshire | EN6 4BB

Price Guide £3,550,000

FINE & COUNTRY

The Ridgeway | Cuffley
Hertfordshire | EN6 4BB
Price Guide £3,550,000

A substantial 5-bedroom family home approaching 6,500 sq ft of luxury accommodation boasting an indoor swimming pool complex, 5 receptions, 5 en-suites and glorious south west facing grounds of approx. 1.5 acres with views over surrounding countryside and the London skyline on the horizon.

- A SUBSTANTIAL 6,500 SQ FT
- APPROX 1.5 ACRES
- 5 BEDROOMS
- 5 BATHROOMS
- 5 RECEPTIONS
- SPECTACULAR VIEWS
- SWIMMING POOL COMPLEX
- LUXURIOUS HOME



The Ridgeway, Cuffley, Potters Bar, EN6
Approximate Area = 6,760 sq ft / 620 sq m (inc. Garage)

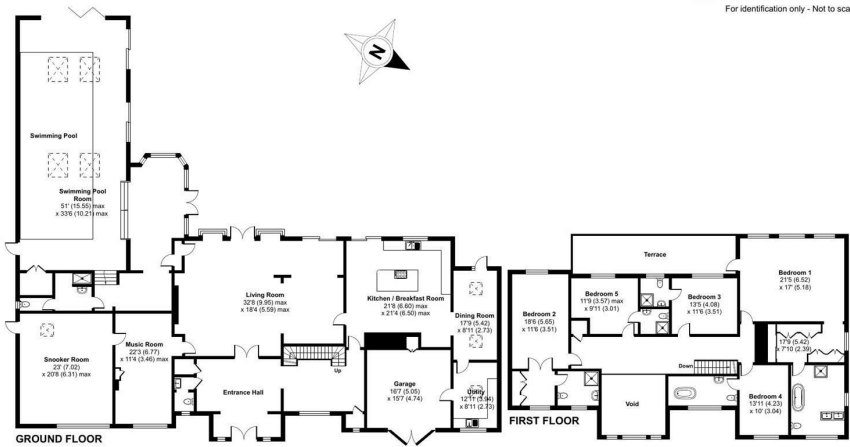

Floor plan produced in accordance with RICS Property Measurement 2nd Edition, incorporating International Property Measurement Standards (IPMS2 Residential). © richcom 2025. Produced for Fine & Country. REF: 1188032

Energy Efficiency Rating		
	Current	Potential
Very energy efficient - lower running costs		
(92 plus) A		
(81-91) B		
(69-80) C	75	80
(55-68) D		
(39-54) E		
(21-38) F		
(1-20) G		
Not energy efficient - higher running costs		
England & Wales		EU Directive 2002/91/EC

The Estate Office
Bradmore Green
Brookmans Park
Hatfield
Hertfordshire
AL9 7QS
01707 662222