





Blanche Lane

A large 5 bed detached family home with additional 1 bed annex, featuring, double garage, heated swimming pool, games room, gym, gated drive, large rear garden with 2 stables plus fully tiled and heated dog kennels.

Upon entering there is a large hallway that is currently being used as an additional reception room, to the right is a cinema room and to left is a spacious living room which in turn leads to the dining room and joins the modern fitted kitchen leading into the utility room. There is also a downstairs wet room.

Upstairs are 5 double bedrooms, all benefiting from vaulted ceilings to make the bedrooms feel even bigger along with a family bathroom. The two rear bedrooms boast of natural light and views of the rear garden through the Juliet balcony as well as the master having an en suite.

To the front is a large, gated driveway which offers plenty of off-street secure parking. There is front and rear access to the annex, games room and gym featuring a shower room. There is additional space for parking through the rear side access that leads to the double garage. The garden provides plenty of space while still having a large patio area and heated swimming pool.

Situated in a prime location, South Mimms offers excellent transport links with easy access to the AIM and M25 motorways, ideal for commuters. Additionally, the nearby Potters Bar train station provides further convenience for the fast train into Kings Cross in 16 minutes.





Tenure: Freehold
Council Tax: Band G
Local Authority: Hertsmere



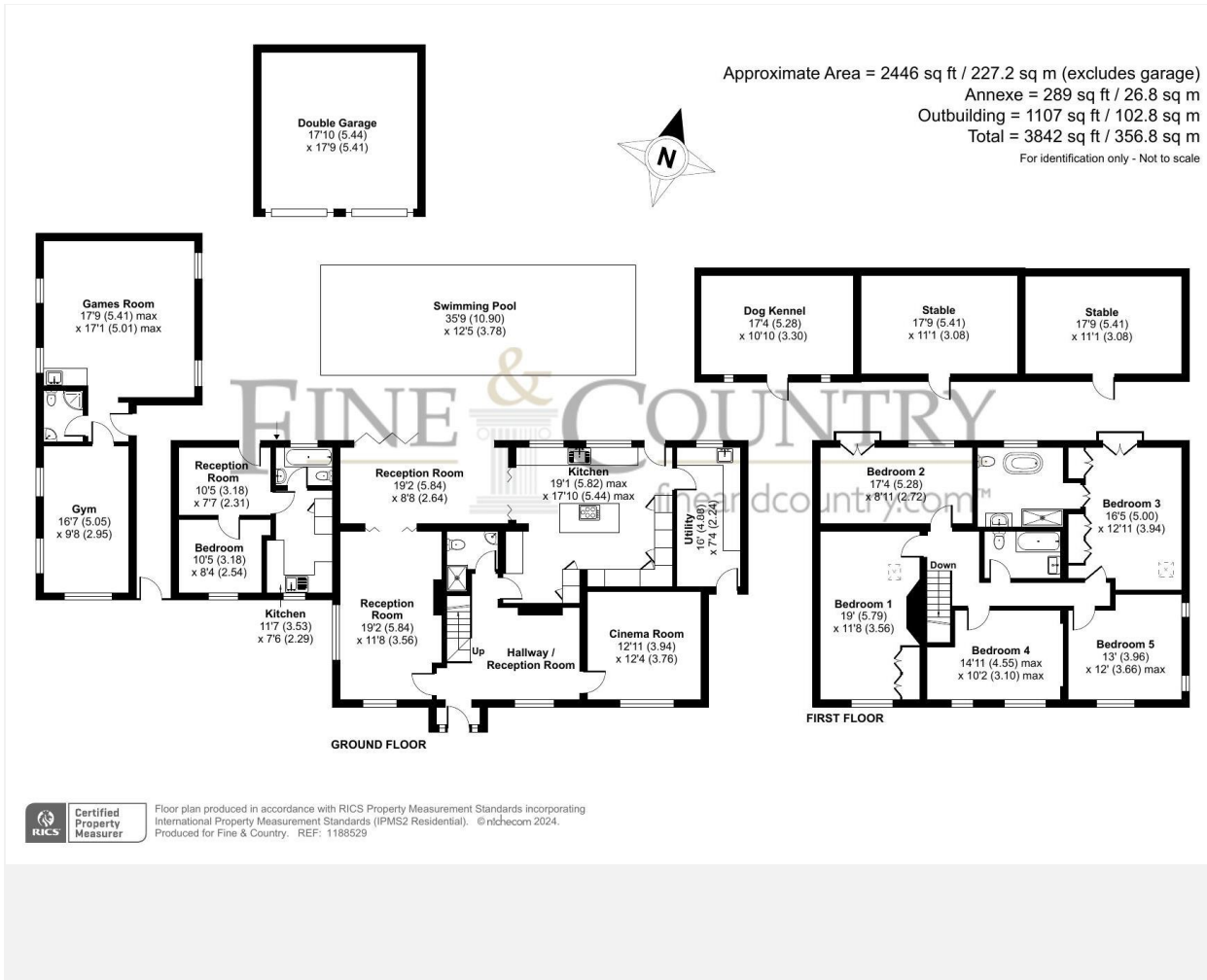

Agents Note: Whilst every care has been taken to prepare these particulars, they are for guidance purposes only. All measurements are approximate are for general guidance purposes only and whilst every care has been taken to ensure their accuracy, they should not be relied upon and potential buyers/tenants are advised to recheck the measurements

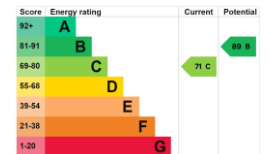

The Estate Office
 Bradmore Green
 Brookmans Park
 Hertfordshire
 AL9 7QS

01707 662222
 fineandcountry.com
 brookmanspark@fineandcountry.com

Opening Hours
 Monday – Friday: 9 - 6pm
 Saturday: 9 - 4pm

