



Heath Road | | Little Heath, Potters Bar | EN6 1LJ

Offers In The Region Of £925,000

FINE & COUNTRY

Heath Road |
Little Heath, Potters Bar | EN6 1LJ
Offers In The Region Of £925,000

Nestled in the charming area of Little Heath, Potters Bar, this delightful 4-bedroom (2 doubles and 2 singles) detached family home is a true gem waiting to be discovered. Recently decorated, this property exudes a fresh and inviting atmosphere that is sure to captivate your heart.

- DETACHED
- SEPARATE UTILITY
- CLOSE TO AMENITIES
- 4 BEDROOMS
- LARGE KITCHEN/DINER
- RECENTLY DECORATED
- DRIVEWAY
- CLOSE TO SCHOOLS

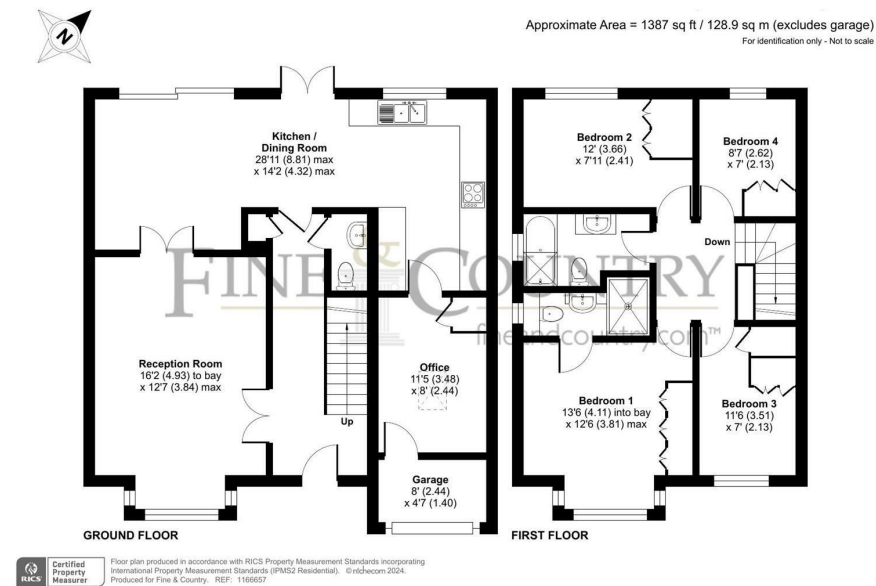

Energy Efficiency Rating		
	Current	Potential
Very energy efficient - lower running costs		
(92 plus) A		
(81-91) B		
(69-80) C	69	80
(55-68) D		
(39-54) E		
(21-38) F		
(1-20) G		
Not energy efficient - higher running costs		
England & Wales	EU Directive 2002/91/EC	

The Estate Office
Bradmore Green
Brookmans Park
Hatfield
Hertfordshire
AL9 7QS
01707 662222