

2 CASTLE HILL
RICHMOND, DL10 4QP

£700 PCM

A Prominent Ground Floor Shop/Office just off the Richmond Market Place. Entrance Lobby, 2 Shop/Office Rooms totalling 308 sq ft (28.61 sq m), Kitchen, WC.

NORMAN F. BROWN

Est. 1967

2 CASTLE HILL

- PROMINENT GROUND FLOOR

SHOP/OFFICE UNIT • 2 Shop/Office Rooms totalling 308 sq ft (28.61 sq m), Kitchen, WC.



DESCRIPTION

A Prominent Ground Floor Shop/Office just off the Richmond Market Place. Entrance Lobby, 2 Shop/Office Rooms totalling 308 sq ft (28.61 sq m), Kitchen, WC.

GENERAL INFORMATION

TERM

Internal and Insuring Lease. 5 year term. The landlord may negotiate a shorter lease term subject to a higher rent.

RENT

£700 per calendar month, exclusive of business rates and all other outgoings.

BOND

Maximum of 5 weeks rent equivalent.

RATES

Rateable Value – £5,100

Small business rates relief may be obtainable contact North Yorkshire Council – Tel: 0300 1312131.
www.northyorks.gov.uk

INSURANCE

The incoming tenant will be responsible for the reimbursement of the property insurance premium applicable.

LEGAL COSTS

The legal costs for the preparation of the lease documentation shall be met by the ingoing Tenant.

VIEWING ARRANGEMENTS

By appointment with Norman F. Brown

2 CASTLE HILL

Ground Floor

Approx. 44.3 sq. metres (476.4 sq. feet)

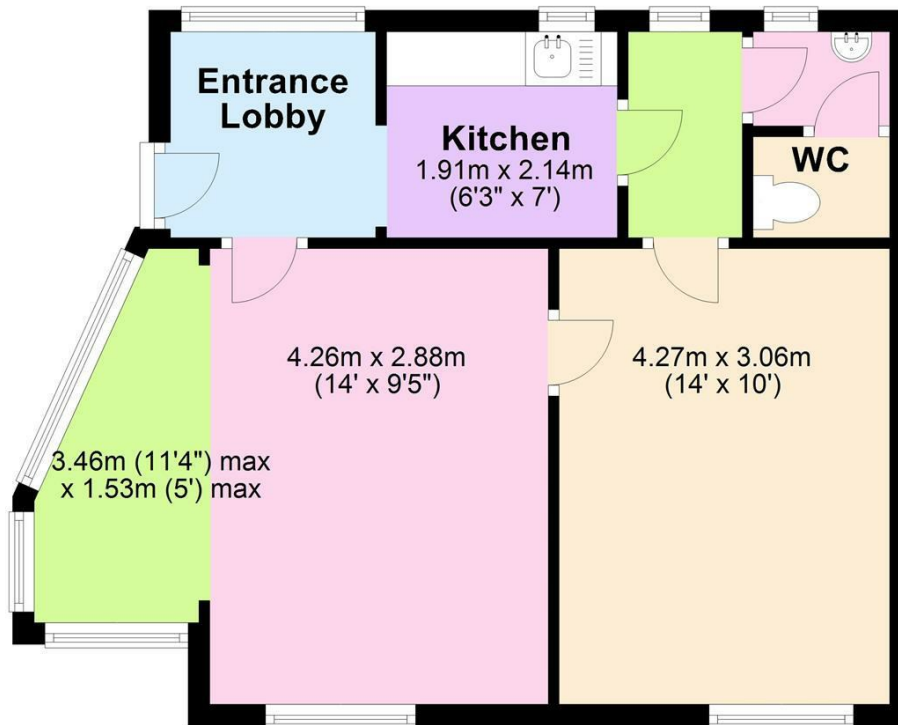

Total area: approx. 44.3 sq. metres (476.4 sq. feet)



Agents Note: Whilst every care has been taken to prepare these particulars, they are for guidance purposes only. All measurements are approximate and are for general guidance purposes only and whilst every care has been taken to ensure their accuracy, they should not be relied upon and potential buyers/tenants are advised to recheck the measurements

Richmond Office Commercial
14 Queens Road
Richmond
North Yorkshire
DL10 4AG

01748 822473
richmond@normanfrown.co.uk
www.normanfrown.co.uk

NORMAN F. BROWN

Est. 1967