



Stonegrove, Edgware, HA8 7TN
£375,000 Leasehold Council Tax Band D

REAL ESTATES
Est.1981

Estate Agents · Residential Sales · Investments · Lettings

****AVAILABLE NOW & CHAIN FREE**** A beautifully appointed two bedroom first floor apartment located on the Stonegrove stretch, within close proximity to Edgware Station, High Street and within Eruv. The property boasts contemporary fixtures & fittings throughout as well as gas central heating and double glazing. In addition this apartment benefits from lift access, garage en block as well as communal gardens. Long Lease. 999 years from 24 September 1984. Chain Free.

Ground Rent: £0

Service Charge: £2,300 per annum (Tbc with solicitors)

Council Tax Band D - £2,163.00 per annum (subject to local authority's website)

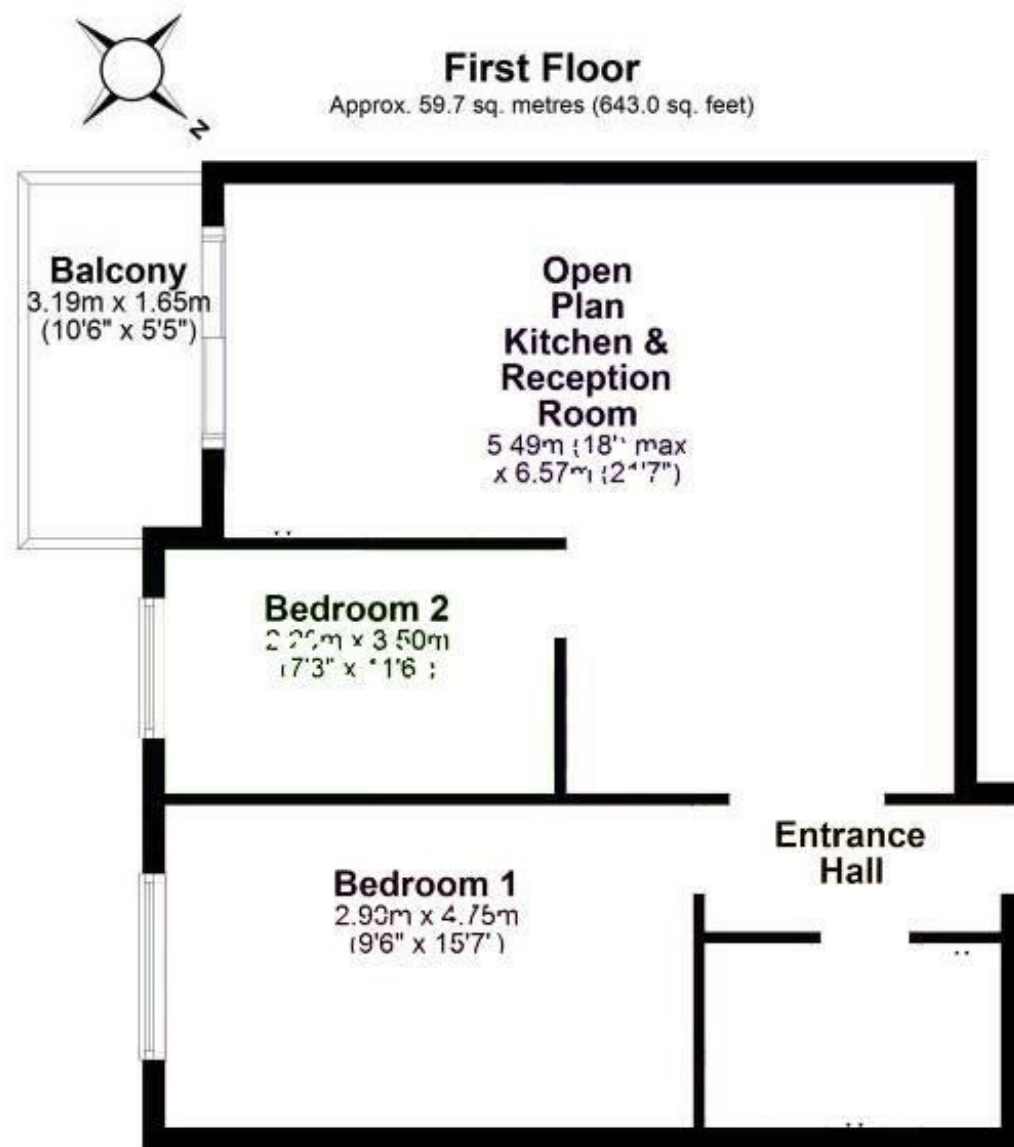
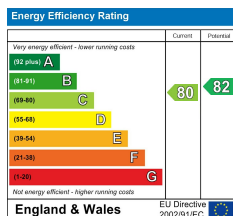

Total area: approx. 59.7 sq. metres (643.0 sq. feet)