



Stonegrove, Edgware, HA8 7SX
£349,950 Leasehold - Share of Freehold Council Tax Band C

REAL ESTATES
Est.1981

Estate Agents · Residential Sales · Investments · Lettings

A beautifully appointed two bedroom, second floor apartment situated on Stonegrove, within close proximity to transport links and amenities.

The property boasts a separate modern kitchen with breakfast bar and a spacious living/dining room with bespoke fitted cabinetry. In addition, the bedrooms benefit from fitted cupboards. Family bathroom and separate WC. Gas Central Heating & Double Glazing. Access from the front and rear of the block. Parking. Communal Gardens. Share of Freehold. Ground Rent: N/A Service Charge: £2,500 per annum

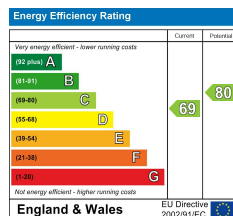

Total Floor Area
61.75m²

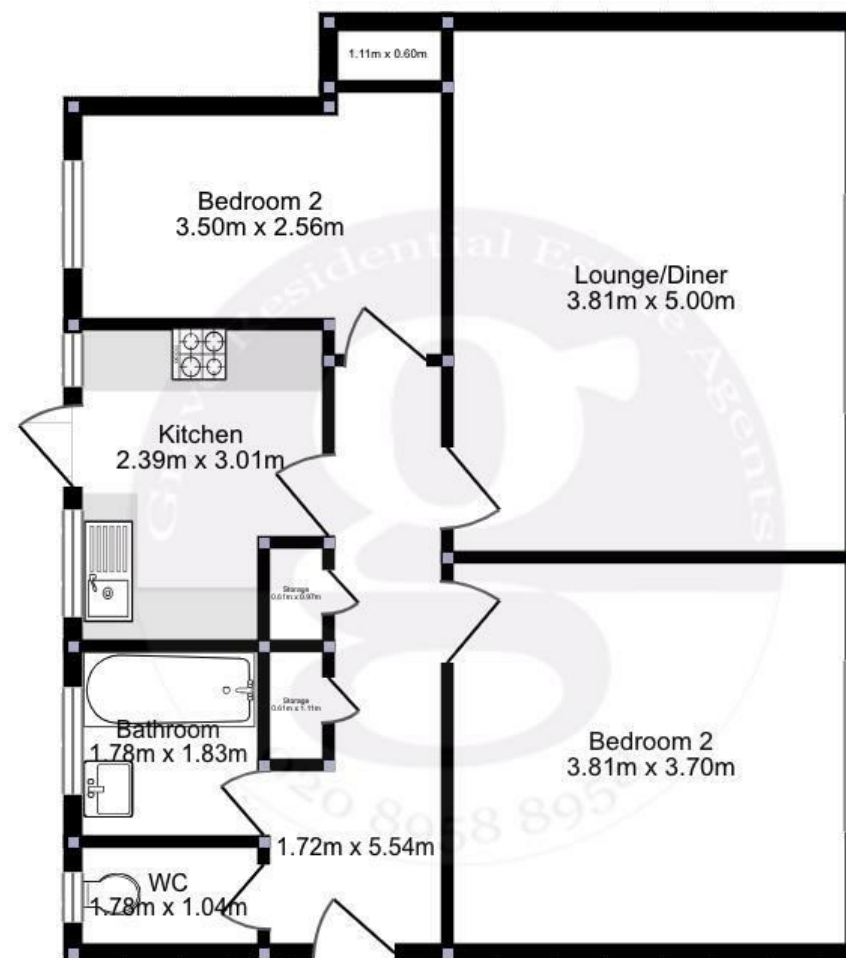

This floorplan has been prepared with all due care and attention, by Grove Residential for the convenience of intending purchasers. Its accuracy is not guaranteed and it does not form any part of a contract. Purchasers should check by inspection its accuracy prior to signing a contract.