



Dudden Hill Lane, London, NW10 1DT
Per Month £2,400 Per Month Council Tax Band

REAL ESTATES
Est.1981

Estate Agents · Residential Sales · Investments · Lettings

Real Estates are excited to present this stunning 2-Bedroom Luxury Apartment with Balcony and access to Gym & Pool.

Located in the vibrant heart of Neasden, this contemporary apartment offers 962 sq. ft. of bright, thoughtfully designed living space. It features two generously sized bedrooms, including a master with an en-suite bathroom, a sleek family bathroom, and an open-plan living area with large windows that flood the space with natural light. The modern kitchen is fully equipped with integrated appliances, including a dishwasher, washer/dryer, and freezer. The private balcony provides a lovely outdoor space to relax and unwind.

Residents enjoy exclusive access to a gym and swimming pool, as well as the added convenience of concierge services and lift access. With Neasden and Dollis Hill stations (Jubilee Line) just a short walk away, this apartment boasts fantastic transport links to Central London.

Oberman Road, London, NW10

Approximate Area = 755 sq ft / 70.1 sq m
For identification only - Not to scale

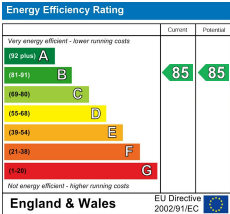
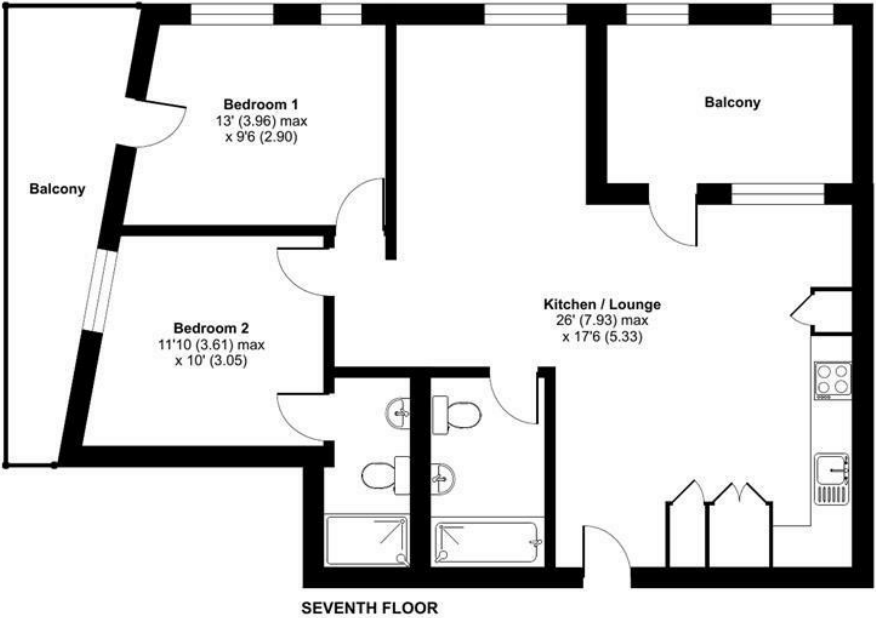

Floor plan produced in accordance with RICS Property Measurement 2nd Edition, Incorporating International Property Measurement Standards (IPMS2 Residential). © richcom 2025. Produced for Real Estates. REF: 1240098