



The Grove, Edgware, HA8 9QB  
£950,000 Freehold      Council Tax Band F

**REAL ESTATES**  
Est. 1981

Estate Agents · Residential Sales · Investments · Lettings



A superb 4 BEDROOM 3 BATHROOM DOUBLE FRONTED semi-detached family home, situated in a popular road within the Eruv.

Arranged over 3 floors, this immaculately maintained home benefits from a solid oak fitted kitchen/breakfast room with Rangemaster cooker, lounge, dining room, under floor heating, approx 60 ft rear garden with side access, guest cloakroom and utility room. Own driveway providing off street parking.









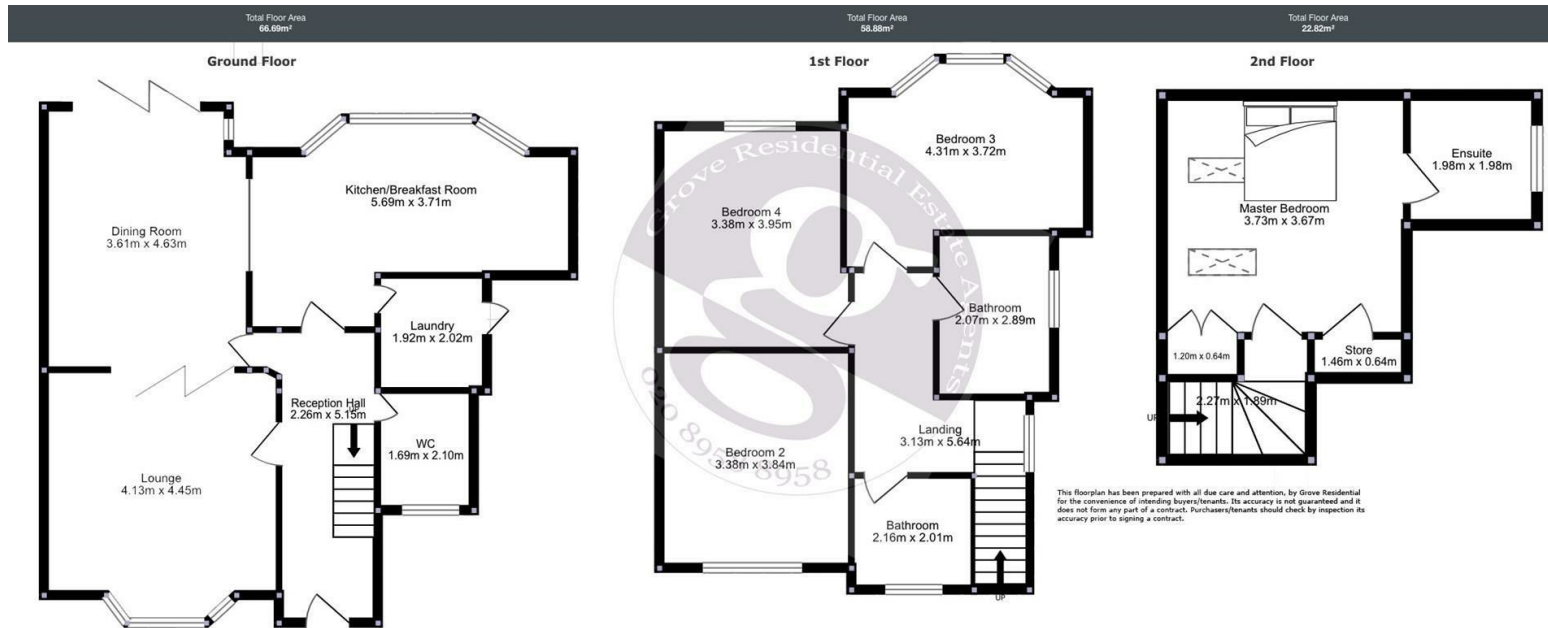

Energy Efficiency Rating		
	Current	Potential
Very energy efficient - lower running costs		
A		
B		
C		
D		
E		
F		
G		
Not energy efficient - higher running costs		
EU Directive		

