



Parsons Crescent, Edgware, HA8 8QG  
Offers In The Region Of £600,000 Freehold

Council Tax Band E

**REAL ESTATES**  
Est.1981

Estate Agents · Residential Sales · Investments · Lettings

**\*CHAIN FREE BUYERS ONLY\*** A 3 BEDROOM SEMI-DETACHED FAMILY HOME situated on the popular Broadfields Estate, within a stone's throw to local shops and transport facilities.

THIS PROPERTY REQUIRES CERTAIN MODERNISATION WHICH IS REFLECTED IN THE ASKING PRICE.

**\* THRU LOUNGE/DINING ROOM \* KITCHEN \* 3 BEDROOMS \* BATHROOM \* REAR GARDEN \* GARAGE \* OWN DRIVEWAY**  
 \*Viewings this Saturday 18th May - please call 020 8445 6387 to arrange an appointment.

NB. The owner of this property is a Partner at Real Estates.

## Parsons Crescent, Edgware, HA8

Approximate Area = 877 sq ft / 81.4 sq m  
 Garage = 141 sq ft / 13 sq m  
 Total = 1018 sq ft / 94.4 sq m  
 For identification only - Not to scale

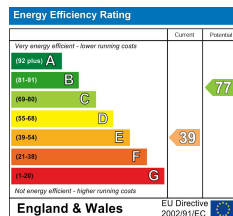
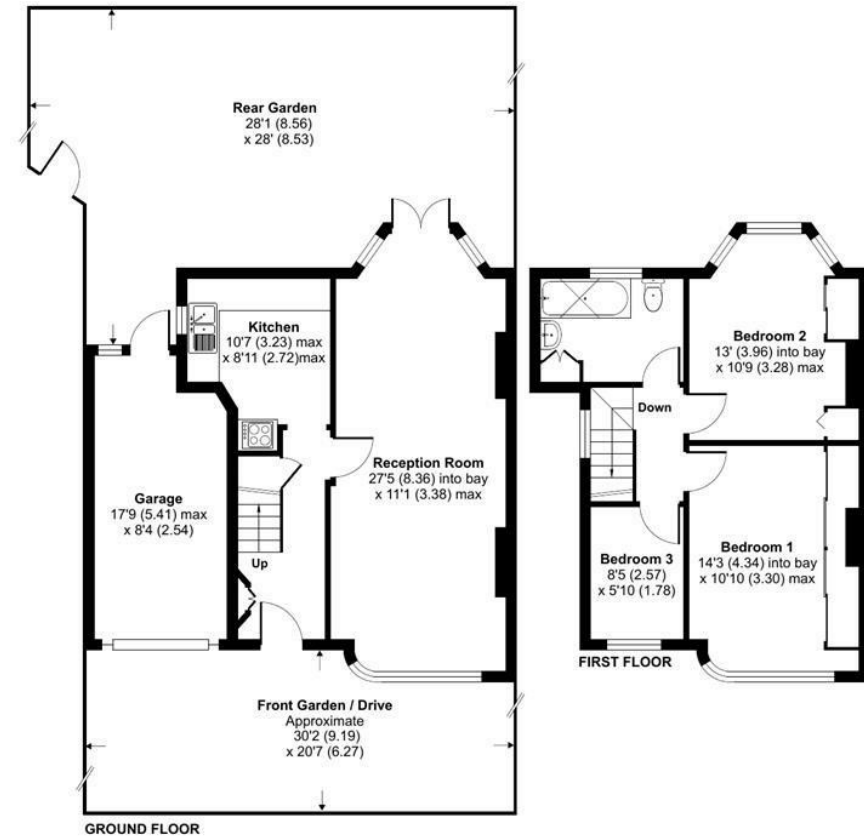

Floor plan produced in accordance with RICS Property Measurement Standards incorporating International Property Measurement Standards (IPMS2 Residential). © nichecom 2024. Produced for Real Estates. REF: 1124709