

**ALLAN FULLER**  
— EST. 1983 —

149 Upper Richmond Road, Putney, London, SW15 2TX

t: 020 8788 8822

e: putney@allanfuller.co.uk

www.allanfuller.co.uk

## Chartfield Avenue London, SW15

**\*\*35% Shared Ownership \*\*** Situated in this modern development a nicely presented one bedroom apartment with private patio, communal gardens, roof terrace and gym. What more could you want!? A concierge perhaps, well it has that too! Accommodation comprises open plan living room with modern fitted kitchen, double bedroom and bathroom.

Avershaw House is conveniently situated just off Putney Hill, which is within easy reach of the amenities of Putney High Street and Putney mainline station as well as East Putney Station. The open space of Putney Heath is just a short walk away.

EPC- C Wandsworth Council Tax Band E



**Asking Price £148,750**  
**Leasehold**



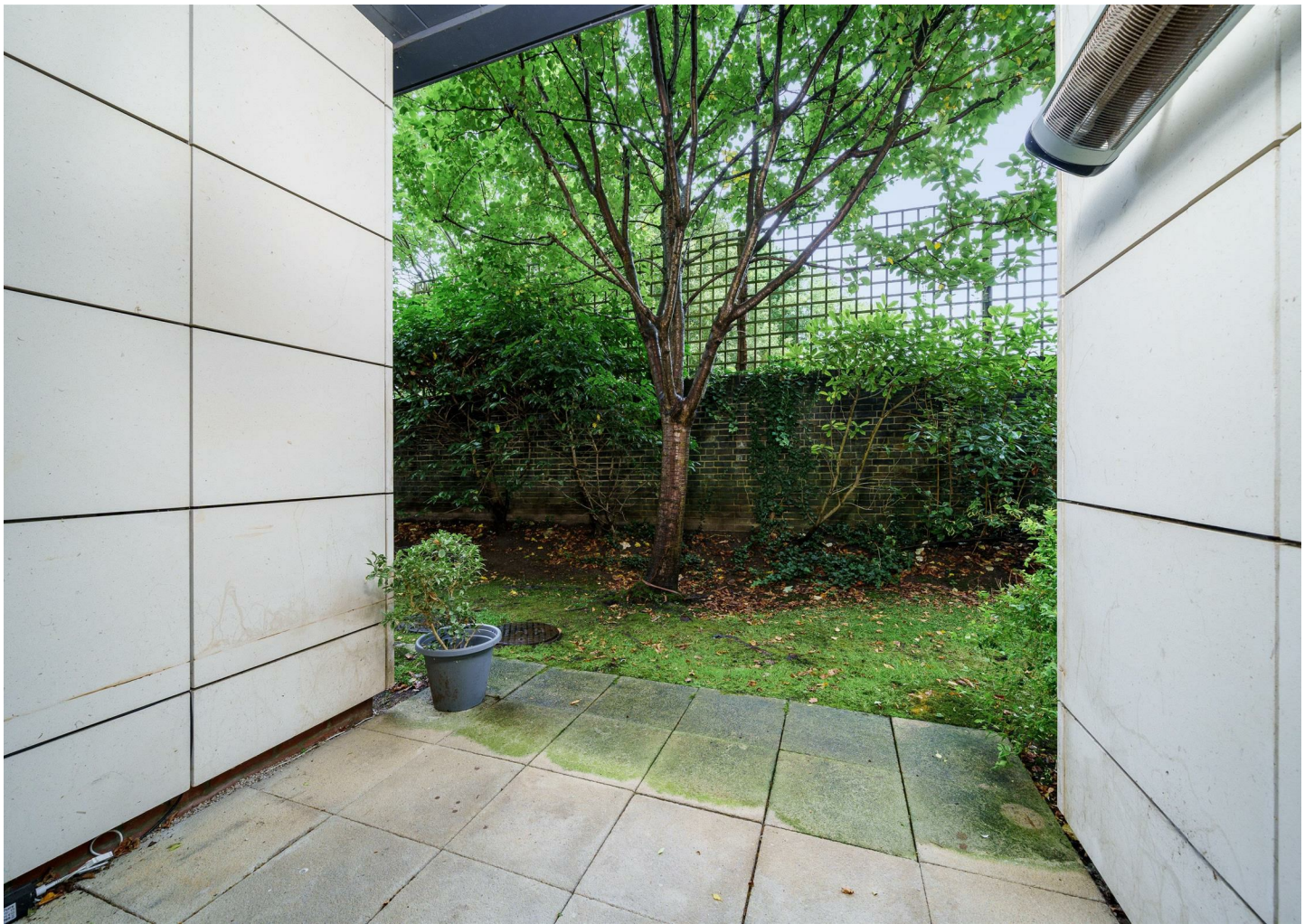

# Avershaw House, Chartfield Avenue, SW15

Approximate Gross Internal Area 51 sq.m / 549 sq.ft

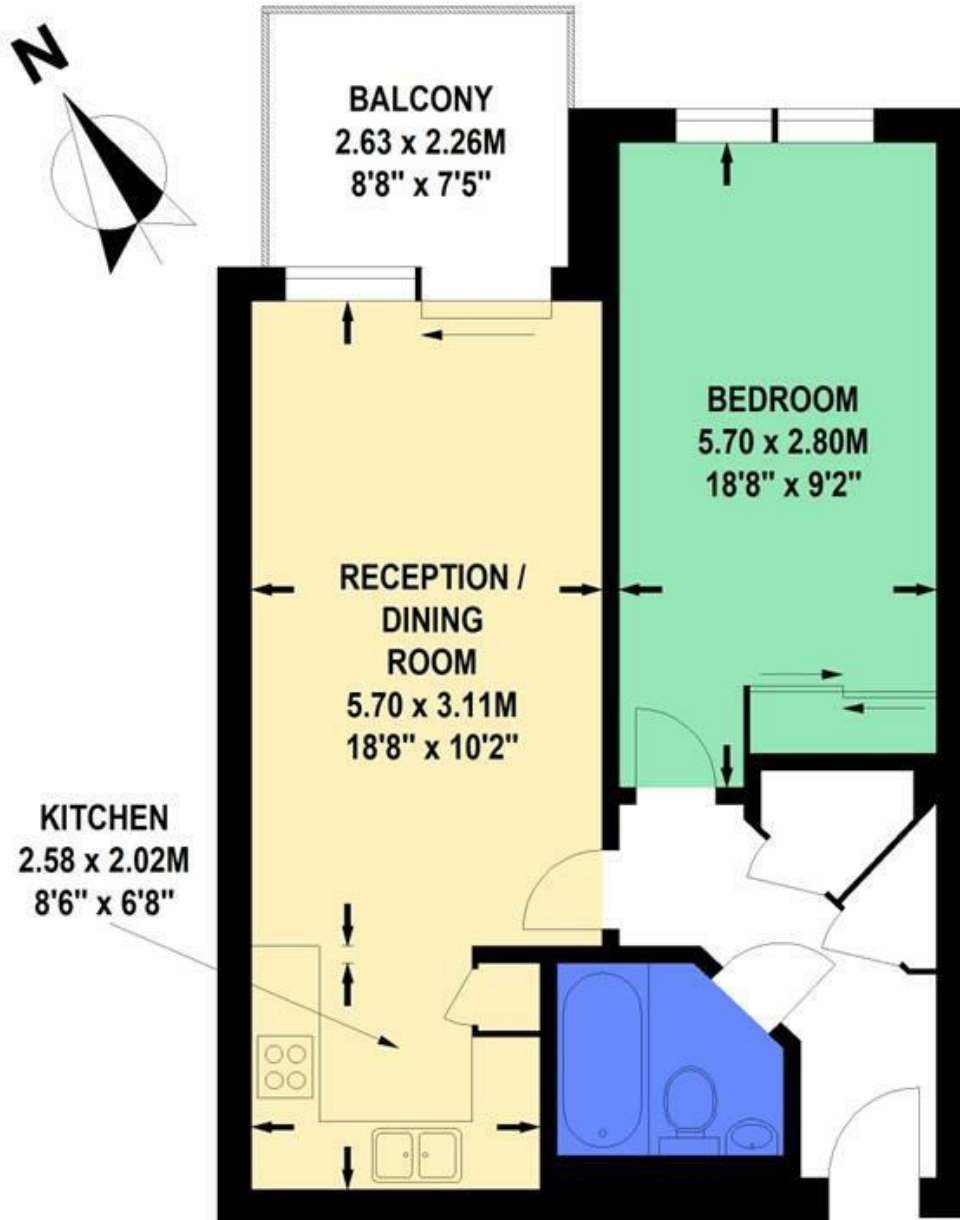

## Lower Ground Floor

Floor Plan produced for Allan Fuller by Mays Floorplans © . Tel 020 3397 4594

Illustration for identification purposes only, not to scale

All measurements are maximum, and include wardrobes and window bays where applicable

With regards to any information supplied by us in relation to lease, ground rent and service charge it is essential that you have this information checked by your solicitor. We have transmitted information supplied to us by the vendor of the property but we have not been able to inspect the lease to check its accuracy. Please note that we have not tested any of the equipment or utilities at this property, nothing in these particulars shall be deemed a statement that the property is in good condition or otherwise nor that any of the services or facilities are in good working order. Measurements are approximate they were taken with a sonic tape, are as accurate as possible and usually measured from the widest point of any room. Description provided herein represents the opinion of the author, is given in good faith but should not be constructed as statements of fact. The particulars and photograph are for guidance only.