



Avenue Road, London, N14 4EN

Asking Price: £350,000
Leasehold

Avenue Road, London, N14 4EN

This CHAIN FREE two bedroom first floor flat located in the popular Grove Close Development in Southgate.

Accommodation comprises, entrance hall, reception room, fitted kitchen, two double bedrooms, bathroom and separate WC. The flat benefits from various storage cupboards, communal gardens and residents parking.

Situated in this highly convenient location within 10 minutes walk of Southgate Tube station and all the shops and restaurants of the local High Road.

- **CHAIN FREE**
- **TWO BEDROOM FIRST FLOOR FLAT**
- **10 MINUTE WALK TO SOUTHGATE UNDERGROUND**
- **RECEPTION ROOM**
- **KITCHEN**
- **DOUBLE BEDROOMS**
- **COMMUNAL GARDENS**
- **RESIDENTS PARKING**
- **CONVENIENT LOCATION**
- **COUNCIL TAX BAND C**



14 Grove Close

Approximate Gross Internal Area = 68.7 sq m 739 sq ft

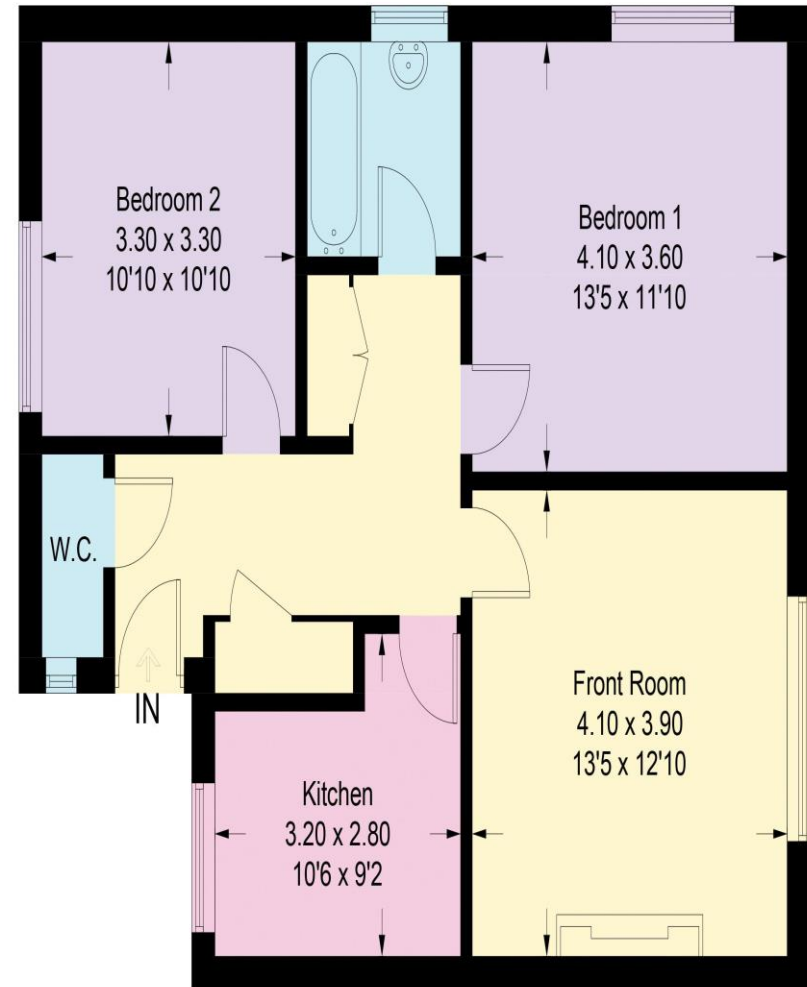

Illustration for identification purposes only, measurements are approximate, not to scale. Fourlabs.co © (ID1228897)





Score	Energy rating	Current	Potential
92+	A		
81-91	B		81 B
69-80	C	73 C	
55-68	D		
39-54	E		
21-38	F		

Disclaimer

The agent has not checked any apparatus, fixtures or fittings or services and cannot verify they are in working order or fit for their purpose. Neither has the agent checked the legal documentation to verify the Freehold / Leasehold status of the property. Photographs are for illustration only and may depict items which are not for sale or included in the sale of the property.

Hunters Whetstone

99 Russell Lane
Whetstone
N20 0BA

T: 020 8368 7138

E: info@hunters-whetstone.co.uk

www.hunters-whetstone.co.uk