



Knox Chase, Harrogate , HG1 3HZ

- Spacious three-bedroom detached bungalow
- Separate kitchen with ample space
- Low-maintenance gardens surrounding the property
- Driveway with off-street parking
- Quiet and sought-after location
- Well-presented and bright throughout
- Generous living room
- Detached garage
- Close to excellent bus links
- Council Tax Band D

Guide Price £350,000



Knox Chase, Harrogate , HG1 3HZ

DESCRIPTION

A spacious and well presented three-bedroom detached bungalow located in a sought-after area of Harrogate, offering comfortable single-level living with excellent access to local amenities and transport links.

This well-maintained home boasts generously proportioned rooms filled with natural light, creating a bright and welcoming atmosphere throughout. The accommodation comprises a large living room, a separate kitchen with ample space for cooking and storage, plus an extra room which could be used as a dining room or configured as required and three good-sized bedrooms, providing versatile space to suit a variety of needs.

The gardens are designed for easy upkeep, featuring a low-maintenance layout that still provides plenty of outdoor space for relaxing, gardening, or entertaining family and friends.

Additional practical features include a detached garage and a driveway, offering convenient off-street parking for multiple vehicles.

Situated close to reliable bus routes and within easy reach of local shops and services, this bungalow combines peaceful residential living with excellent connectivity. It is an ideal choice for families, retirees, or anyone looking for a spacious, well-appointed home in a popular Harrogate location.

Early viewing is highly recommended to fully appreciate the size, quality, and potential this property offers.



EPC

Energy rating D

This property produces 4.8 tonnes of CO₂

Material Information - Harrogate

Tenure Type: Freehold

Council Tax Banding: D



4, Knox Chase, Harrogate, HG1 3HZ, GB

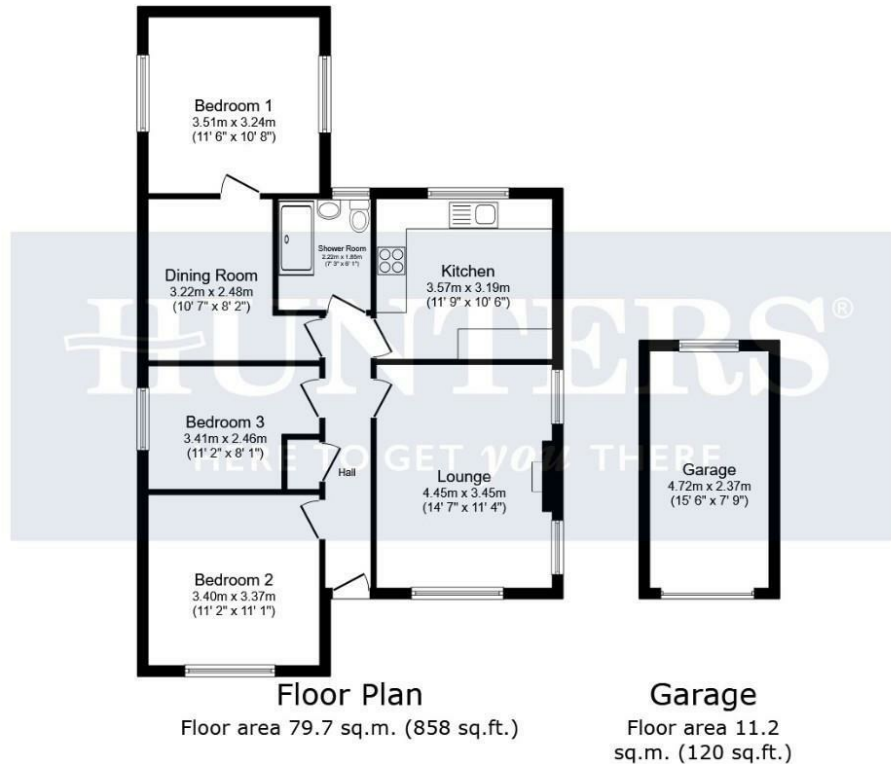

Total floor area: 90.9 sq.m. (978 sq.ft.)

This floor plan is for illustrative purposes only. It is not drawn to scale. Any measurements, floor areas (including any total floor area), openings and orientations are approximate. No details are guaranteed, they cannot be relied upon for any purpose and do not form any part of any agreement. No liability is taken for any error, omission or misstatement. A party must rely upon its own inspection(s). Powered by www.Propertybox.io



Viewings

Please contact harrogate@hunters.com, if you wish to arrange a viewing appointment for this property or require further information.

Valuations

For a valuation of your property, please email the team with your property details, contact information and the times you are available.

ENERGY PERFORMANCE CERTIFICATE

The energy efficiency rating is a measure of the overall efficacy of a home. The higher the rating the more energy efficient the home is and the lower the fuel bills will be.

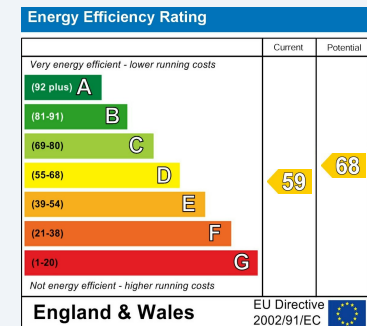

These particulars are intended to give a fair and reliable description of the property but no responsibility for any inaccuracy or error can be accepted and do not constitute an offer or contract. We have not tested any services or appliances (including central heating if fitted) referred to in these particulars and the purchasers are advised to satisfy themselves as to the working order and condition. If a property is unoccupied at any time there may be reconnection charges for any switched off/disconnected or drained services or appliances - All measurements are approximate.

THINKING OF SELLING? If you are thinking of selling your home or just curious to discover the value of your property, Hunters would be pleased to provide free, no obligation sales and marketing advice. Even if your home is outside the area covered by our local offices we can arrange a Market Appraisal through our national network of Hunters estate agents.



Regents House, 13-15 Albert Street, Harrogate, HG1 1JX
Tel: 01423 536222 Email: harrogate@hunters.com <https://www.hunters.com>

