



01932 560777  
[johnsonandjones.co.uk](http://johnsonandjones.co.uk)

**Bourneside Road  
Addlestone, Surrey**

**Johnson & Jones**



# 1 Bourneside Road Addlestone, KT15 2HZ

**Guide Price £410,000**

Johnson & Jones are pleased to present this charming semi-detached house on Bourneside Road, Addlestone! This delightful property boasts a cosy reception room, two lovely bedrooms, and a well-maintained bathroom. With a property size of 795 sq ft and a substantial garden, there is ample space for comfortable living yest still has huge scope for extension (stpp).

Built around the 1930's, this house exudes character and charm, offering a unique feeling that is rare to find. The convenience of parking for multiple vehicles, a detached garage/workshop, and a large paved driveway adds a touch of luxury to this home, making it perfect for car enthusiasts or those in need of extra storage space.

One of the standout features of this property is certainly the garden, with side access providing easy entry to the beautiful outdoor space. Imagine fishing the River Bourne in the morning or hosting a barbecue with friends in this tranquil setting.

Situated close to Wey Navigation offering stunning walks, this house offers the best of both worlds - a peaceful retreat from the hustle and bustle of daily life, yet still conveniently located near local amenities being only a short walk to Addlestone Station & Town Centre. With no onward chain, the path to making this house your home is smooth and hassle-free.

Don't miss out on the opportunity to own this wonderful property in the heart of Addlestone. Book a viewing today and step into your future home!

Tenure: Freehold

Council Tax: Band D



© www.johnsonandjones.co.uk



© www.johnsonandjones.co.uk

Disclaimer: Johnson and Jones Estate Agents cannot verify that the equipment, apparatus, fittings or services within this property are in working order, as they have not tested the relevant items. The buyer is advised to obtain verification from the solicitor dealing with the conveyancing or survey.





© www.johnsonandjones.co.uk Johnson



© www.johnsonandjones.co.uk Johnson



© www.johnsonandjones.co.uk Johnson



© www.johnsonandjones.co.uk Johnson

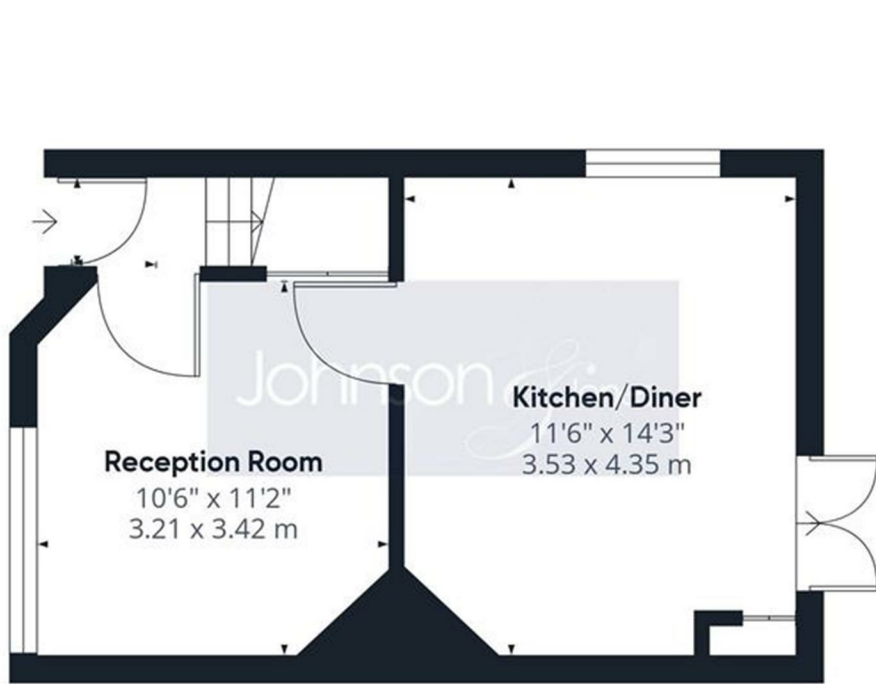

Floor 0 Building 1

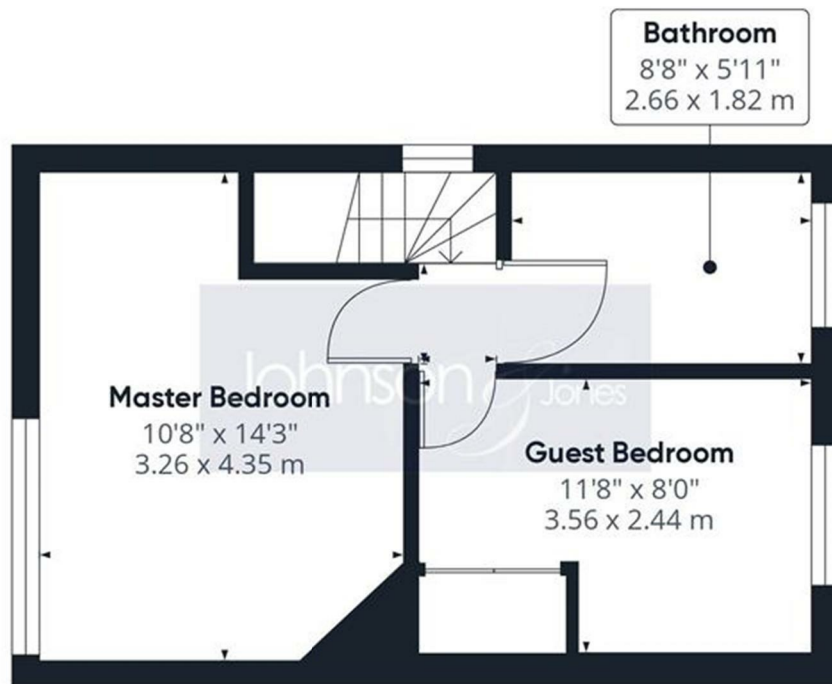

Floor 1 Building 1



Floor 0 Building 2

**Approximate total area<sup>(1)</sup>**  
795.34 ft<sup>2</sup>  
73.89 m<sup>2</sup>

(1) Excluding balconies and terraces

While every attempt has been made to ensure accuracy, all measurements are approximate, not to scale. This floor plan is for illustrative purposes only.





10 London Street. Chertsey  
Surrey. KT16 8AA

Johnson & Jones