

Wrights



49 Rowe Mead
Chippenham SN15 3YJ

Monthly Rental Of £825



Wrights Residential, 24 Fore Street , Trowbridge, BA14 8ER
Phone: 01225 755553, Email: enquiries@wrightsresidential.co.uk
www.wrightsresidential.co.uk

One bedroom house

Gas central heating

Open plan kitchen/living room

Bathroom with shower over the bath

Situated within the popular Pewsham Development

PVCu double glazing

Double bedroom

Driveway parking for two vehicles

This one bedroom house is situated within the popular Pewsham development, on the outskirts of Chippenham. Features include a spacious open plan kitchen/living room, double bedroom, bathroom with electric shower over the bath, gas central heating and PVCu double glazing and driveway parking for two vehicles. Available from late July, unfurnished.

The property comprises

Ground Floor

Open plan kitchen/living room *11' 7" x 18' 2" (3.53m x 5.54m)*

With PVCu front door radiator, a range of eye level and base units, worktops with tiled splash backs, integrated electric oven and hob with extractor hood over, space for fridge and washing machine, stair to the first floor and PVCu double glazed windows to the front.

First Floor

Landing

With radiator and PVCu double glazed window to the side.

Bedroom *11' 7" x 12' 2" (3.53m x 3.72m)*

With radiator, cupboard housing gas boiler and PVCu double glazed window to the front.

Bathroom

With suite comprising bath with electric shower over, pedestal hand basin and low level W.C, radiator and PVCu double glazed window.

Off road parking

Driveway parking for two vehicles to the front of the property.

Council tax

The property is in council tax band B.

Services

Mains gas, electricity, water and drainage are connected. The property is heated by a gas fired central heating boiler to radiators. Please note that the Agent has not tested any appliances.

Broadband

Ultrafast broadband is available (source - Ofcom)
Predicted maximum download speed - 10000Mbps

Mobile phone coverage

Outdoor coverage is likely - source Ofcom.



Ground Floor

Approx. 19.6 sq. metres (210.5 sq. feet)

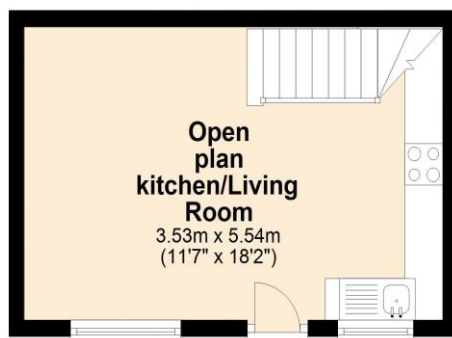

First Floor

Approx. 19.6 sq. metres (210.5 sq. feet)



Total area: approx. 39.1 sq. metres (421.0 sq. feet)