

Wrights



33 Hill Street Court Hill Street
Trowbridge BA14 8LB

Monthly Rental Of £875



Wrights Residential, 24 Fore Street, Trowbridge, BA14 8ER
Phone: 01225 755553, Email: enquiries@wrightsresidential.co.uk
www.wrightsresidential.co.uk

Two bedroom top floor apartment

Gas central heating

White goods

Shared courtyard area

Within walking distance of the town centre and railway station

PVCu double glazing

One allocated parking space

Unfurnished

This two bedroom top floor apartment is situated within walking distance of the town centre and railway station. Features include gas central heating, PVCu double glazing, white goods, shared courtyard area and parking for one vehicle. Available mid June, unfurnished.

The property comprises

Entrance Hall

With wood laminate flooring and velux window.

Lounge/Kitchen *13' 11" x 16' 9" (4.23m x 5.10m)*

With wood laminate flooring, double panel radiator, a range of wall/eye level units, rolled worktops with tiled splashbacks, sink/drain, integrated oven/hob with extractor hood over, Freestanding washing machine and fridge/freezer, double panel radiator and two velux windows.

Bedroom 1 *10' 2" x 8' 1" (3.09m x 2.47m)*

With wood laminate flooring, double panel radiator and velux window.

Bedroom 2 *10' 2" x 7' 7" (3.09m x 2.32m)*

With wood laminate flooring, double panel radiator and velux window.

Bathroom

With wood laminate flooring, white suite comprising bath with shower attachment, pedestal hand basin, low level w.c, double panel radiator and velux window.

Externally

The property benefits from a shared courtyard area and off road parking for one vehicle.

Council Tax

The property is currently a Council tax B.

Services

Mains electricity, water and drainage are connected. Please note that the Agent has not tested any appliances.

Broadband

Superfast broadband is available (source - Ofcom)
Predicted maximum download speed - 80Mbps

Mobile Phone Coverage

Outdoor coverage is likely - source Ofcom.



Ground Floor

Approx. 48.6 sq. metres (522.9 sq. feet)

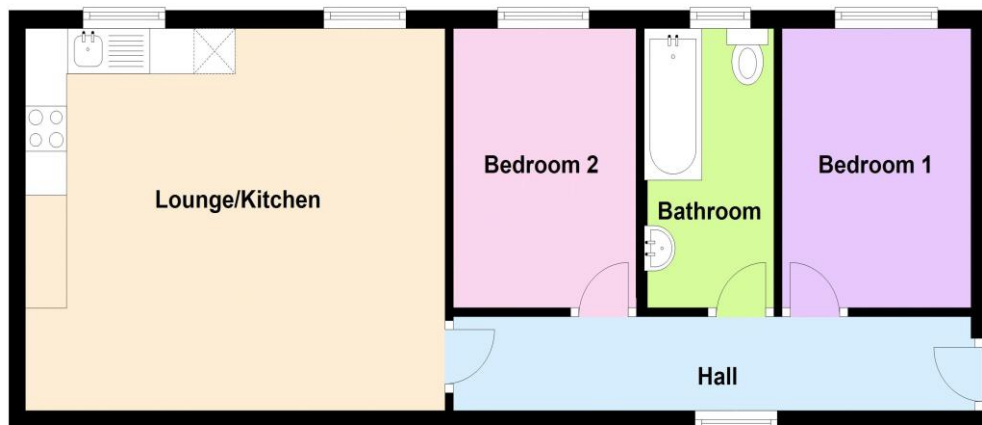

Total area: approx. 48.6 sq. metres (522.9 sq. feet)