

Wrights



58 Kingfisher Drive
Westbury BA13 3XN

Monthly Rental Of £875



Wrights Residential, 24 Fore Street , Trowbridge, BA14 8ER
Phone: 01225 755553, Email: enquiries@wrightsresidential.co.uk
www.wrightsresidential.co.uk

Two bedroom end of terrace property

Gas central heating

Enclosed rear garden

Unfurnished

Cul de sac location

PVCu double glazing

Off road parking for two vehicles

Available immediately

This two bedroom end of terrace property is situated within a popular cul-de-sac on the outskirts of Westbury. Features include gas central heating with a new boiler, PVCu double glazing, a low maintenance enclosed rear garden and allocated parking for two vehicles. Available immediately, unfurnished.

The property comprises

Ground Floor

Entrance Hall

With wood laminate flooring and radiator.

Kitchen *6' 11" x 8' 11" (2.12m x 2.72m)*

With wood laminate flooring, a range of eye level and base units, worktops with upstands, electric cooker with double oven, ceramic hob and extractor hood over, one and a half bowl sink/drainage unit, space for fridge/freezer and washing machine, radiator, wall mounted gas boiler and PVCu double glazed window to the front.

First Floor

Landing

With linen cupboard and PVCu double glazed window to the side.

Bedroom 1 *11' 5" x 9' 7" (3.47m x 2.91m)*

With radiator and PVCu double glazed window to the rear.

Bedroom 2 *11' 9" x 6' 2" (3.57m x 1.89m)*

With radiator and PVCu double glazed window to the front.

Bathroom

With wood laminate white suite comprising bath with shower attachment over, close coupled W.C and pedestal hand basin, radiator, extractor fan and obscured PVCu double glazed window to the front.

Externally

To the front

Allocated parking for two vehicles.

To the rear

The enclosed rear garden is mainly laid to gravel with a patio seating area.

Council tax

The property is currently in council tax band B.

Services

Mains gas, electricity, water and drainage are connected. The property is heated by a gas fired central heating boiler to radiators. Please note that the Agent has not tested any appliances.

Broadband

Ultrafast broadband is available (source - Ofcom)
Predicted maximum download speed - 1000Mbps

Mobile phone coverage

Outdoor coverage is likely - source Ofcom.



Ground Floor

Approx. 27.4 sq. metres (294.7 sq. feet)

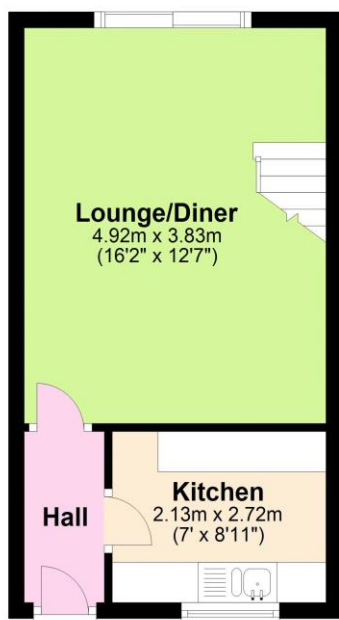

First Floor

Approx. 27.4 sq. metres (294.7 sq. feet)



Total area: approx. 54.8 sq. metres (589.4 sq. feet)