

Willow Barn Ebbs Lane, Wantage, OX12 0HL  
£1,100,000

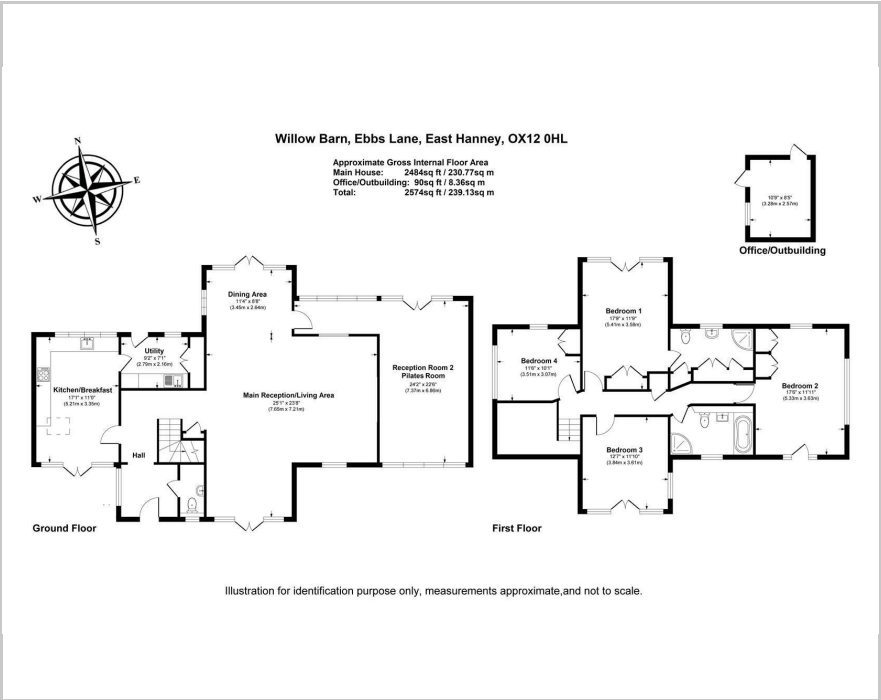



Floor Plan



Area Map



These particulars, whilst believed to be accurate are set out as a general outline only for guidance and do not constitute any part of an offer or contract. Intending purchasers should not rely on them as statements of representation of fact, but must satisfy themselves by inspection or otherwise as to their accuracy. No person in this firm's employment has the authority to make or give any representation or warranty in respect of the property.

216 Banbury Road, Oxford, OX2 7BY  
Tel: 01865 510000 Email: [oxford@west-tpc.co.uk](mailto:oxford@west-tpc.co.uk) <https://www.west-tpc.co.uk>

SET IN c0.33 ACRE AND BACKING ONTO FARMLAND, THIS STUNNING 4 BEDROOM DETACHED CONVERTED BARN ENJOYS RURAL PEACE AND TRANQUILITY AT THE END OF A QUIET LANE ON THE EDGE OF THIS DESIRABLE VILLAGE

NO ONWARD CHAIN

Accommodation

- Handsome Family Home filled with natural light
- 4 Well proportioned bedrooms and 2 bathrooms
- Peaceful setting on the edge of the village at the end of a quiet lane
- Magnificent Reception Rooms
- Sun Filled Kitchen/Breakfast Room
- Standing in c0.34 Acre backing onto fields
- Gas Fired Central Heating (underfloor on the ground floor)
- Original features tastefully incorporated into the fabric
- A spectacular home in a fabulous setting
- A desirable village well placed for Didcot rail, A34, Oxford, Abingdon & Wantage

DIRECTIONS: If approaching East Hanney from Oxford/Abingdon on the A338 take the first turning into the village, on your right, Ashfield Lane. After about 200 metres turn right into Ebbs Lane. Willow Barn will be found at the end of the lane on your right hand side after about 265 metres.  
What3words: ///firming.civic.infants



Energy Efficiency Rating		Current	Potential
How energy efficient is your building? - based on rating scale			
100-120	A		
80-100	B		
60-80	C	72	81
40-60	D		
20-40	E		
1-20	F		
1-10	G		
How energy efficient is your building? - based on rating scale			
England & Wales			
EU Directive 2002/91/EC			