

west
THE PROPERTY CONSULTANCY



Church Farm
Cottage



TO LET

Church Farm Cottage, First Turn, Wolvercote, Oxford, OX2 8AH

£1,795

- Atmospheric setting in the grounds of a period farmhouse
- Sitting room opening on to a private terrace
- Bathroom with walk in shower
- Parking for 2 cars
- A walk away from beautiful Port Meadow
- Social Kitchen/dining space
- Two double bedrooms
- Cloakroom / utility area
- Walled garden terrace
- Popular Summertown very close at hand

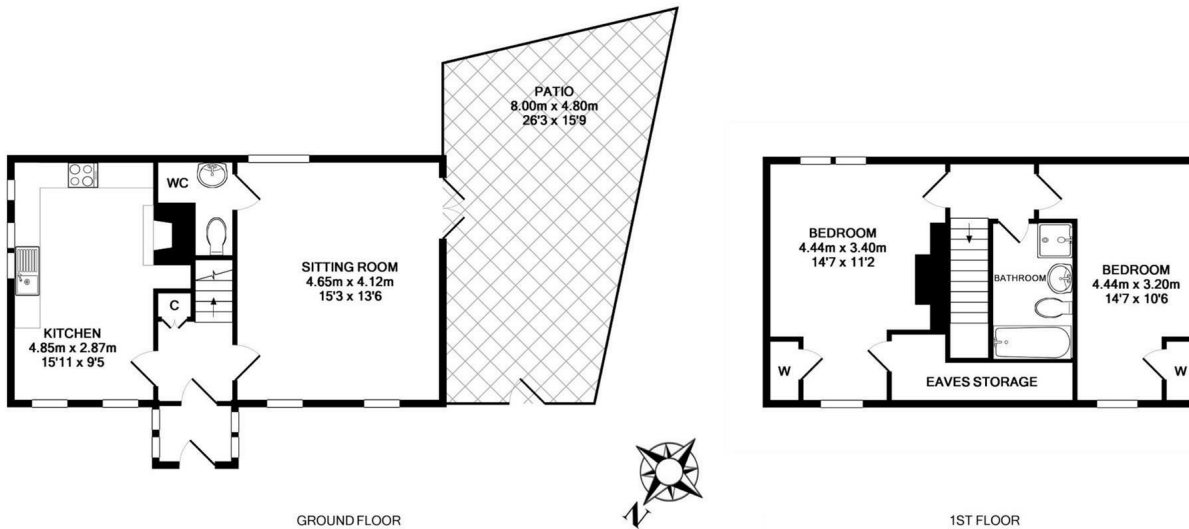

GROUND FLOOR

1ST FLOOR

TOTAL APPROX. FLOOR AREA 83.9 SQ.M. (903 SQ.FT.)

These measurements are the maximum & are approximate only, they do not take into account minimum measurements. Drawn by E8 Property Services - www.e8ps.co.uk
Made with Metropix ©2014

THE PROPERTY

WOLVERCOTE

Oxford City Centre c.2.7 miles - Summertown c.1.25 miles.
Oxford Parkway Station c.0.7 miles

Set in the atmospheric grounds of a period farm house, a restored cottage in a peaceful courtyard setting. It has a 'social' kitchen / dining space and a tranquil sitting room with french windows opening on to a south facing, private walled terrace. There is a downstairs cloakroom and laundry room, with a tumble drier and washing machine. On the 1st floor there are two double bedrooms, served by a modern bathroom with a bath and a walk in shower. A special property within a walk of the wonderful Port Meadow and with popular Summertown nearby (TOTAL FLOOR AREA: c.903 / 84 m2)

QUOTING RENT: £1,795pcm

DIRECTIONS: If travelling north on Woodstock Road, the A4144 (away from the city) take the last left before the Woodstock Road roundabout, into 'First Turn' about 100m before the roundabout. The driveway to Church Farm Cottage will then be found on your left after about 290m. What3words:///transfers.rally.plant



216 Banbury Road, Oxfordshire, OX2 7BY

Tel: 01865 510000 Email: oxford@west-tpc.co.uk <https://www.west-tpc.co.uk>

Contact: Gavin West

(t) 01865 510000 (e) gavin@west-tpc.co.uk