

west
THE PROPERTY CONSULTANCY



TO LET



The Ashes Sunningwell, Abingdon On Thames, Oxfordshire, OX13 6RD

£2,350 PCM

- Picturesque Rural Village
- Quick access to Oxford
- 3/4 Bedrooms
- Private 'Cottage' Garden
- 'The Barn' popular village farm shop and cafe
- Quick access to Abingdon on Thames
- An individual detached house in a discreet setting
- 2 Bath/Shower Rooms
- On the periphery of the village cricket Pitch

SUNNINGWELL
 Oxford c.6.9 miles Abingdon on Thames c.2.7 miles Radley Station c. 2.3 miles

Set on the edge of the village cricket club ground, an individual detached house offering a high degree of privacy within an attractive setting. 2/3 Reception rooms. 3/4 Bedrooms. 2 Bath / Shower rooms. Contemporary kitchen. Driveway with ample parking facilities. Private cottage gardens. Good 'gastro' pub and farm shop in the village. Waitrose c.3 miles in nearby Abingdon on Thames. (TOTAL FLOOR AREA: 1492 sq ft / 139 m2)

QUOTING RENT: £2,350pcm

THE PROPERTY

An individual detached village house on the periphery of the cricket club in picturesque Sunningwell.

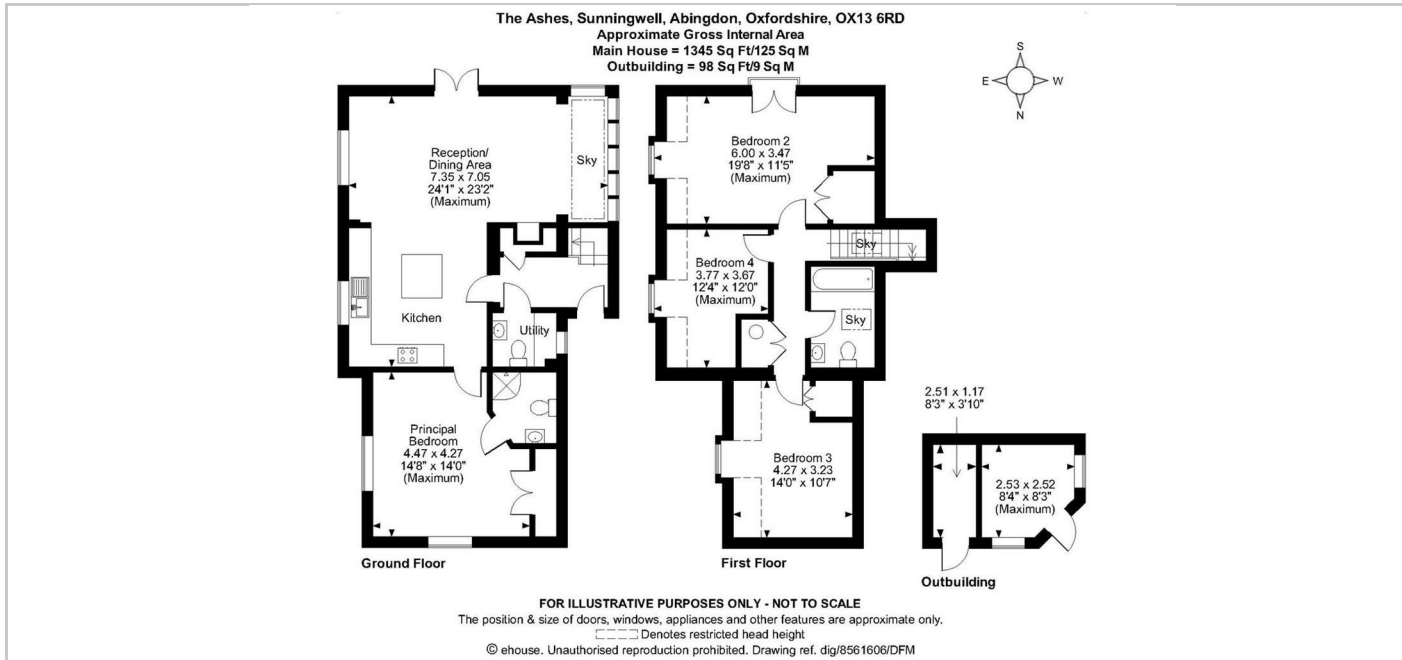

SITUATION

Contact: Gavin West
 (t) 01865 510000 (e) gavin@west-tpc.co.uk

Directions

What3words:///appear.float.treat