

COMING SOON

TO LET



Church Farm Cottage, First Turn, Wolvercote, Oxford, OX2 8AH

£1,795

- Atmospheric setting in the grounds of a period farmhouse
- Sitting room opening on to a private terrace
- Bathroom with walk in shower
- Parking for 2 cars
- A walk away from beautiful Port Meadow
- Social Kitchen/dining space
- Two double bedrooms
- Cloakroom / utility area
- Walled garden terrace
- Popular Summertown very close at hand

WOLVERCOTE

Oxford City Centre c.2.7 miles - Summertown c.1.25 miles. Oxford Parkway Station c.0.7 miles

Set in the atmospheric grounds of a period farm house, a restored cottage in a peaceful courtyard setting. It has a 'social' kitchen / dining space and a tranquil sitting room with french windows opening on to a south facing, private walled terrace. There is a downstairs cloakroom and laundry room, with a tumble drier and washing machine. On the 1st floor there are two double bedrooms, served by a modern bathroom with a bath and a walk in shower. A special property within a walk of the wonderful Port Meadow and with popular Summertown nearby (TOTAL FLOOR AREA: c.903 / 84 m2)

QUOTING RENT: £1,795pcm

THE PROPERTY

A period former farm cottage in a peaceful courtyard setting close to the ancient Port Meadow.

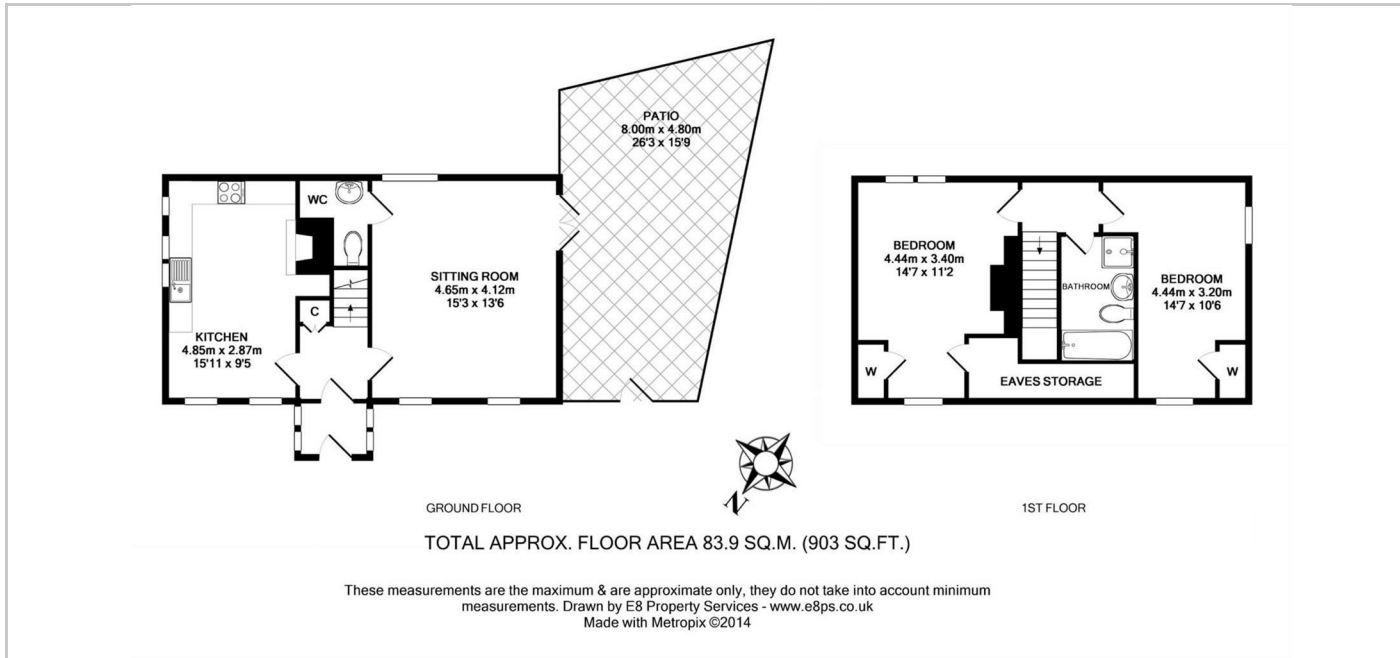

SITUATION

Contact: Gavin West
(t) 01865 510000 (e) gavin@west-tpc.co.uk

Directions

SAT NAV (OX2 9AH)

216 Banbury Road, Oxfordshire, OX2 7BY
Tel: 01865 510000 Email: oxford@west-tpc.co.uk <https://www.west-tpc.co.uk>