



TO LET

Flat 2 Davenant Court, 16 Davenant Road, Oxford, OX2 8BX

£1,995 PCM

THE PROPERTY

Davenant Court, Flat 2, 16, Davenant Road, Oxford, OX2 8BX
Approximate Gross Internal Area
821 Sq Ft/76 Sq M

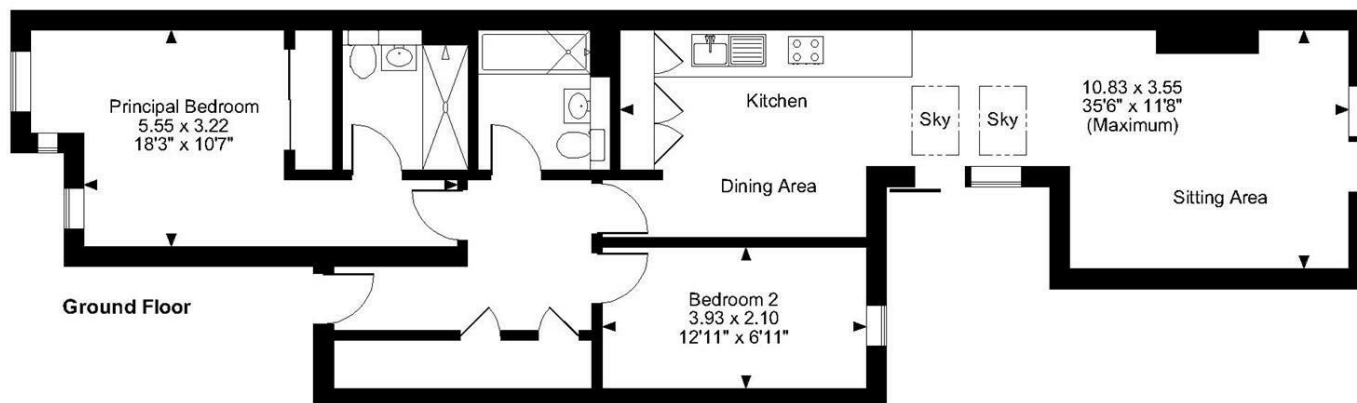
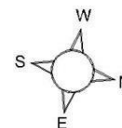

Ground Floor

FOR ILLUSTRATIVE PURPOSES ONLY - NOT TO SCALE

The position & size of doors, windows, appliances and other features are approximate only.

© ehouse. Unauthorised reproduction prohibited. Drawing ref. dig/8555192/DMS

- Contemporary 'Garden Flat'
- Private terrace & communal gardens
- Striking vaulted 'social space'
- 2 Bedrooms
- Immediately Available
- A walk to Summertown Flat'
- Short distance from Oxford Parkway Stn
- Contemporary kitchen space'
- 2 Contemporary Bath / Shower Rooms
- Restaurants and coffee shops close by

NORTH OXFORD

City Centre c. 2.2 miles Oxford Parkway Station
Oxford Parkway Station c. 1.3 miles

Peacefully located in a much coveted tree lined North Oxford address, a contemporary 'Garden Flat' set within a small exclusive apartment building. Featuring a striking open vaulted 'social' space with a fully integrated contemporary kitchen. The apartment opens on to its own private terrace. 2 Bedrooms. 2 Bath / Shower rooms. A walk away from the shops, coffee houses and restaurants of Summertown. Immediately available. A first class Oxford location only 1.3 miles from Oxford Parkway Station (London Marylebone Station c.48 minutes) (TOTAL FLOOR AREA: c.821sq ft / 76 m2)

Council Tax Band C

Contact: Gavin West
(t) 01865 510000
(m) 07789 655100
(e) gavin@west-tpc.co.uk

Directions

From Summertown proceed north along the Banbury Road towards the Summertown roundabout and take the last turning left before the roundabout in to Davenant Road. Proceed towards the far end of the road and Davenant Court is on your right hand side after about 150 metres. What3words:///table.strict.starts

216 Banbury Road, Oxfordshire, OX2 7BY

Tel: 01865 510000 Email: oxford@west-tpc.co.uk <https://www.west-tpc.co.uk>