

west

THE PROPERTY CONSULTANCY



6 Smith Court, Wallingford, OX10 9FY  
£1,350





## Floor Plan

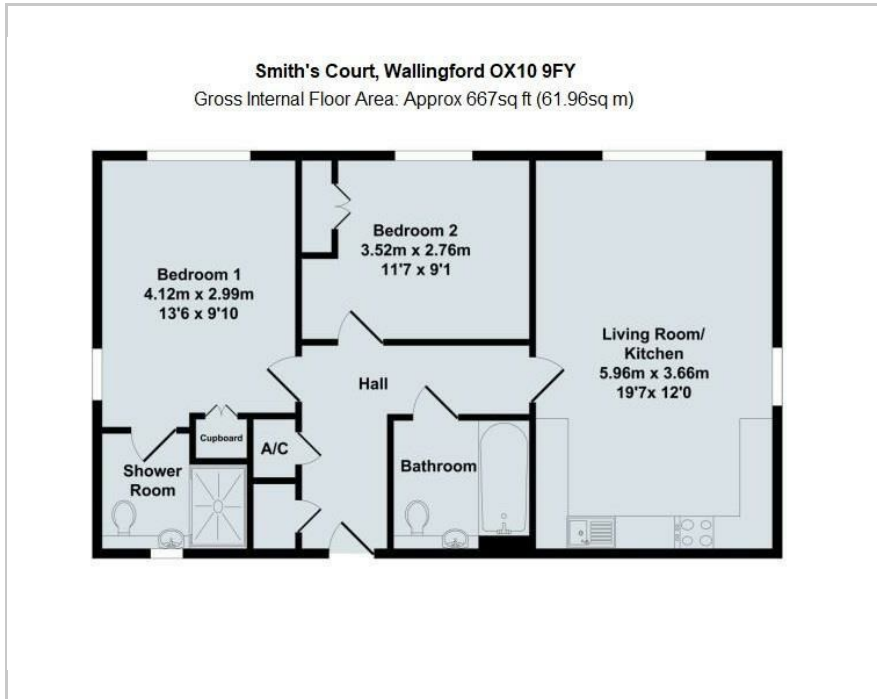

## Area Map



## Accommodation

- Top Floor Flat with great natural light
- 2 bedrooms, Bathroom & En-Suite Shower Room
- Well Equipped Kitchen - washer/dryer, dishwasher, fridge freezer, oven & hob
- Spacious Double Aspect Sitting Room
- Generous Double Aspect Master Bedroom
- Gas Central Heating
- Double Glazing
- Allocated Parking Space
- Communal Garden and Bike Store
- Available 24th April 2024

## Viewing

Please contact our Oxford Lettings Office on 01865 510000 if you wish to arrange a viewing appointment for this property or require further information.

## Energy Efficiency Graph

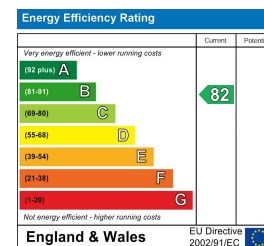

These particulars, whilst believed to be accurate are set out as a general outline only for guidance and do not constitute any part of an offer or contract. Intending purchasers should not rely on them as statements of representation of fact, but must satisfy themselves by inspection or otherwise as to their accuracy. No person in this firm's employment has the authority to make or give any representation or warranty in respect of the property.

216 Banbury Road, Oxfordshire, OX2 7BY

Tel: 01865 510000 Email: oxford@west-tpc.co.uk <https://www.west-tpc.co.uk>