

west
THE PROPERTY CONSULTANCY



TO LET

1, Grassland Close, Curbridge, Witney, Oxfordshire, OX29 0AL

£2,300 PCM

- Brand new four bedroom, detached home
- Stunningly presented
- Parking for 3 cars, plus single garage
- 4 bedroom, 2 bathrooms

CURBRIDGE, WITNEY
 Witney Lakes Resort 0.5 miles, Witney c. 2.5 miles, Long adjacent Station c. 10.5 miles Oxford City Centre c. 15 miles

A four bedroom detached home, adjacent to Witney Lakes Resort. The property offers; entrance hall, cloakroom, dual aspect living room, kitchen diner leading out to the private, walled garden. On the first floor are four spacious bedrooms, one ensuite bathroom together with a further family bathroom.

TOTAL FLOOR AREA: 1,512 sq. Ft.

Available 26/04/2024 for a long term rental.

THE PROPERTY

An opportunity not to be missed!
 A stunning 4 bedroom detached home with garage, parking for 3 cars and private garden.

3D VIRTUAL WALKTHROUGH TOUR AVAILABLE

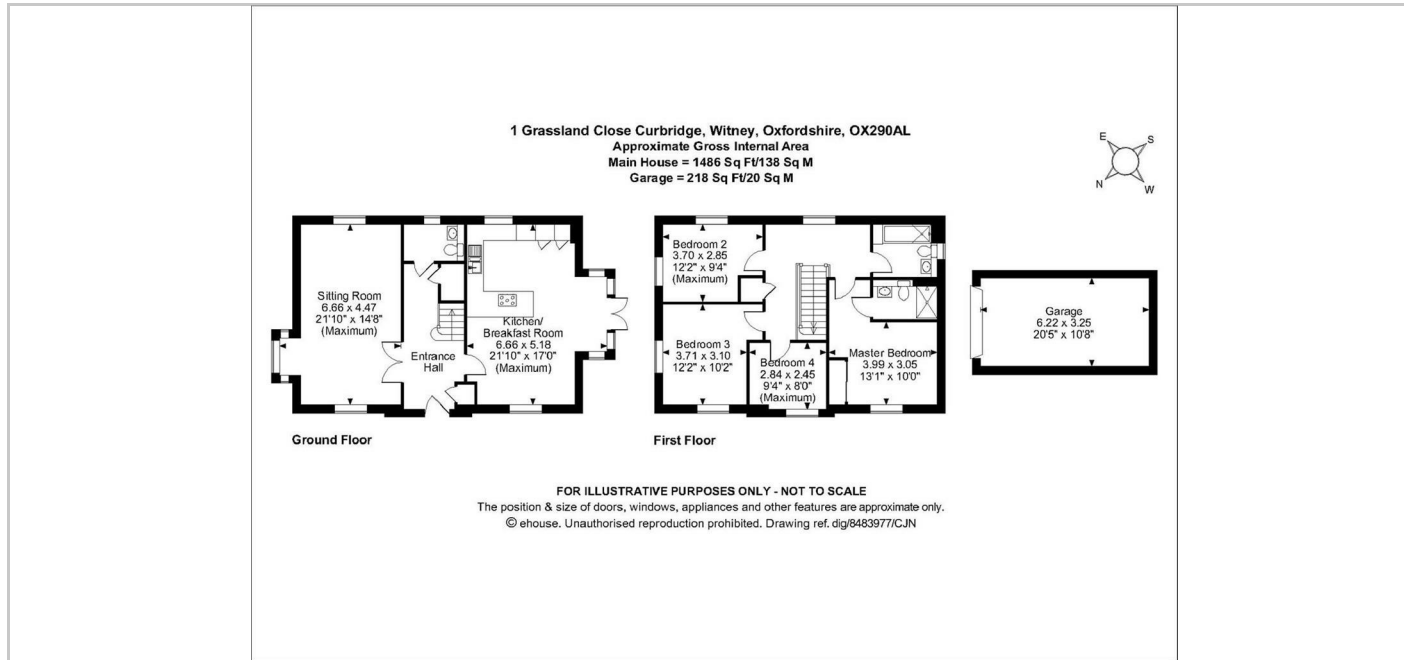

SITUATION

Contact: Sam Waddington
 (t) 01865 510000 (e) sam@west-tpc.co.uk

A holding deposit of 1 weeks rent will apply and be taken when making an application to secure a tenancy through WEST-The Property Consultancy. Please contact the office for further details if required.

Directions

From Oxford, take the A40 westwards and at the Curbridge roundabout for Witney Lakes (after approximately 10 miles) turn right, signed to Witney Lakes Resort. Proceed straight over the roundabout onto Downs Road, and after circa 0.5 miles, turn left into Wheatfield Drive. Follow this road until you see Grassland Close on the left hand side, and no. 1 will be found on the corner on the left hand side.