

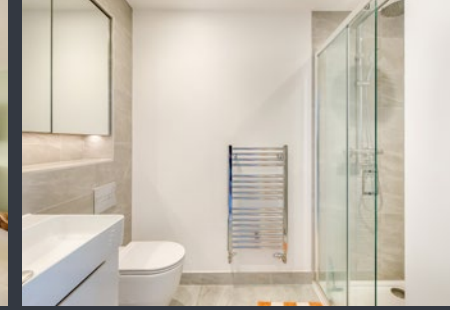

WILLSTAN HOUSE
SOUTHMOOR, OXFORDSHIRE





STYLISH AND CONTEMPORARY FAMILY LIVING

Sitting in an enclave of substantial homes within this prestigious development on the edge of Southmoor, Willstan House, constructed in 2019 by Hayfield Homes, offers spacious living accommodation over two floors. 5 well-appointed bedrooms with 3 bathrooms occupy the first floor, and on the ground floor, large dual aspect living room, downstairs cloakroom, and snug/dining room are all accessed off the generous entrance hall, together with the kitchen/dining space which opens out onto the private, west facing garden. Double garage and parking for four cars.

DIRECTIONS: From Oxford, take the A420 Swindon Road to Kingston Bagpuize and at the Abingdon / Witney roundabout, take the first exit. At the mini-roundabout, turn right onto the Faringdon Road, and follow this for approximately 1 mile, turn left into Walker Lane. Follow the road and you will see Willstan House straight ahead of you, on the corner of Jenkins Way.

TOTAL FLOOR AREA: 2,308 Sq Ft / 215 Sq M

6 Walker Lane, Southmoor, Abingdon, Oxfordshire, OX13 5NH

Approximate Gross Internal Area
Main House = 1911 Sq Ft/178 Sq M
Double Garage = 397 Sq Ft/37 Sq M
Total = 2308 Sq Ft/215 Sq M



west

THE PROPERTY CONSULTANCY

216 Banbury Road

Summertown

Oxford

OX2 7BY

T: 01865 510000

F: 01865 558877

E: oxford@west-tpc.co.uk

west-tpc.co.uk

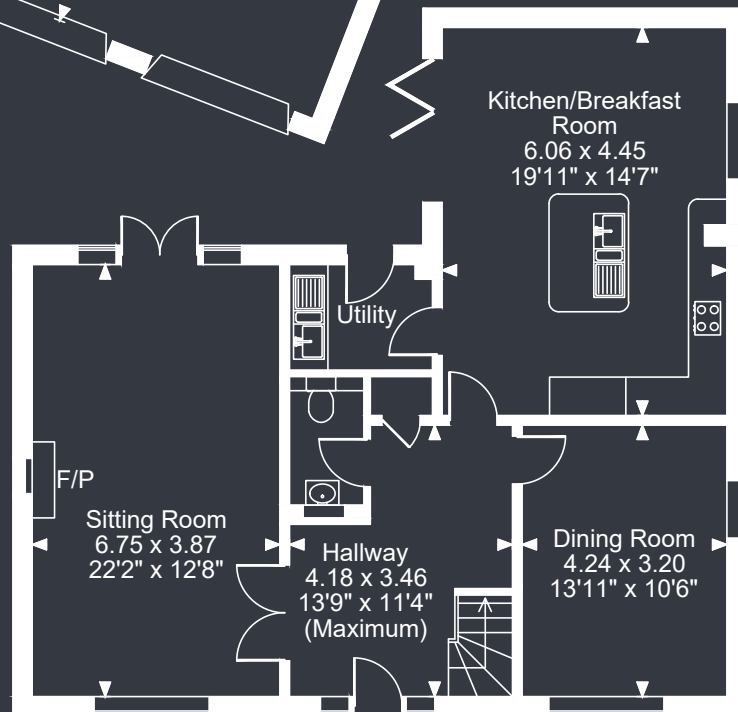
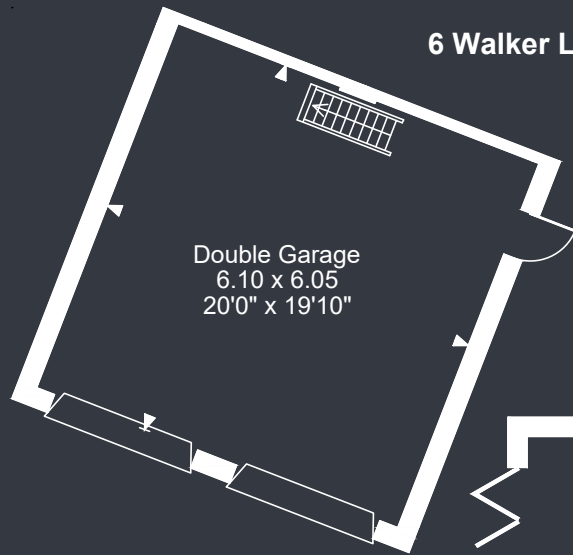

Ground Floor

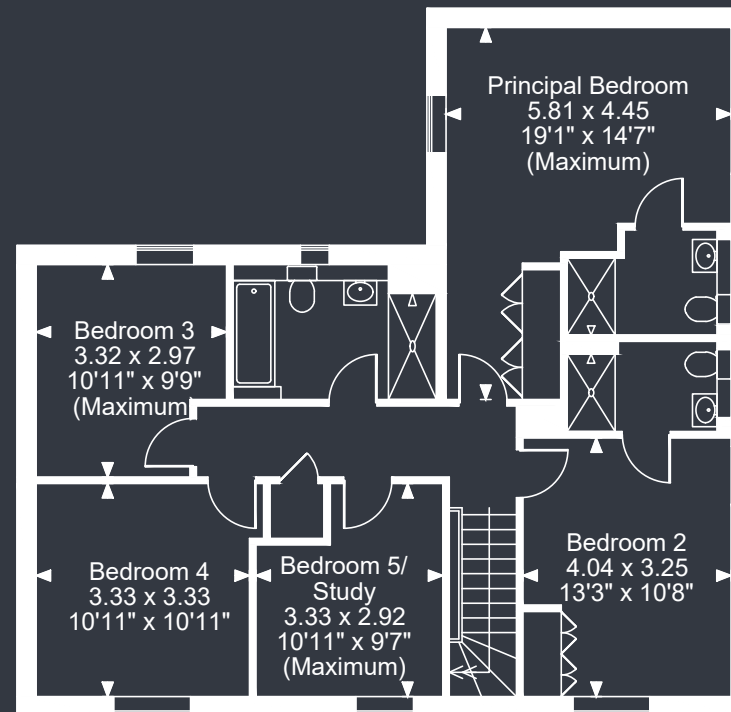

First Floor

FOR ILLUSTRATIVE PURPOSES ONLY - NOT TO SCALE

The position & size of doors, windows, appliances and other features are approximate only.

© ehous. Unauthorised reproduction prohibited. Drawing ref. dig/8567475/DGO